



Penney Brook Fold | Hazel Grove | SK7 4LU

EDWARD
mellor



Features

- 1 Bedroom Ground Floor Apartment
- Available To Over 55's
- Delightful Communal Gardens
- Residents Parking
- Attractively Fitted Kitchen & Bathroom

Nestled within delightful lawned gardens on a select development for the over 55's, this well presented ground floor apartment is perfect for those looking to downsize on one level. Penney

Brook Fold embraces a friendly community atmosphere among its residents whilst offering independent living and is ideal for those looking for low maintenance living. This is an apartment that is

simply ready to move into and features an attractively fitted kitchen with integrated appliances, superbly fitted 3 piece bathroom suite and nicely decorated throughout. Viewing highly recommended.



Penney Brook Fold is situated in the heart of Hazel Grove and is within close proximity of local shops and good public transport links. The apartment is positioned on the ground floor with views over the communal gardens to both the front and rear.. The accommodation on offer briefly comprises : Private entrance hall with 3 sets of useful storage cupboards, lovely size living room which provides ample room for both seating and dining, attractively fitted kitchen, double size bedroom and a lovely 3 piece bathroom suite. The development also offers residents parking and well tended communal lawned gardens which encourage the opportunity to engage with other residents within the development.



FLOOR LAYOUT

Not to Scale - For Identification Purposes Only

GROUND FLOOR
428 sq.ft. (39.7 sq.m.) approx.

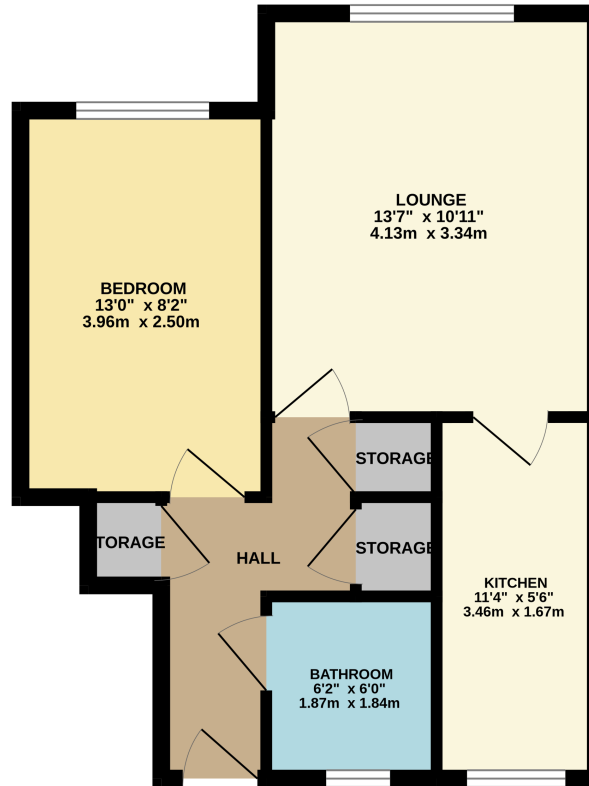

TOTAL FLOOR AREA: 428 sq.ft. (39.7 sq.m.) approx.

Whilst every attempt has been made to ensure the accuracy of the floorplan contained here, measurements of doors, windows, rooms and any other items are approximate and no responsibility is taken for any error, omission or mis-statement. This plan is for illustrative purposes only and should be used as such by any prospective purchaser. The services, systems and appliances shown have not been tested and no guarantee as to their operability or efficiency can be given.
Made with Metropix ©2025

Important Information

- Council Tax Band: A
- Tenure: Leasehold
- Years Remaining on the Lease : 59 Years
- Annual Ground Rent: £25

- Annual Service Charge: £1143

EPC Rating

182, London Road, SK7 4DQ
T: 0161 456 6000
E: hazelgrove@edwardmellor.co.uk

The agent has not tested apparatus, equipment, fittings or services and so cannot verify they are in working order or fit for their purpose. The buyer is advised to obtain verification from their Solicitor or Surveyor. Photographs are reproduced for general information and it must not be inferred that any item is included for sale with the property. Please note that all measurements are approximate. These particulars are issued on the understanding that any negotiations in regard to this property are carried out through Edward Mellor Ltd. This property is offered subject to not being sold or withdrawn on receipt of reply. These particulars are believed to be correct but do not form a contract for sale. None of the statements contained in these particulars as to this property are to be relied on as statements or representations of fact. The vendor does not make or give, and neither Edward Mellor Ltd. nor any person in their employment has any authority to make or give, any representation or warranty in relation to this property.