

Coldharbour Lane | London | SE5

Share of Freehold

£325,000

- One double bedroom
- First floor
- Open plan
- Share of freehold
- Chain free
- Excellent location
- Local amenities
- Denmark Hill Station
- Loughborough Junction
- Kings College Hospital



One bedroom, first floor Victorian apartment on a residential street with excellent transport links. Well maintained by the current owner this flat has an open plan kitchen and reception room, modern bathroom and a good sized double bedroom. Great location for popular Brixton Village, shops bars, restaurants and tube, Loughborough Junction, Denmark Hill, Ruskin Park, Kings College Hospital and Camberwell. Chain free, share of freehold



Score	Energy rating	Current	Potential
92+	A		
81-91	B		
69-80	C	76 C	79 C
55-68	D		
39-54	E		
21-38	F		
1-20	G		

FIRST FLOOR
646 sq.ft. (60.0 sq.m.) approx.

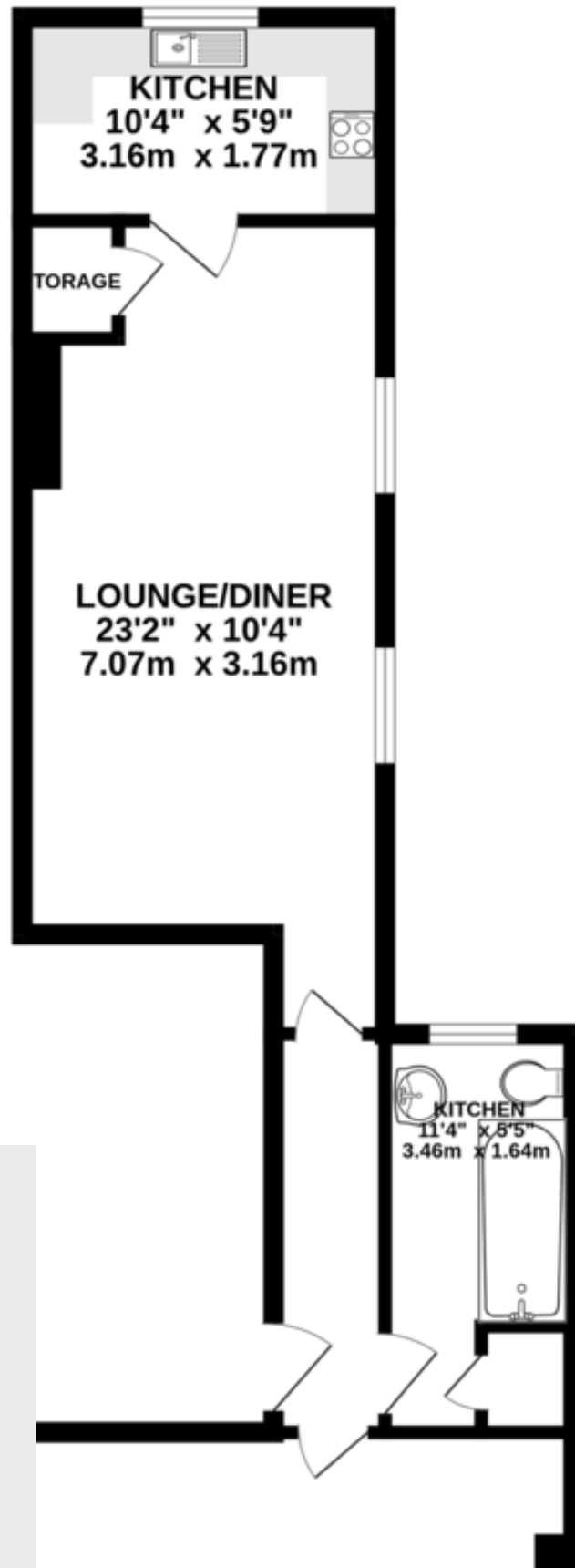

Viewing Arrangements

Strictly by appointment

Contact Details

121 Denmark Hill

London

SE5 8EN

www.urbanvillagehomes.co.uk

sales@urbanvillagehomes.com

020 3519 9121

Agents Note: Whilst every care has been taken to prepare these sales particulars, they are for guidance purposes only. All measurements are approximate and for general guidance purposes only and whilst every care has been taken to ensure their accuracy, they should not be relied upon and potential buyers are advised to recheck the measurements.