

Sumerling Way, Bluntisham, Huntingdon, PE28 3XT

Offers Over £425,000

4 2 3



- A beautifully presented four bedroom detached home in Bluntisham In lovely condition throughout with all four bedrooms recently decorated
- Comfortable sitting room with wall mounted gas fire
- A utility room keeps the practical side of life neatly out of the way
- The rear garden has been beautifully landscaped with patio and lawn
- Virtual tour available upon request
- A study on the ground floor perfect for working from home
- Four well proportioned bedrooms and a family bathroom & en-suite upstairs
- A garage and driveway provide plenty of parking to the front
- EPC Rating C/72

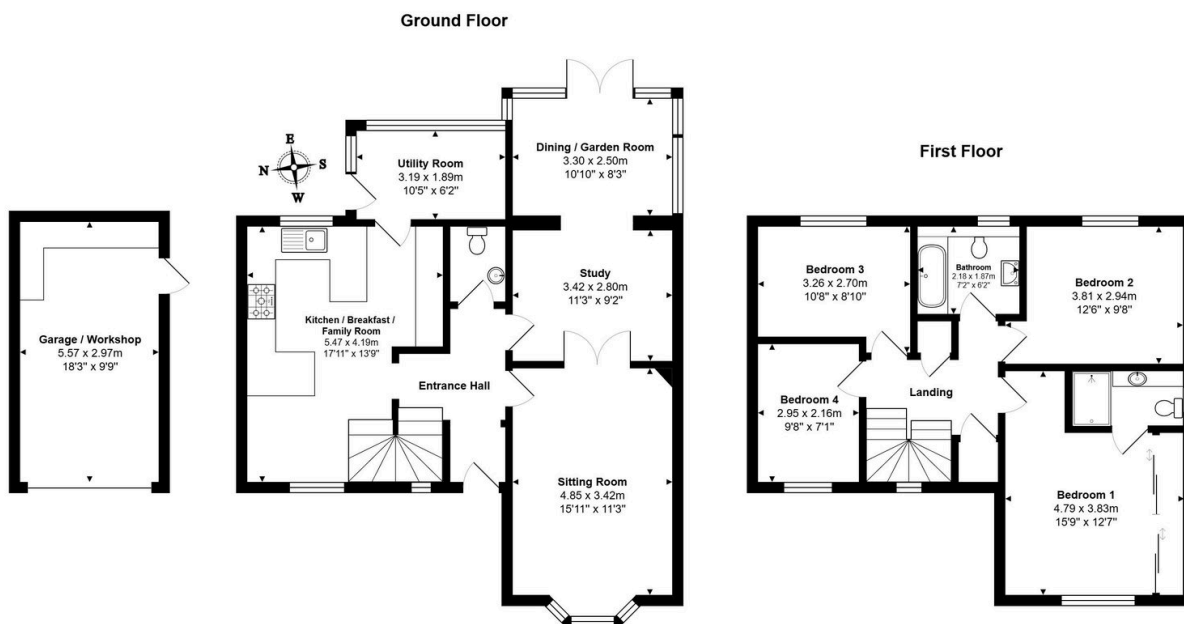

Total Area: 133.9 m² ... 1442 ft² (excluding garage / workshop)

All measurements are approximate and for display purposes only

A beautifully presented four bedroom detached home in Bluntisham – lovingly looked after, stunning garden and packed with space throughout!