



Connells

Voices Cottages Horsham Road
Handcross Haywards Heath



Property Description

Connells are proud to offer this three-bedroom terraced cottage to the market, situated in a semi-rural location and in the village of Handcross, this would make the ideal purchase for first time buyers and those looking to commute to either London or coastal towns via the M23/A23.

As you enter the property through the porch you enter a bright and airy living room. The living room benefits from a window to the front, the fitted kitchen comprises of a stainless-steel sink with draining area, an array of practical storage cupboards, plenty of worktop space and room for appliances. There is also enough room in the kitchen for a dining table and chairs.

The family bathroom is located downstairs and comprises a bath and overhead shower unit, low flush WC and wash basin with beneath storage.

On the first floor there are two spacious double bedrooms and a further bedroom located on the top floor which offers stunning views across rolling fields.

There is unrestricted on-street parking to the front of the property, and the rear garden is mainly lawn with flower and shrub borders.









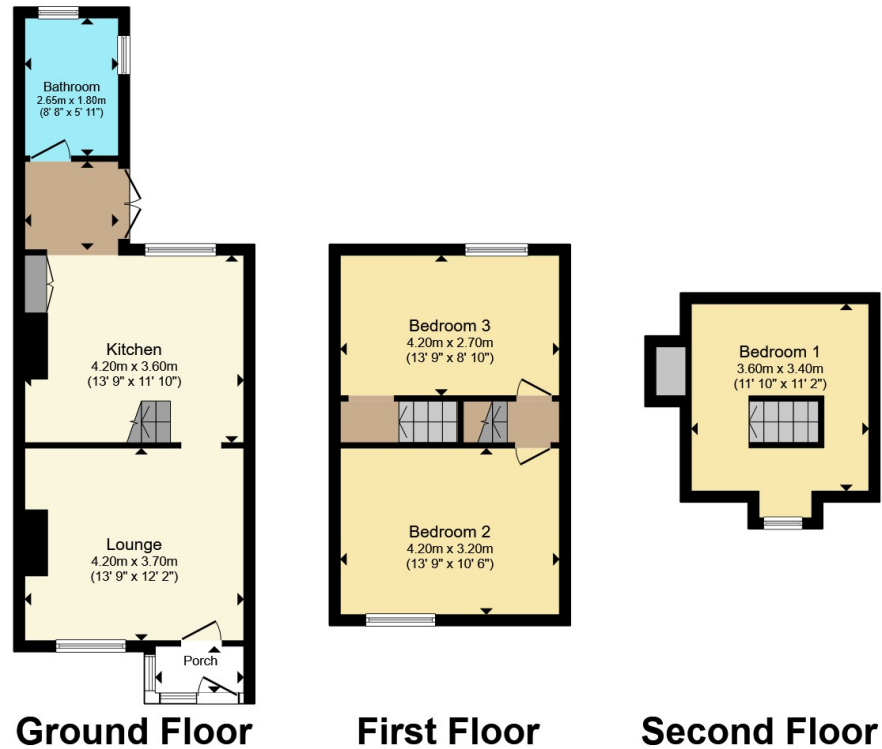

Total floor area 81.7 m² (879 sq.ft.) approx

This floor plan is for illustrative purposes only. It is not drawn to scale. Any measurements, floor areas (including any total floor area), openings and orientation are approximate. No details are guaranteed, they cannot be relied upon for any purpose and they do not form part of any agreement. No liability is taken for any error, omission or misstatement. A party must rely upon its own inspection(s). Powered by www.propertybox.io



To view this property please contact Connells on

T 01444 441 441
E haywardsheath@connells.co.uk

135 South Road
 HAYWARDS HEATH RH16 4LY

EPC Rating: D Council Tax
 Band: C

Tenure: Freehold

view this property online connells.co.uk/Property/HAY405735



1. MONEY LAUNDERING REGULATIONS Intending purchasers will be asked to produce identification documentation at a later stage and we would ask for your co-operation in order that there will be no delay in agreeing the sale. 2. These particulars do not constitute part or all of an offer or contract. 3. The measurements indicated are supplied for guidance only and as such must be considered incorrect. Potential buyers are advised to recheck measurements before committing to any expense. 4. We have not tested any apparatus, equipment, fixtures, fittings or services and it is in the buyers interest to check the working condition of any appliances.

Connells Residential is registered in England and Wales under company number 1489613, Registered Office is Cumbria House, 16-20 Hockliffe Street, Leighton Buzzard, Bedfordshire, LU7 1GN. VAT Registration Number is 500 2481 05.

See all our properties at www.connells.co.uk | www.rightmove.co.uk | www.zoopla.co.uk

Property Ref: HAY405735 - 0003