



## September Way

Stanmore

£1,750 Per month

Davidson Frost-Wellings are pleased to introduce to the market this first floor flat in Stanley Court. The property comprises two bedrooms, a bathroom, two balconies and living room.

September Way is a fantastic location with close proximity to the centre of Stanmore and its amenities and tube station, and is near to the lovely Temple Pond.

Deposit of £1,961.53  
Harrow Council Tax Band D  
Available immediately

### Viewing

Please contact our Davidson Frost-Wellings Office on 020 8954 8806 if you wish to arrange a viewing appointment for this property or require further information.

- Two bedrooms
- Bathroom
- Two balconys
- Unfurnished
- First Floor
- Available immediately



## Floor Plan

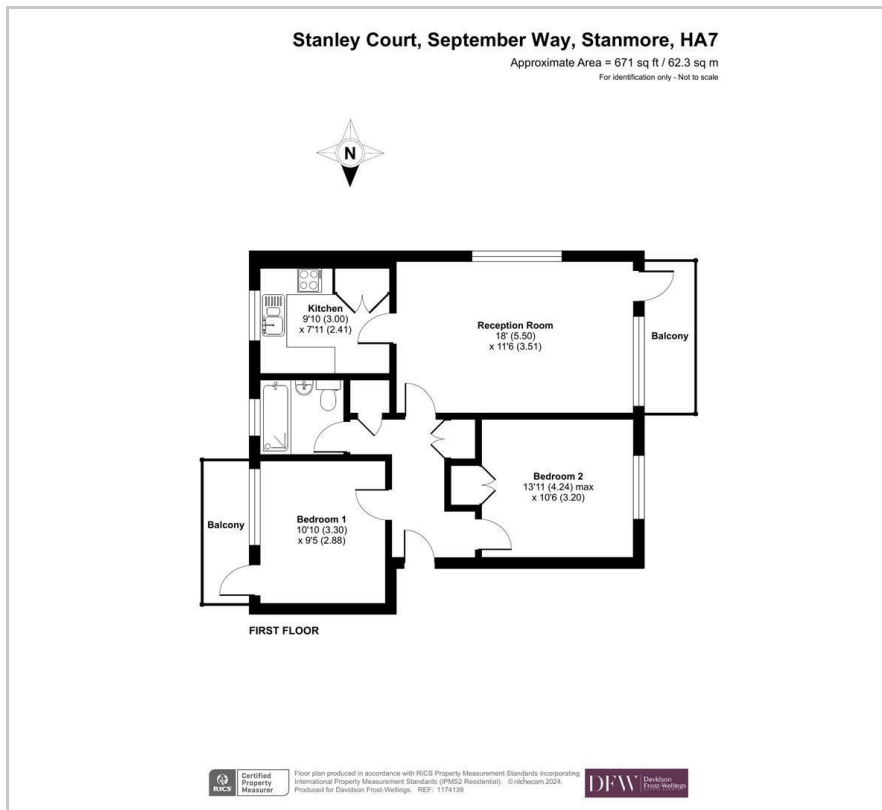

## Area Map

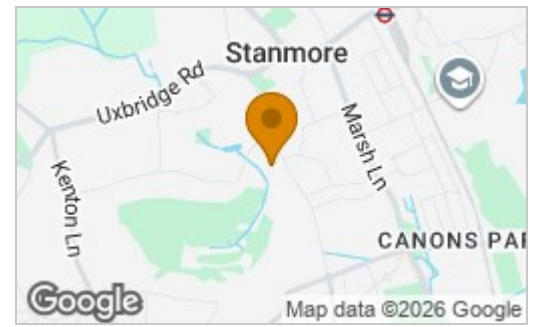

### Energy Efficiency Rating

	Current	Potential
<i>Very energy efficient - lower running costs</i>		
(92 plus) <b>A</b>		
(81-91) <b>B</b>		
(69-80) <b>C</b>		
(55-68) <b>D</b>		
(39-54) <b>E</b>		
(21-38) <b>F</b>		
(1-20) <b>G</b>		
<i>Not energy efficient - higher running costs</i>		
<b>England &amp; Wales</b>	EU Directive 2002/91/EC	



These particulars, whilst believed to be accurate are set out as a general outline only for guidance and do not constitute any part of an offer or contract. Intending purchasers should not rely on them as statements of representation of fact, but must satisfy themselves by inspection or otherwise as to their accuracy. No person in this firm's employment has the authority to make or give any representation or warranty in respect of the property.