



**HENDERSON  
CONNELLAN**

ESTATE AGENTS

## "Character, Charm & Village Living"

Occupying an beautiful position overlooking the village green within the highly regarded village of Clipston, this charming two-bedroom cottage offers a wonderful blend of character features, practical living space and delightful outside space including a detached garage and separate mature garden.



Kelmarsh Road  
Clipston  
LE16 9RX





Clipston remains one of Northamptonshire's most desirable villages, enjoying an attractive countryside setting and a strong sense of community. The village benefits from a village hall, a well-regarded primary school, a village pub and a church. Other day-to-day amenities are available in the neighbouring village of Naseby, whilst the nearby town of Market Harborough provides a comprehensive range of shopping, dining and leisure facilities together with a mainline railway station offering direct services to London St Pancras International in under an hour.

Entrance is granted via a glazed porch into a delightful kitchen which immediately sets the tone for the accommodation. Exposed beams combine beautifully with parquet-style flooring, whilst a feature multi-fuel stove creates a cosy focal point. The kitchen area is fitted with a range of eye and base level units complemented by timber-effect square edge work surfaces, tiled splashbacks and a charming Belfast sink with mixer tap positioned beneath a window to the front of the property. A useful large walk-in pantry provides excellent additional storage.

Flowing seamlessly from the kitchen is a well-balanced living room, flooded with natural light via windows to the front elevation and French doors opening onto the courtyard garden. A brick-built fireplace housing an electric burner creates a wonderful focal point

Stairs rise to the first-floor landing providing access to all first-floor rooms via cottage-style timber doors with exposed joinery further adding to the property's character.



The main bedroom enjoys views across the village green and benefits from a useful built-in wardrobe, whilst the second bedroom which is a comfortable single room with useful built-in storage.



The bathroom is fitted with a three-piece suite comprising of a panelled bath with shower over, a low-level WC and pedestal wash hand basin.



Externally, the property enjoys a pleasant courtyard-style frontage enclosed by low-level brick walling and perfectly positioned to enjoy the attractive outlook across the green. Separate from the cottage itself, a gravel track leads to a detached garage providing excellent storage and workshop potential. Beyond lies a delightful, enclosed garden, predominantly laid to lawn and framed by mature trees, established planting and hedging, creating a private and peaceful retreat.



Kitchen/Dining Room  
3.76m x 3.89m (12'4" x 12'9") max

Living Room  
3.12m x 3.53m (10'3" x 11'7") max

Main Bedroom  
3.23m x 3.3m (10'7" x 10'10") max

Bedroom Two  
2.82m x 1.98m (9'3" x 6'6") max

Bathroom  
1.96m x 1.37m (6'5" x 4'6") max

Garage  
3.1m x 5.28m (10'2" x 17'4")

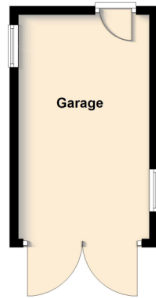

Ground Floor

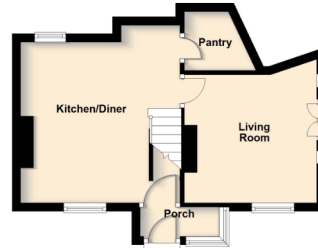

First Floor

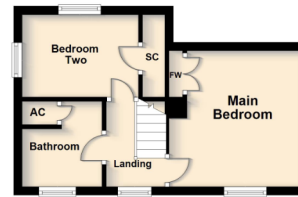

\*Although great care has been taken to create an accurate floorplan, it is for visual representation only and does not represent exact proportions.



Henderson Connellan, 63 High Street,  
Market Harborough, LE16 7AF

01858 410400  
marketharboroughsales@hendersonconnellan.  
co.uk



hendersonconnellanmh