



Flat 4, 123 Lynchford Road

Farnborough, GU14 6ET

£1,400 PCM

A beautifully presented penthouse-style apartment offering stylish, spacious and modern living throughout. This impressive split-level property benefits from its own private entrance and features a generous open-plan living and kitchen area. The apartment offers two well-proportioned double bedrooms, both with built-in wardrobes, along with a contemporary shower room finished to a high standard. Externally, the property benefits from allocated parking for one vehicle.

Ideally located within the popular North Camp village, the property is within easy reach of North Camp Station (0.7 miles), Ash Vale Station (1.2 miles) and Farnborough Station (1.8 miles), making it ideal for commuters. Local shops and amenities are within walking distance, and there is excellent access to the A331 and M3.

North Camp offers a wide range of local amenities, shopping facilities and leisure centres, making it a vibrant and well-connected place to live.

Available beginning of June.

Viewing

Please contact our Fosters Lettings Office on 01252 344333 if you wish to arrange a viewing appointment for this property or require further information.

- Available Beginning Of June
- 2 Double Bedrooms
- Built-In Storage Space
- Modern Kitchen
- Allocated Parking For One Car
- White Goods Included
- Superb Top Floor Penthouse
- Deposit £1615.38
- Council Tax Band A
- EPC Energy Rating Band (C) 79



Floor Plan

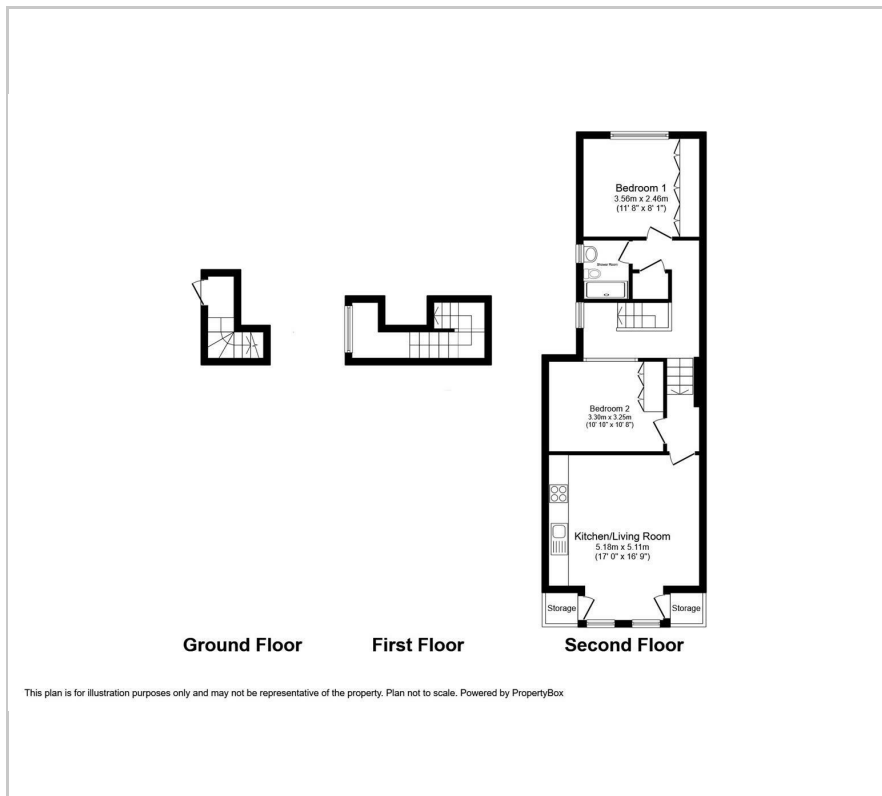

Area Map



Energy Efficiency Graph

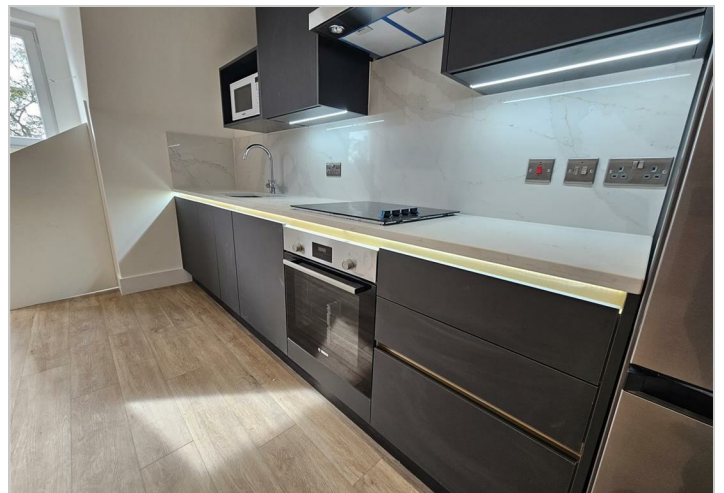
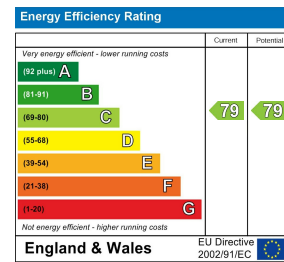

These particulars, whilst believed to be accurate are set out as a general outline only for guidance and do not constitute any part of an offer or contract. Intending purchasers should not rely on them as statements of representation of fact, but must satisfy themselves by inspection or otherwise as to their accuracy. No person in this firm's employment has the authority to make or give any representation or warranty in respect of the property.