



BRUTON

— PROPERTY —



55 Victoria Street
London, SW1H 0AF

£3,600 Per month

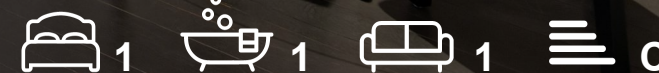

55 Victoria Street

London, SW1H 0AF

Luxury apartment with a small balcony set in the popular 55 Victoria Street development complete with a residents gym, sky garden and 24HR concierge.

55 Victoria Street offers 2.9m ceiling heights with floor to ceiling windows.

Spacious open plan kitchen/living area with a separate bedroom & bathroom with underfloor heating, hard wood floors and Miele appliances. Separate dryer and washing machine.

55 Victoria Street is located near Buckingham Palace, St James's and Green Park. The flat is within reach of restaurants, cafes, shops, St James's and Mayfair.

Local parklands include Green Park and St James's Park .

Transport Links include: Circle & District Lines (St James's Park): approx 0.1 miles. Victoria and mainline rail services (Victoria): approx 0.4 miles, Jubilee Line (Westminster): approx 0.5 miles.

Council: Westminster (Band E)
Video Tour Available





Floor Plan

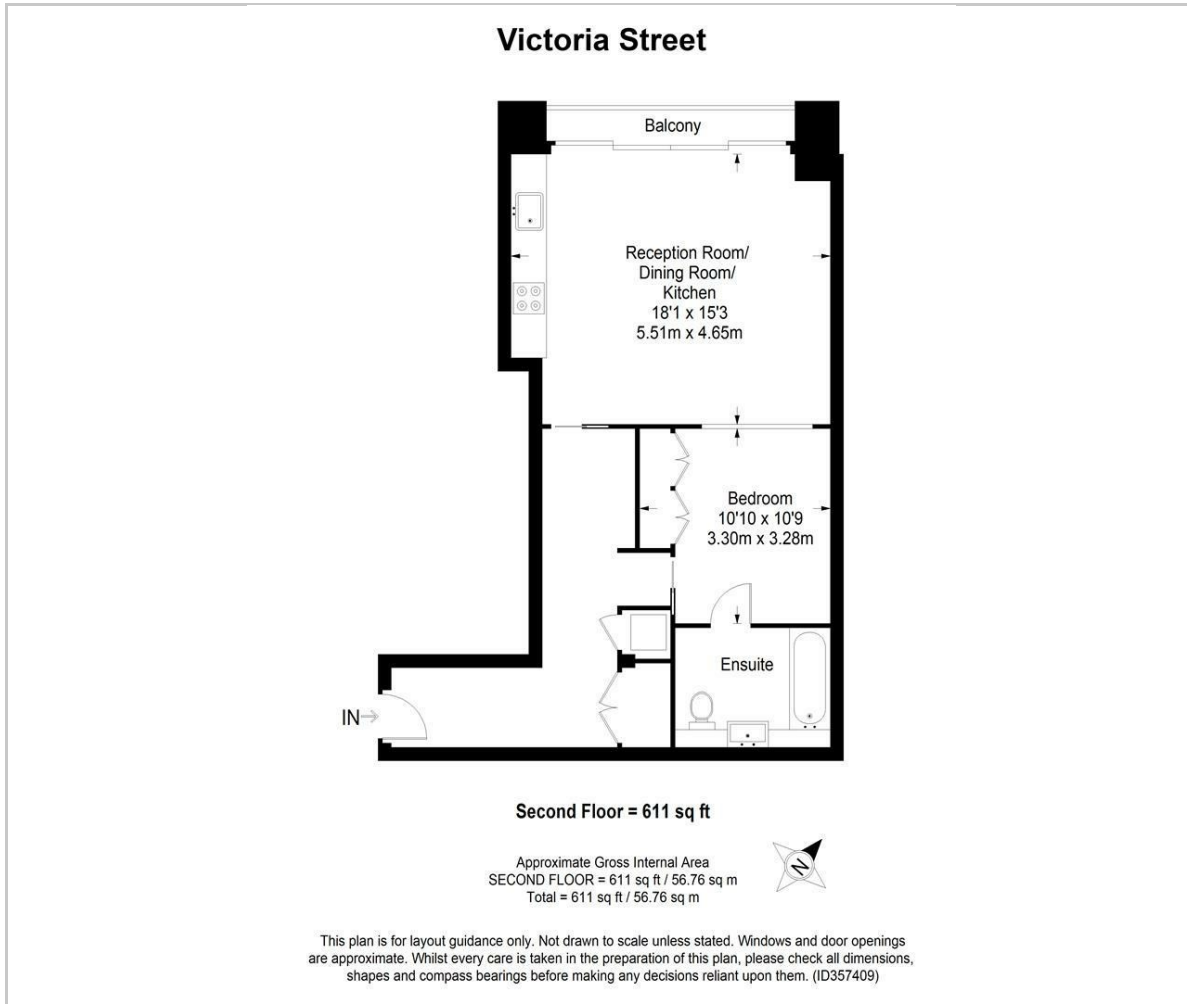

Viewing

Please contact our Bruton Property Office on 0207 459 4696 if you wish to arrange a viewing appointment for this property or require further information.

These particulars, whilst believed to be accurate are set out as a general outline only for guidance and do not constitute any part of an offer or contract. Intending purchasers should not rely on them as statements of representation of fact, but must satisfy themselves by inspection or otherwise as to their accuracy. No person in this firm's employment has the authority to make or give any representation or warranty in respect of the property.

 **20 Lees Place, Mayfair**
London, W1K 6LP

 **020 7459 4696**

 **info@brutonproperty.co.uk**
www.brutonproperty.co.uk

Area Map



Energy Efficiency Graph

