



Falcon

01752 600444

10 St. Boniface Drive

Beacon Park, Plymouth, PL2 3QW

Guide Price £210,000 - £220,000





In Brief

Modern Stylish terraced property with fantastic level rear gardens.

Reception Rooms Living - Dining room

Bedrooms 2 double bedrooms

Heating Gas central heating

Area 518 Sq Ft

Tenure Freehold

Parking on street parking

Council Tax B

Description

Falcon are delighted to present to the market this beautifully maintained two-bedroom mid-terrace home, situated within the highly sought-after development of St. Boniface Drive in Beacon Park. The property offers well-balanced accommodation throughout, beginning with a spacious open-plan living and dining area—perfect for both relaxing and entertaining—leading through to a modern, well-appointed fitted kitchen. To the first floor, there are two generous and well-proportioned bedrooms, along with a contemporary family bathroom. The home further benefits from ample built-in storage, making it both practical and comfortable for everyday living. There is also a newly fitted boiler 4 months old, giving peace of mind. Externally, the property boasts a substantial south-facing rear garden, ideal for enjoying sunshine throughout the day, with the added advantage of rear access. Ideally located, the property is within close proximity to excellent transport links including the A38, as well as local supermarkets, Central Park, and the Life Centre. Presented in modern condition throughout, this home would make an ideal first-time purchase or investment opportunity.

Need A Mortgage?

**Don't pay more than you need to for your mortgage advice:
ours is only £195 paid when you move!**

Floor Plans

GROUND FLOOR
262 sq.ft. (24.4 sq.m.) approx.

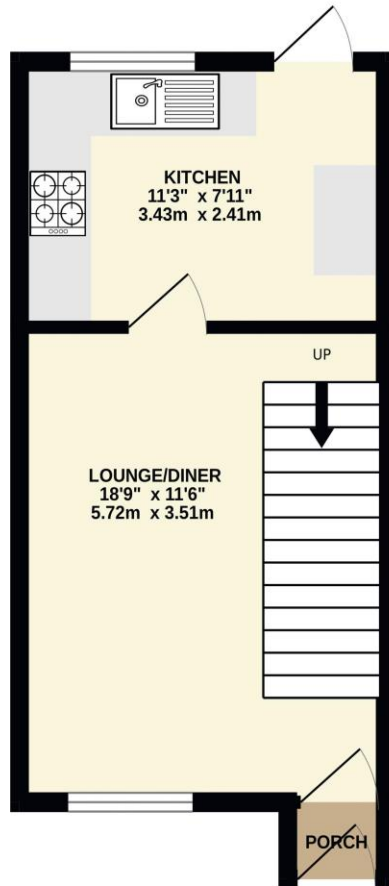

1ST FLOOR
255 sq.ft. (23.7 sq.m.) approx.

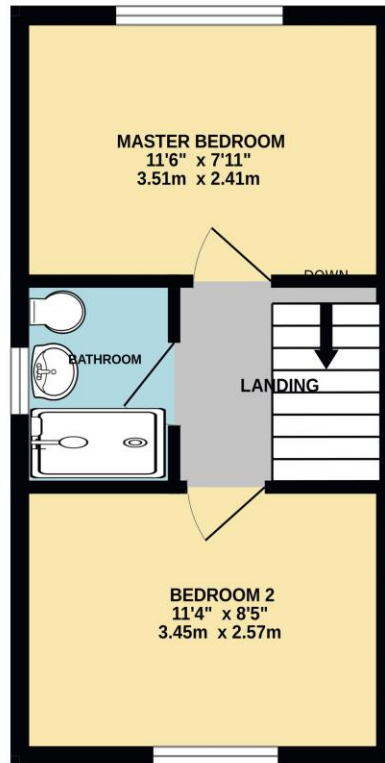

TOTAL FLOOR AREA : 518 sq.ft. (48.1 sq.m.) approx.
Made with Metropix ©2026



Fixed Price Conveyancing

A complete solution from just £600 with No sale – No Fee



We have not tested any apparatus, equipment, fixtures and fittings or services and so cannot verify that they are connected, in working order or fit for the purpose. Neither have we had sight of the legal documents to verify the Freehold or Leasehold status of any property; or sight of any consents, including Planning Permissions, building Regulations and Breaches of Covenants that may be required for alterations to the property. A buyer is advised to obtain verification from their Solicitor and/or Surveyor. Items shown in photographs are NOT included unless specifically mentioned within the Sales Particulars. Any floor plans on these details are not drawn to scale and are intended for guidance only

Falcon Property is an Introducer to Bradleys Financial Management Ltd. They are appointed representatives of Sesame Ltd who are authorised and regulated by the Financial Services Authority. Bradleys do not charge for mortgage advice, however a fee paying option is available. Typical fee is £195. Bradleys Financial Management: 16 Mannamead Road, Mutley, Plymouth, PL4 7AA

Your home may be repossessed if you do not keep up repayments on your mortgage.

