



Burrells Wharf Square, E14

£375,000

Offered to the market chain free is this two double bedroom home located within the sought-after Burrells Wharf development. Features include allocated parking, a spacious reception room, a refitted bathroom, residents' leisure facilities, concierge service, and a lease in excess of 900 years.

The development is fantastically located close to the local amenities and transport links of the Docklands and Isle of Dogs, as well as offering easy access to the Thames Path, riverboat services along the River Thames, and City of London.

Features

- 770 Square Feet
- 900 Plus Year Lease
- Allocated Parking
- Residents Leisure Facilities
- Concierge Service
- No Onward Chain

Burrells Wharf Square, London, E14

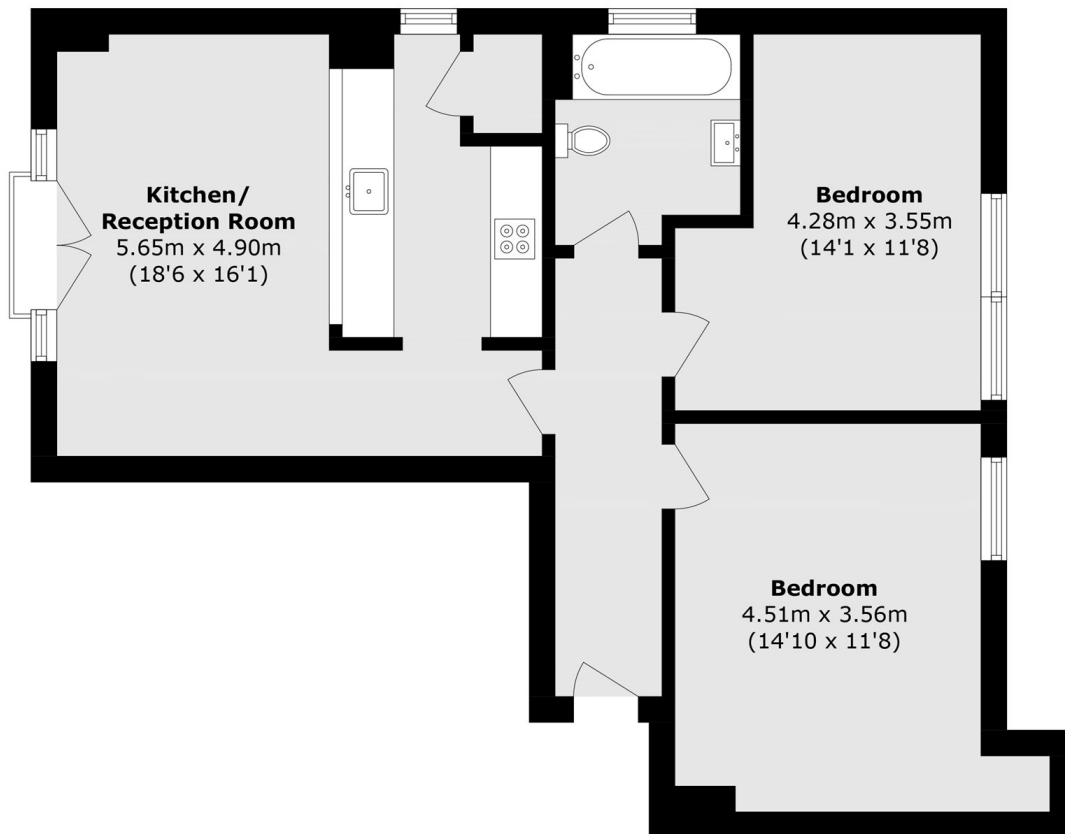

Total area (approx.): 71.6 sq. m (770.7 sq. ft)