

Dairyfields, Crawley, RH11 8EW

Asking Price £325,000

Council Tax Band: C



**LOCATION**

We are delighted to bring to the market this spacious, three bedroom property in a quiet cul-de sac, in the popular neighbourhood of Gossops Green. Located in a highly convenient location, less than a 10 minute walk to Ifield Station, a primary school, pre-school and a parade of shops with takeaway outlets, a post office, pharmacy and convenience store. It is also just under two miles to the centre of Crawley with its wealth of cafes and shops.



**Open House Horsham**

**Ground Floor**

Approx. 41.0 sq. metres (441.7 sq. feet)

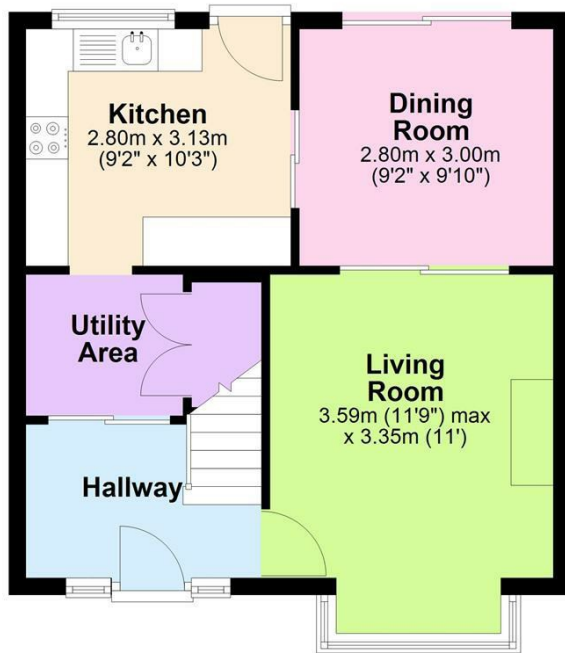

**First Floor**

Approx. 40.4 sq. metres (434.3 sq. feet)

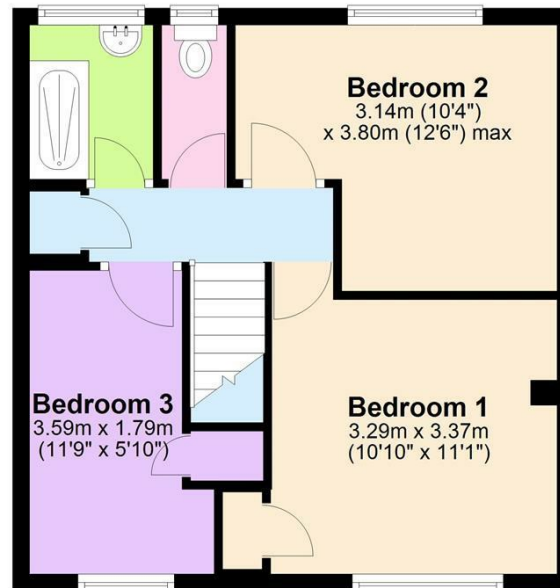

Total area: approx. 81.4 sq. metres (876.0 sq. feet)

**Dairyfields**

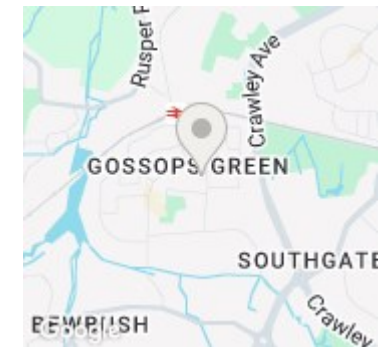

Energy Efficiency Rating		
	Current	Potential
Very energy efficient - lower running costs		
(92 plus) <b>A</b>		
(81-91) <b>B</b>		
(69-80) <b>C</b>		79
(55-68) <b>D</b>	62	
(39-54) <b>E</b>		
(21-38) <b>F</b>		
(1-20) <b>G</b>		
Not energy efficient - higher running costs		
<b>England &amp; Wales</b>	EU Directive 2002/91/EC	