



## Hawkshead Road

, Sheffield, S4 8BB

- Modern fitted dining kitchen with space for entertaining
- Contemporary fitted family bathroom
  - Welcoming entrance hallway
- Enclosed rear garden with outdoor space
- Attractive bay-fronted end-terrace home
- Two spacious double bedrooms
- Comfortable and well-proportioned lounge
- Double glazing for energy efficiency



Local Authority  
Council Tax Band **A**  
EPC Rating **D**

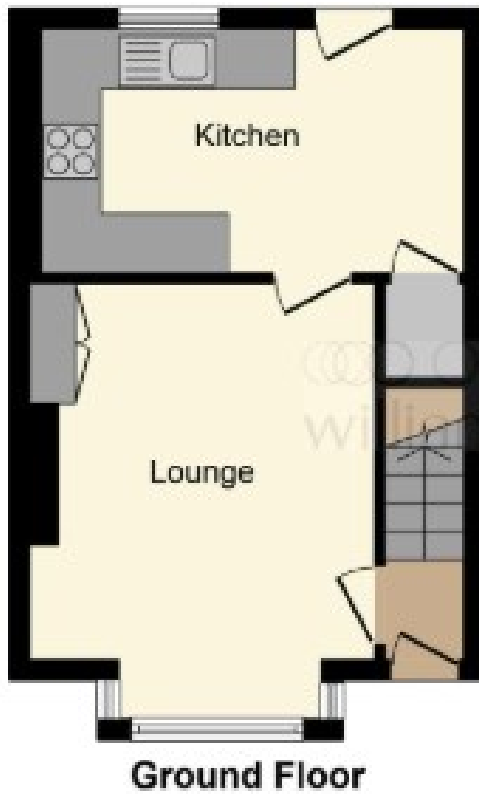

**Smartsale4u Office**  
Suite 331 Kemp House, 152-160 City  
Road, London, EC1V 2NX

**Contact**  
0204 572 9091  
info@smartsale4u.co.uk  
smartsale4u.co.uk

Agents Note: Whilst every care has been taken to prepare these particulars, they are for guidance purposes only. All measurements are approximate and for general guidance purposes only and whilst every care has been taken to ensure accuracy, they should not be relied upon and potential buyers/tenants are advised to recheck the measurements.