



Warwick Road, SW5

£1,775 Per calendar month

A spacious and well presented studio flat located in a well maintained period conversion. The flat has been recently refurbished throughout with wooden floors.

The property is ideally located on Warwick Road just 0.1 miles from Earls Court Station with fantastic transport links and local amenities on Earls Court Road

Features

- Studio
- One Bathroom
- New Refurbished
- Wooden Floors
- Third Floor
- Period Conversion

Warwick Road,
London, SW5

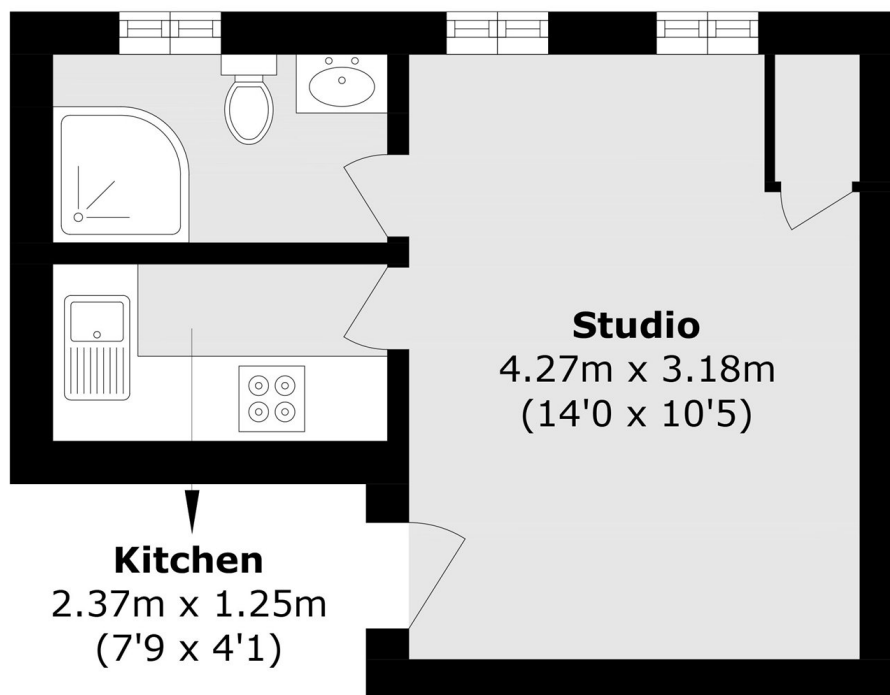

Third Floor

Total area (approx): 20.4 sq. m (219.5 sq. ft)