



Dorset House

Gloucester Place, NW1

£5,500 per month
(£1,269.23 per week)

****SHORT LET**** A newly renovated two bedroom apartment in a sought after purpose built block, just moments from Baker Street Station and the amenities of Marylebone Village.

CHESTERTONS



Dorset House

Gloucester Place, NW1

- Sixth Floor Flat
- 2 Bedrooms, 1 Bathroom
- Porter, Lift
- Close to Baker Street Station



****SHORT LET**** A newly renovated two bedroom apartment in a sought after purpose built block, just moments from Baker Street Station and the amenities of Marylebone Village.

The property comprises two double bedrooms, double reception room, bathroom and fitted kitchen.

Additional benefits include concierge and lift.

Minimum Term: 1 months
Deposit Required: £5,076.92
Local Authority: City of Westminster
Council Tax Band: F
EPC Rating: C
Furnished

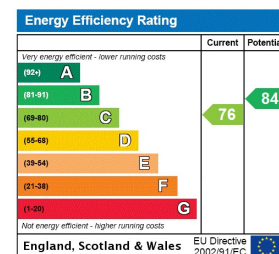

Chestertons St John's Wood Lettings

105 St. John's Wood Terrace
 London
 NW8 6PL
 stjohswood@chestertons.co.uk
 02030408622
 chestertons.co.uk

Additional tenant charges apply (fees apply to non-AST tenancies only)
 Tenancy Agreement Fee: £300
 References per Tenant/Guarantor: £60
 Inventory check (approx. £100 – £250 inc. VAT)
chestertons.co.uk/property-to-rent/applicable-fees

Gloucester Place, NW1 5AQ

Approx Gross Internal Area = 90 sq m / 969 sq ft

Balcony = 3 sq m / 32 sq ft

Total = 93 sq m / 1001 sq ft

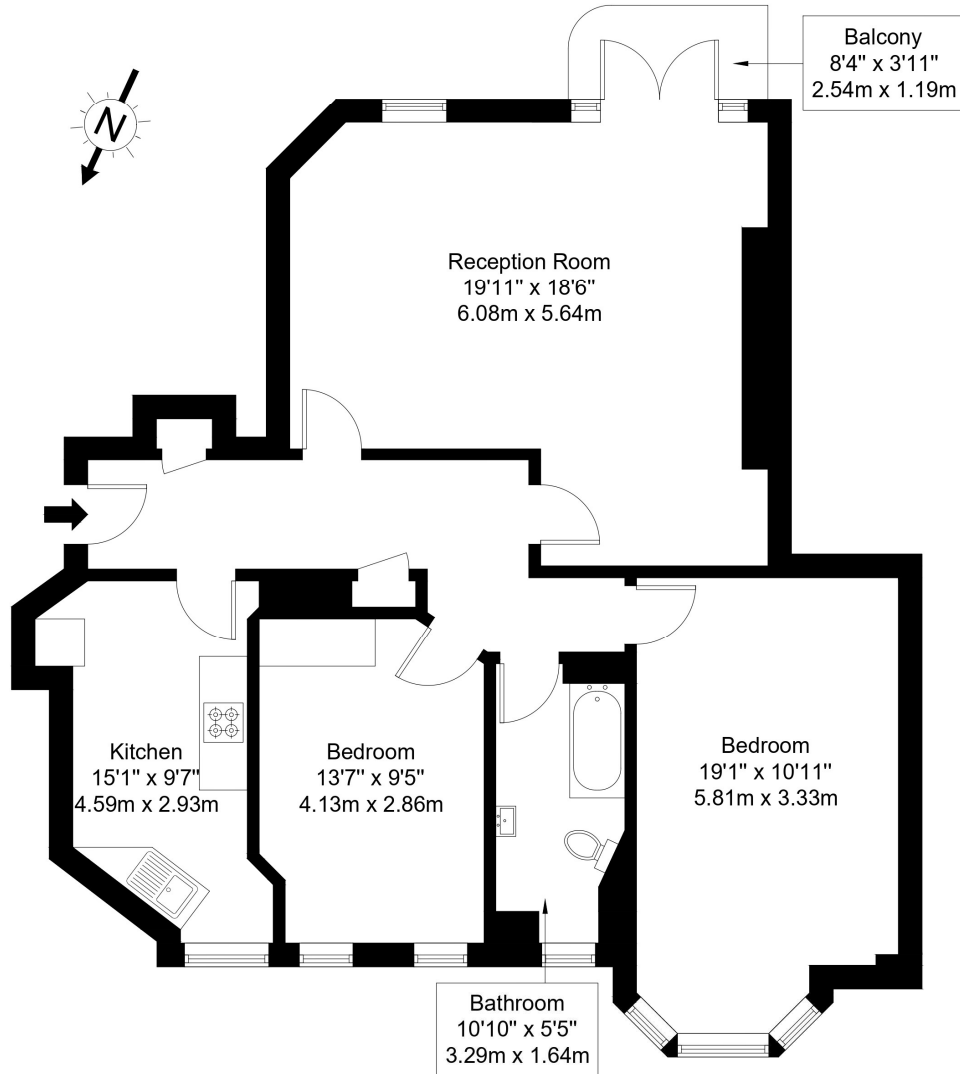

Sixth Floor

Ref :

Copyright

**B L E U
P L A N**

The Floor plan is not to scale and measurements and areas shown are approximate and therefore should be used for illustrative purposes only. The plan has been prepared in accordance with the RICS code of Measuring Practice and whilst we have confidence in the information produced it must not be relied on. Maximum lengths and widths are represented on the floor plan. If there is any aspect of particular importance, you should carry out or commission your own inspection of the property.

Copyright @ BleuPlan

