

ALLDAY  
& MILLER



Sylvana Close, Uxbridge, UB10 0BH  
£750,000

4 2 2 D





Sylvana Close, Uxbridge, UB10 0BH

**£750,000**

- Four Bedrooms
- Stunning Condition Throughout
- Extended
- State of The Art Kitchen/Dining Room
- Walking Distance To Uxbridge & Hillingdon Stations
- Detached
- Two Bathrooms
- Good School Catchments
- Backing Directly onto Court Park
- Planning Permisson for Front Porch & New Roof with Warranty



## Description

This stunning family home brought to the market in immaculate condition throughout comprises of a welcoming entrance, downstairs bedroom, utility room ideal for extra storage space, shower room & WC, light filled reception room, sleek fitted kitchen with an island breakfast bar and sliding doors with beautiful views of the garden.

Rising to the first floor boasts three bedrooms and a family bathroom suite.

The front benefits from a driveway space for off street parking for multiple vehicles. To the rear a private garden mainly laid to lawn with a patio area perfect for outside dining.

## Situation

Sylvana Close is a sought after Cul-De-Sac in North Hillingdon. There are well regarded schools in close proximity and recreational facilities also nearby such as the very scenic Court Park, Hillingdon Golf and Cricket Club and the newly opened fitness and leisure centre in Uxbridge. Uxbridge Town Centre with its array of shopping facilities, restaurants and bars and the Piccadilly/Metropolitan Line Station is a short distance away along with the A40/M40/M4 and M25 giving access to London and the Home Counties.



Floor Plans

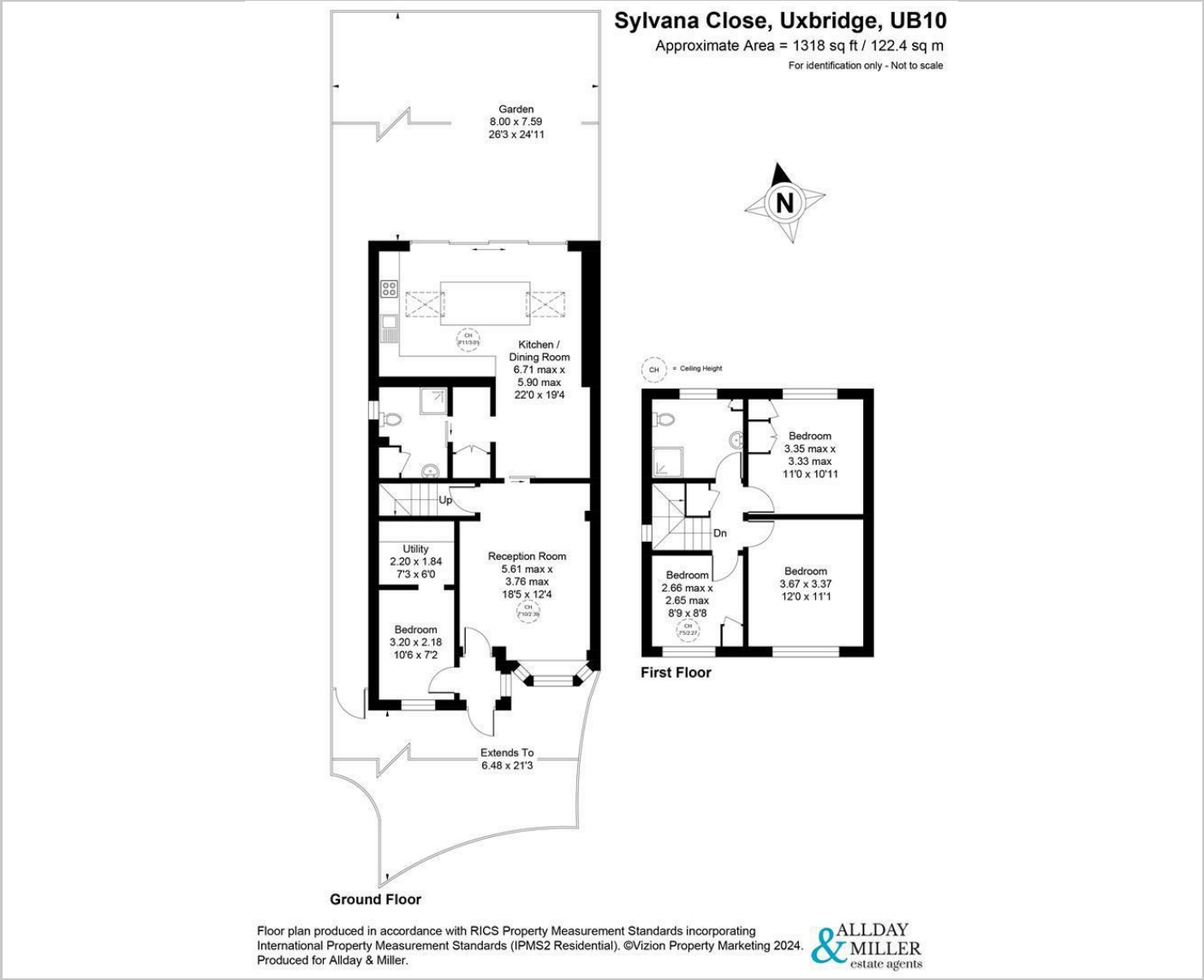

Area Map

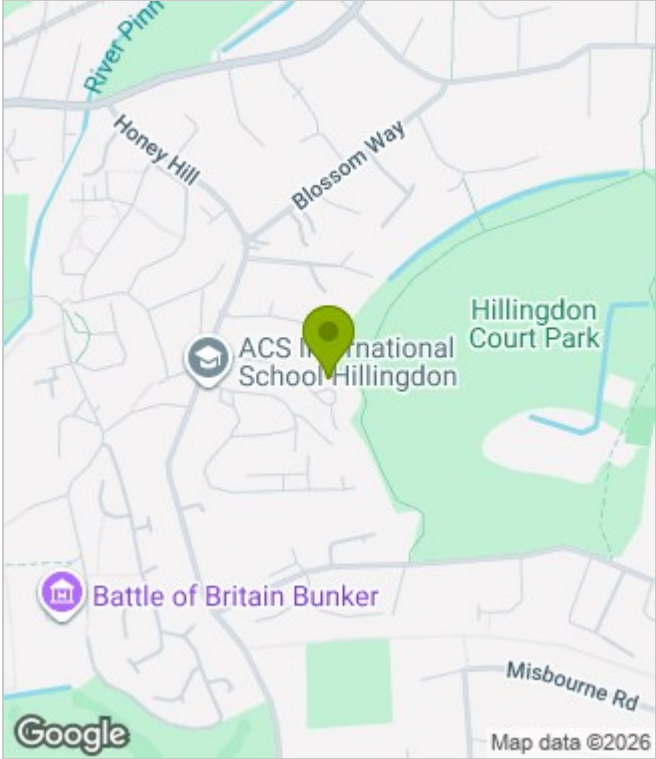

Energy Performance Graph

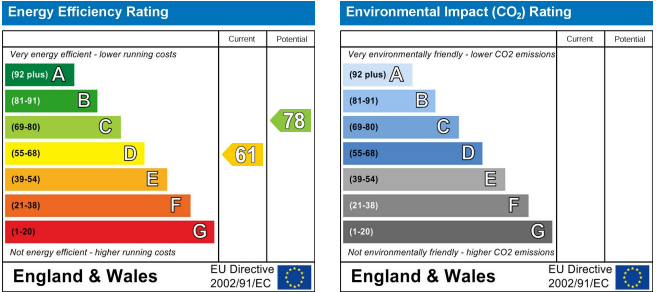

These particulars, whilst believed to be accurate are set out as a general outline only for guidance and do not constitute any part of an offer or contract. Intending purchasers should not rely on them as statements of representation of fact, but must satisfy themselves by inspection or otherwise as to their accuracy. No person in this firms employment has the authority to make or give any representation or warranty in respect of the property.

[www.alldayandmiller.co.uk](http://www.alldayandmiller.co.uk)

192 High Street, Uxbridge, Middlesex, UB8 1LB

T: 01895 641 000 | E: [sales@alldayandmiller.co.uk](mailto:sales@alldayandmiller.co.uk)

T: 01895 379 549 | E: [lettings@alldayandmiller.co.uk](mailto:lettings@alldayandmiller.co.uk)