

Factory Street, Tyldesley, M29 8GQ
£229,950

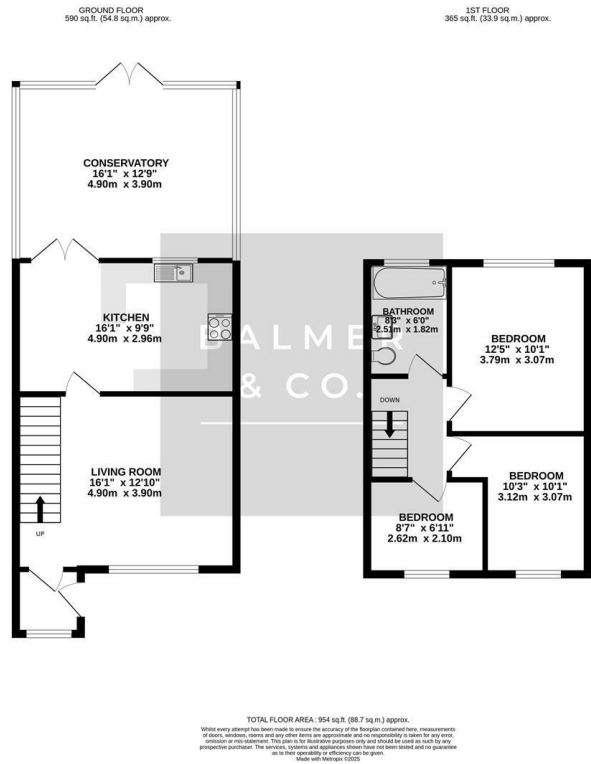

BALMER & CO in TYLDESLEY are delighted to offer FOR SALE this fantastic three bedroom end-terrace house close to Tyldesley town centre. Very well maintained by its current owners, this extended family home comprises in brief of entrance porch, large living room with feature fireplace and surround, modern fitted kitchen/dining room with integrated appliances, with a large conservatory to the rear completing the ground floor. To the first floor is a large master bedroom, second double bedroom, third single bedroom, with a three piece family bathroom completing the accommodation on offer. Externally there is a double driveway to the front providing ample off-road parking, whilst to the rear there is a private, low maintenance garden with a large shed fitted with electrics. The property is ideally located between Tyldesley and Atherton town centres, Fred Longworth High School and is within walking distance of the Leigh-Manchester guided busway. Early viewings highly recommended, all enquiries welcome.

Floor Plan



Area Map

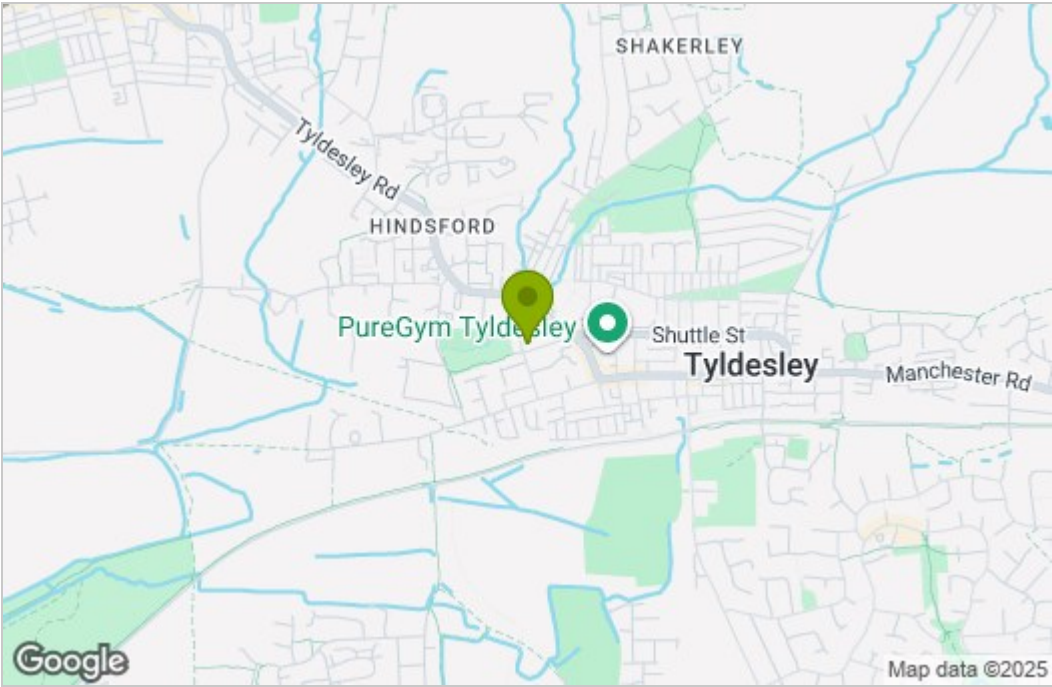

Energy Efficiency Graph

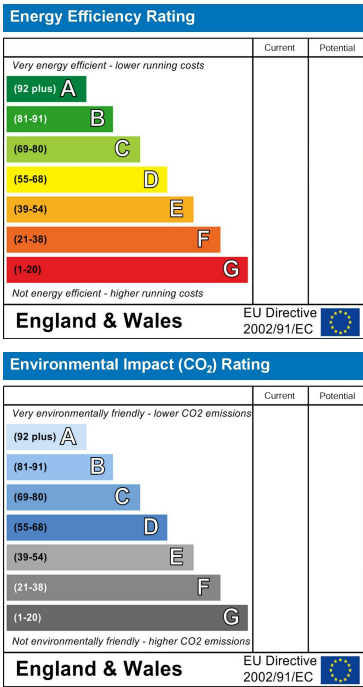

These particulars, whilst believed to be accurate are set out as a general outline only for guidance and do not constitute any part of an offer or contract. Intending purchasers should not rely on them as statements of representation of fact, but must satisfy themselves by inspection or otherwise as to their accuracy. No person in this firm's employment has the authority to make or give any representation or warranty in respect of the property.