

**GRICE &
HUNTER**

Chartered Surveyors
Estate Agents & Valuers
Est 1924



26 High Street, Crowle, DN17 4LD

- A double fronted Semi Detached Cottage in Conservation Area setting
- Rear vehicular access from Fieldside
- 2 Bedrooms plus Box Room
- First floor Bathroom
- 2 Reception Rooms
- Gas Central Heating
- Ready for timely updating
- Handy for local amenities



£145,000 NO CHAIN



Accommodation (room sizes approx. only)

CENTRAL ENTRANCE HALL with staircase off.

SITTING ROOM (4.2m x 3.55m) with front facing sash window, radiator and fireplace with electric fire.

DINING ROOM (5.67m x 2.67m) with front facing sash window, open tiled fireplace, radiator and understairs storage cupboard.

KITCHEN (2.46m x 2.15m) including base and wall storage cabinets, work tops, single drainer sink and radiator.

REAR PORCH (3.9m max x 2.4m)

First Floor

LANDING

BEDROOM 1 (3.62m x 4.22m) with radiator and sash window.

BEDROOM 2 (4.11m x 2.65m) having fitted wardrobe with matching free standing bedside cabinet and drawer unit. Radiator, built-in wardrobe and sash window.

BOX ROOM (3.57m x 1.46m having restricted ceiling height) with central heating radiator.

BATHROOM (2.77m x 2.20m) including bath with shower over, cabinet wash basin and toilet. Radiator, double glazed window and airing cupboard with radiator.

OUTSIDE

There is a good sized garden at the rear of the cottage which has a gated parking area being accessed by a right of way from Fieldside (next to the former Liberal Club).

There is also a pedestrian right of way through the adjoining property leading to the High Street.

SERVICES (not tested)

- Mains water, electricity, drainage and gas.
- Gas central heating to radiators.

LOCAL AUTHORITY

North Lincolnshire Council

COUNCIL TAX Band 'B' (on-line enquiry)

TENURE Freehold.

VIEWING

Strictly by prior appointment through Grice & Hunter 01427 873684

| Score | Energy rating | Current | Potential |
|-------|---------------|---------|-----------|
| 92+ | A | | |
| 81-91 | B | | |
| 69-80 | C | | 77 C |
| 55-68 | D | 56 D | |
| 39-54 | E | | |
| 21-38 | F | | |
| 1-20 | G | | |



Ground Floor

Approx. 50.3 sq. metres (541.3 sq. feet)

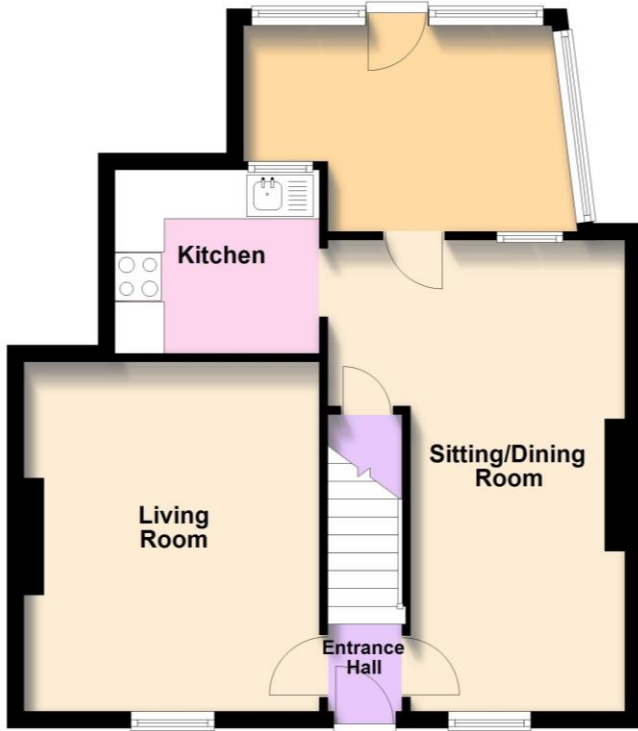

First Floor

Approx. 42.2 sq. metres (454.3 sq. feet)



Total area: approx. 92.5 sq. metres (995.6 sq. feet)

23 High Street, Epworth,
Near Doncaster DN9 1EP
Tel: (01427) 873684
epworth@gricehunter.co.uk

7 Priory Place,
Doncaster DN1 1BL
Tel: (01302) 360141
doncaster@gricehunter.co.uk

Consumer Protection Regulations

1. The mention of any appliances and/or services within these Sales Particulars does not imply they are in full and efficient working order
2. All measurements, areas and distances are approximate only. Plans are for illustration purposes only and not to be used for Land Registry purposes.
3. Extracts from the Ordnance Survey are for identification purposes only and the surroundings may have changed. The plan may not be an accurate reflection of the actual boundaries and must not be used to depict legal boundaries.
4. Details regarding the Council Tax and Planning Permissions have been obtained by online or oral enquiry and we advise any interested parties to satisfy themselves with the relevant Local Authority.

Misrepresentation

Grice & Hunter give notice that these particulars are believed to be correct but their accuracy cannot be guaranteed and they do not constitute part of an offer or contract. Intending purchasers or tenants should not rely on them as statements or representations of fact, but must satisfy themselves by inspection or otherwise as to their accuracy. No person in employment of Grice & Hunter has authority to make or give any representation or warranty in relation to the property.