

**80, Trinity Street, Belle Vue, Shrewsbury, SY3 7PD**  
£850 Per Month



80, Trinity Street, Belle Vue, Shrewsbury, SY3 7PD

**£850 Per Month**

VIRTUAL TOUR AVAILABLE - Attractive and extended two bedroom terraced property of character, extensively improved to a high standard throughout. The property occupies a lovely position in the heart of Belle Vue and is conveniently located a short walk from Coleham's excellent amenities and Shrewsbury town centre.

Available: 12/03/2026

## Description

Comprising: Living room, dining room, kitchen/breakfast room including oven, hob & fridge/freezer, door to rear, cellar. Upstairs to two bedrooms, bathroom including shower, attractive garden to rear including shed, partial double glazing, gas fired central heating, EPC D



Unfurnished  
Council Tax Band: B  
Available: 12th March 2026  
EPC: D



Floor Plans

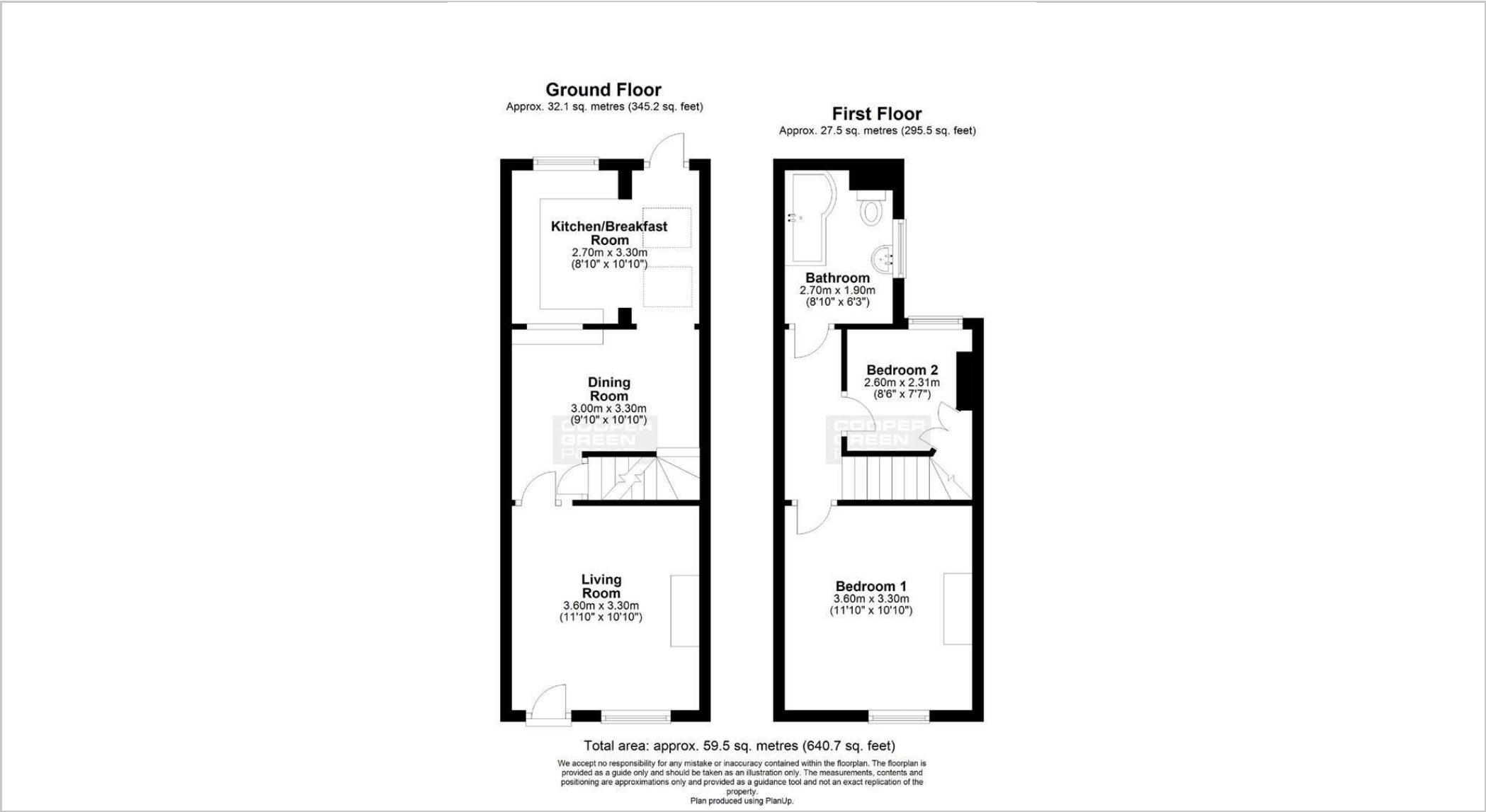

These particulars, whilst believed to be accurate are set out as a general outline only for guidance and do not constitute any part of an offer or contract. Intending purchasers should not rely on them as statements of representation of fact, but must satisfy themselves by inspection or otherwise as to their accuracy. No person in this firms employment has the authority to make or give any representation or warranty in respect of the property.