







Property Description

Situated in a highly convenient town centre location, this purpose built two-bedroom semi-detached home at Grays Road is for sale,

Slough offers an excellent opportunity for first-time buyers, commuters and investors alike.

The property benefits from being within walking distance of Slough's Elizabeth Line station, providing fast and direct links into central London, Heathrow and beyond, making it ideal for those requiring easy daily commuting.

Internally,

The accommodation is well laid out and includes an entrance hall, a ground floor cloakroom, separate kitchen and a bright living space. Upstairs, the property boasts two generously sized double bedrooms with a family bathroom offering comfortable and flexible living for couples or small families

Externally, the home offers excellent potential to extend (STPP), allowing buyers to add value and tailor the property to their future needs.

The location is a key highlight, falling within the catchments area for well-regarded primary schools and grammar schools, and being just moments from local shops, amenities, High Street and transport links.

Entrance Hall

Radiator, stairs to first floor

Cloakroom

Side aspect window, WC, wash hand basin, heated towel rail, tiled floor

Lounge

Front aspect window, radiator, laminate floor

Kitchen

Rear aspect window, range of wall & base units, single bowl sink drainer with mixer tap, four ring integrated gas hob with oven under, cooker hood, plumbing for washing machine, space for fridge freezer, radiator, tiled floor

Utility Room

Inner hall door to garden, wall mounted boiler

First Floor

Landing

Side aspect window, access to loft, laminate floor

Bedroom One

Front aspect window, store cupboard, laminate floor

Bedroom Two

Rear aspect window, laminate floor

Bathroom

Rear aspect window, bath with mixer tap & shower attachment, wash hand basin, WC, heated towel rail, extractor fan, fully tiled

Outside

Front Garden

Block paved (no dropped kerb)

Rear Garden

Mainly laid to lawn with patio, outbuilding for storage



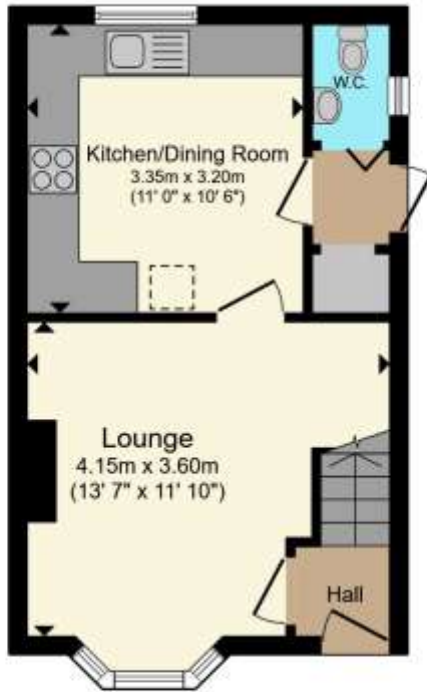

Ground Floor

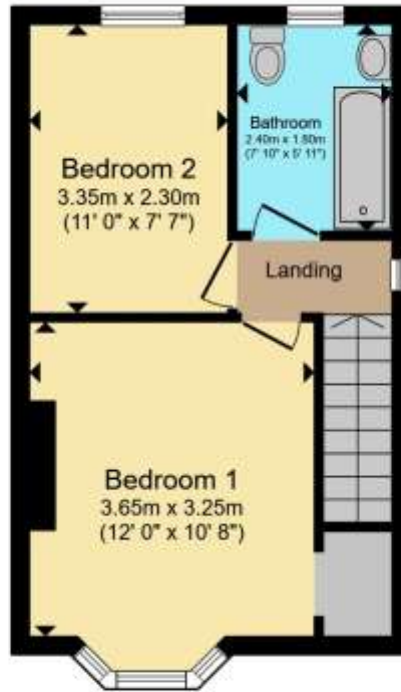

First Floor

Total floor area 60.7 m² (653 sq.ft.) approx

This floor plan is for illustrative purposes only. It is not drawn to scale. Any measurements, floor areas (including any total floor area), openings and orientation are approximate. No details are guaranteed, they cannot be relied upon for any purpose and they do not form part of any agreement. No liability is taken for any error, omission or misstatement. A party must rely upon its own inspection(s). Powered by www.propertybox.io

Connells



To view this property please contact Connells on

T 01753 810 870
E slough@connells.co.uk

111 High Street
SLOUGH SL1 1DH



Tenure: Freehold



[view this property online connells.co.uk/Property/SGH311647](https://connells.co.uk/Property/SGH311647)

1. MONEY LAUNDERING REGULATIONS Intending purchasers will be asked to produce identification documentation at a later stage and we would ask for your co-operation in order that there will be no delay in agreeing the sale. 2. These particulars do not constitute part or all of an offer or contract. 3. The measurements indicated are supplied for guidance only and as such must be considered incorrect. Potential buyers are advised to recheck measurements before committing to any expense. 4. We have not tested any apparatus, equipment, fixtures, fittings or services and it is in the buyers interest to check the working condition of any appliances.

Connells Residential is registered in England and Wales under company number 1489613, Registered Office is Cumbria House, 16-20 Hockliffe Street, Leighton Buzzard, Bedfordshire, LU7 1GN. VAT Registration Number is 500 2481 05.

EPC Rating: D Council Tax
Band: C