



Wear Road

Stanley DH9 6HJ

£85,000





This footer paragraph is an example only and should not be relied upon as complying with current legislation. These particulars, whilst believed to be accurate are set out as a general outline only for guidance and do not constitute any part of an offer or contract. Intending purchasers should not rely on them as statements of representation of fact, but must satisfy themselves by inspection or otherwise as to their accuracy. No person in this firms employment has the authority to make or give any representation or warranty in respect of the property.

Wear Road

Stanley DH9 6HJ



Situated in the heart of Stanley on Wear Road, this charming three-bedroom semi-detached house offers convenience. The property comprises of a spacious lounge, a refitted Beech effect galley-style kitchen and additionally, the ground floor features a convenient WC, enhancing the practicality of the home.

Upstairs, you will find three bedrooms, ideal for families and a white family bathroom/wc.

One of the standout features of this property is the large rear garden, which offers ample outdoor space for gardening, play, or simply enjoying the fresh air, gardens extending to three sides.

This property benefits from UPVC double glazed windows and gas central heating via radiators.

This home is available for immediate vacant possession, making it an excellent opportunity for those looking to move in without delay. Situated in the town centre, you will benefit from easy access to local amenities, schools, and transport links.

Do not miss the chance to view this lovely property. For more information or to arrange a viewing, please

call us at 0191 3729898.

Freehold
Council tax band A
EPC to be confirmed

ENTRANCE VESTIBULE

LOUNGE

14'8" x 12'11" (4.47m x 3.94m)

KITCHEN

14'8" x 6'2" (4.47m x 1.88m)

REAR LOBBY

GROUND FLOOR WC

FIRST FLOOR

BEDROOM 1

13'2" max x 10'4" (4.01m max x 3.15m)

BEDROOM 2

8'5" x 7'2" (2.57m x 2.18m)

BEDROOM 3

8'4" x 7'4" (2.54m x 2.24m)

BATHROOM/WC/SHOWER

OUTSIDE

www.venturepropertiesuk.com

GROUND FLOOR

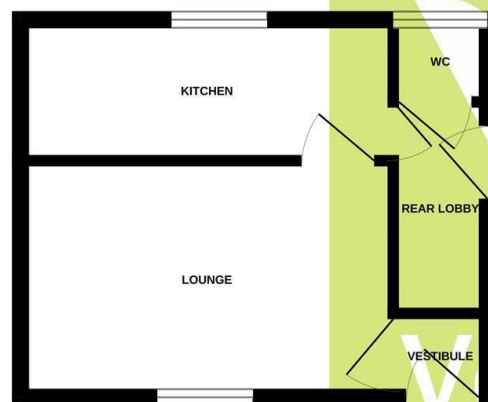

1ST FLOOR

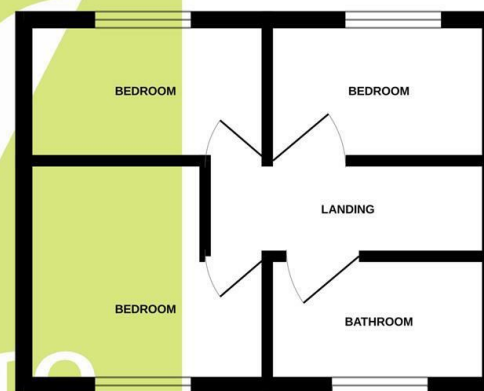

Whilst every attempt has been made to ensure the accuracy of the floorplan contained here, measurements of doors, windows, rooms and any other items are approximate and no responsibility is taken for any error, omission or mis-statement. This plan is for illustrative purposes only and should be used as such by any prospective purchaser. The services, systems and appliances shown have not been tested and no guarantee as to their operability or efficiency can be given.
Made with Metropix ©2025

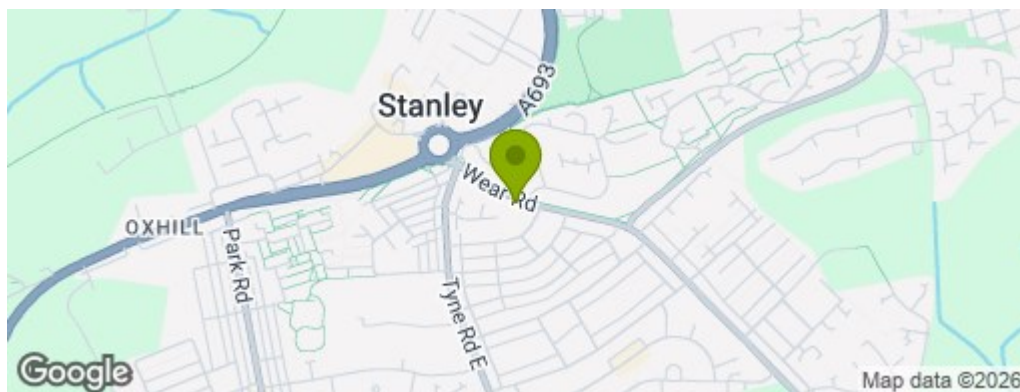

Property Information

0191 372 9898

Suite 6, 15 North Burns, Chester-le-Street, County Durham, DH3 3TF
sales.cls@venturepropertiesuk.com