



Addison
ESTATE AGENTS
SOLD
01223 268499



Addison
ESTATE AGENTS



39 Firecracker Drive, Locks Heath, Southampton, Hampshire, SO31 6BW

£399,950 Freehold

Offered for sale with no forward chain and located in the highly desirable Strawberry Field development in Locks Heath, this modern four-bedroom townhouse, originally built by Taylor Wimpey in 2016, offers spacious and versatile accommodation arranged over three floors and has been further enhanced by the installation of a brand new kitchen.

The ground floor features the newly fitted kitchen positioned to the front of the property, finished in a contemporary style and providing a practical space for everyday family living. To the rear is a bright and welcoming lounge with doors opening onto a south/westerly facing garden, allowing plenty of natural light and creating an ideal space for relaxing or entertaining.

The first floor offers three well-proportioned bedrooms along with a family bathroom and a versatile study area, which works well as a home office, reading space or additional storage area depending on individual needs.

Occupying the entire top floor is the main bedroom which benefits from dual aspect windows and its own en-suite shower room, creating a comfortable and light-filled space.

Externally, the property benefits from three allocated parking spaces, which is a great advantage within the development. The home is also presented in excellent condition throughout, making it ready to move straight into.

Strawberry Field is a popular modern development located close to Locks Heath Centre, offering a range of shops, restaurants and everyday amenities. The property also falls within the catchment for Brookfield Secondary School and Locks Heath Infant and Primary Schools, making it particularly appealing for families. Residents of the development also enjoy access to a children’s play park and a peaceful balancing pond, creating a pleasant community environment.

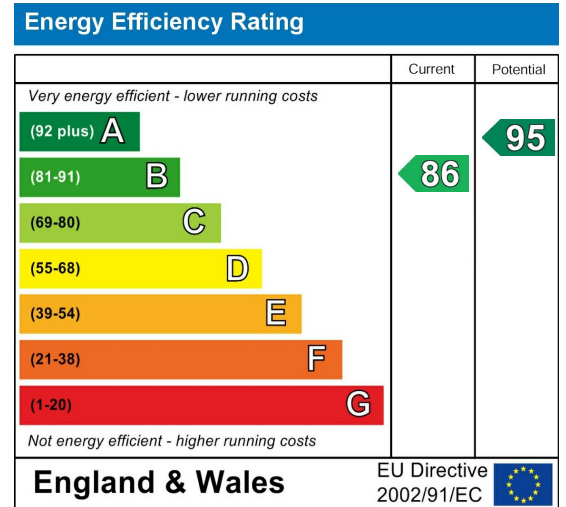

Further Information

Local Council:
Fareham Borough Council

Council Tax Band: D

Amount Payable for 2025/2026:
£2,164.55





APPROXIMATE GROSS INTERNAL AREA = 1283 SQ FT / 119.2 SQ M

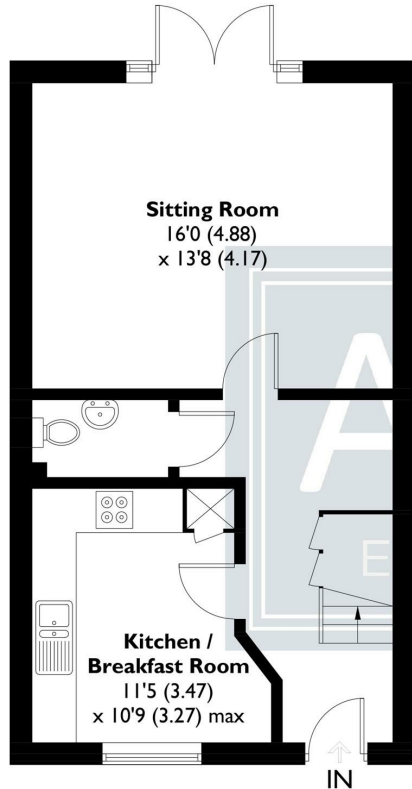

GROUND FLOOR
476 SQ FT / 44.2 SQ M

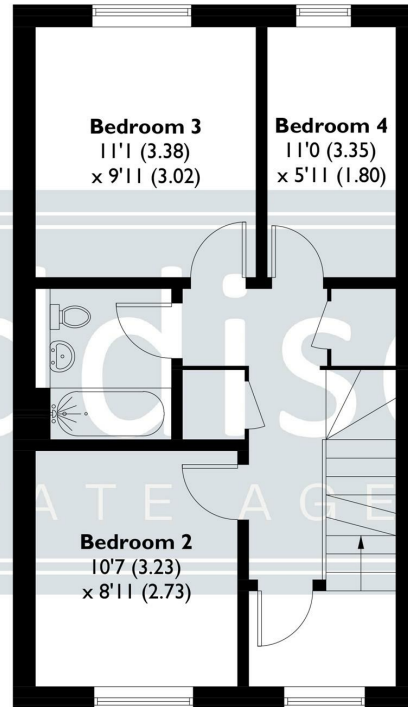

FIRST FLOOR
471 SQ FT / 43.8 SQ M

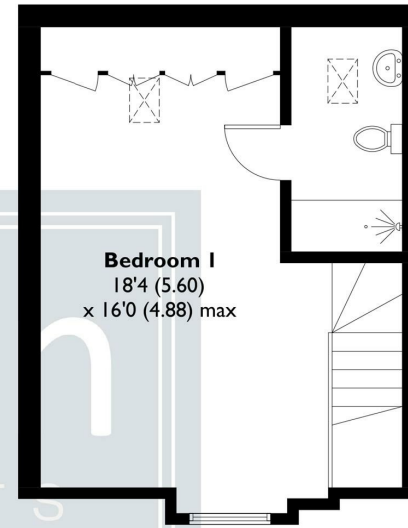

SECOND FLOOR
336 SQ FT / 31.2 SQ M

- Modern four-bedroom townhouse built by Taylor Wimpey in 2016.
 - Offered with no forward chain & located within the popular Strawberry Field development
- Brand new kitchen fitted to the front of the property.
- Spacious lounge to the rear with doors opening onto the garden.
- South/westerly facing garden enjoying plenty of afternoon and evening sun.
- Four well-proportioned bedrooms arranged across the upper floors.
 - Main bedroom with dual aspect windows and en-suite shower room.
- Family bathroom and a versatile study area ideal for home working.
 - Three allocated parking spaces.
- Conveniently located close to Locks Heath Centre and within catchment for Brookfield Secondary School and Locks Heath Infant & Primary Schools.

This plan is for layout guidance only. Not drawn to scale unless stated. Windows and door openings are approximate. Whilst every care is taken in the preparation of this plan, please check all dimensions, shapes and compass bearings before making any decisions reliant upon them. Created by Emzo Marketing (ID1281804)
Produced for Addison Estate Agents



Addison
ESTATE AGENTS



01489 668 999



sales@addisonestateagents.co.uk



www.addisonestateagents.co.uk