



HEREFORD PLACE, SE14

£350,000

One bedroom apartment
Open plan living
Lift access
Spacious private balcony
Close to stations
Energy rating: b

@marshandparsons
marshandparsons.co.uk

MARSH &
PARSONS



ABOUT THE PROPERTY

This stylish 553 sq ft apartment offers an open plan layout with a sleek integrated kitchen, space for dining and a spacious private balcony. The modern three piece bathroom adds to the contemporary feel throughout. Residents benefit from secure entry, bike storage, and lift access.

Ideally located, the property is moments from New Cross, New Cross Gate and Deptford stations, offering quick links to London Bridge, Shoreditch and Canary Wharf. Nearby cafes, shops, and parks add to the area's vibrant appeal.



STEP INSIDE HEREFORD PLACE

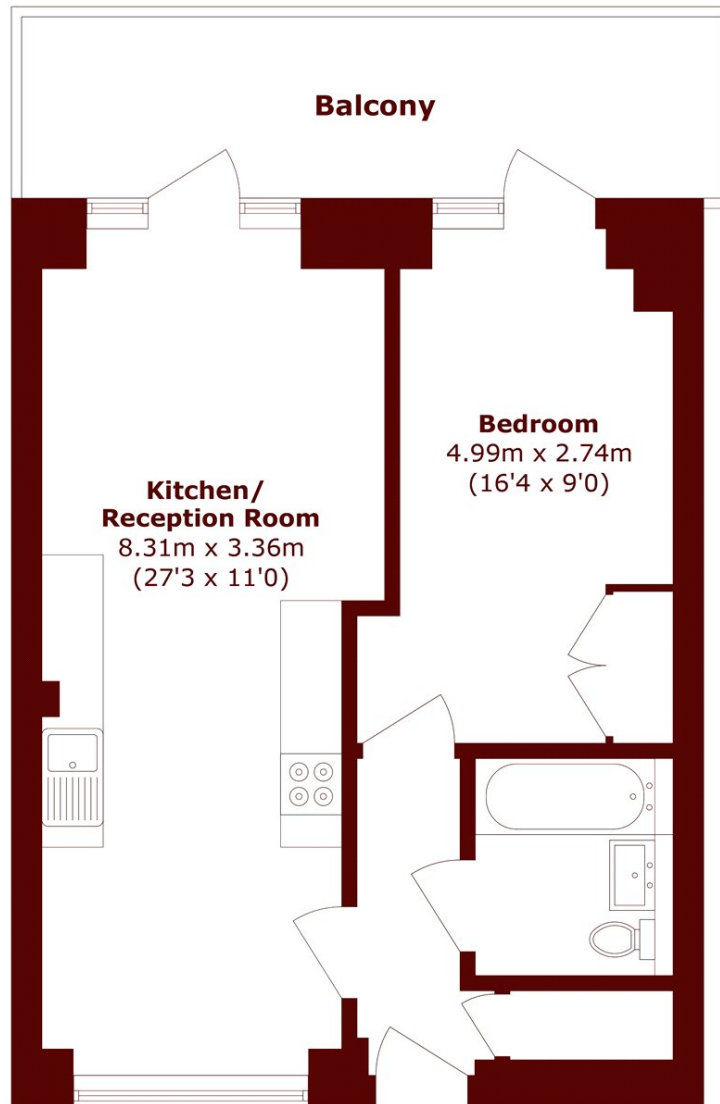

Total area (approx.): 51.4 sq. m (553.2 sq. ft)
Balcony area (approx.): 12.2 sq. m (131.3 sq. ft)

Greenwich
020 8312 8312

Energy Rating: B We aim to make our particulars both accurate and reliable. However, they are not guaranteed; nor do they form part of an offer or contract. If you require clarification on any points then please contact us, especially if you're traveling some distance to view. Please note that appliances and heating systems have not been tested and therefore no warranties can be given as to their good working order

**MARSH &
PARSONS**