

King's Road, SW10
Approx. Gross Internal Area
690 Sq Ft - 64.10 Sq M

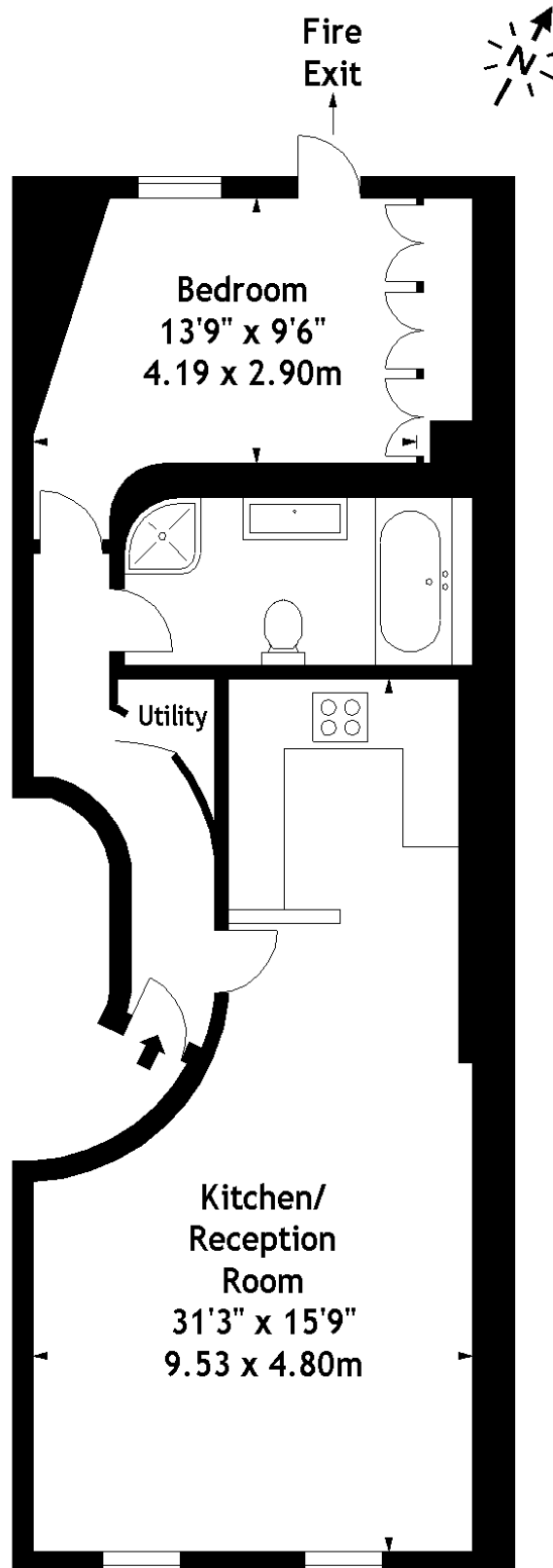

First Floor

Every attempt is made to ensure accuracy, however measurements are Approximate and for Illustrative purposes only. Not to Scale

© Datography UK Ltd 2006

Photographs * Floorplans * Virtual Tours
Tel: 0207 386 3735 www.datography.com