



MORPETH STREET, E2

£475,000 LEASEHOLD

- Grade II Listed
- 6th and 7th floors
- Renowned brutalist architecture
- Panoramic City and Canary Wharf views
- South and West facing
- Popular Bethnal Green location



Trevelyan House

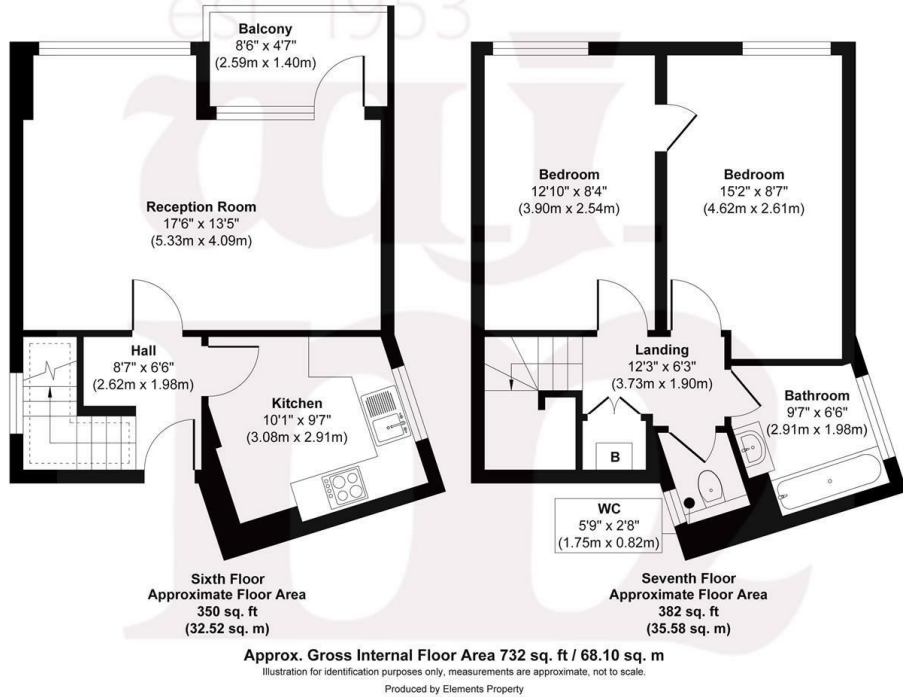

WJ Meade are delighted to present this top floor split level maisonette within the iconic Trevelyan House; designed by Sir Denys Lasdun in 1952 and awarded listed status due to its importance and early contribution to new ideas in urban housing as well as its sculptural architectural form. Arranged over 732sq ft with two double bedrooms, stylish bathroom suite with separate WC, modern fitted kitchen and then a reception room with original glazing and door leading out to a wonderful South facing balcony providing far reaching views toward the Canary Wharf cityscape and the skyline of the City.

All sizes are approximate. The Agent has not tested any apparatus, equipment, fixtures and fittings, or services and so cannot verify that they are in working order or fit for the purpose. A buyer is advised to obtain verification from their Solicitors or Surveyor. Photographs are for illustration purposes only and may depict items, which are not for sale or included in the sale price. References to tenure of a property are based upon information supplied by the vendor. The agent has not had sight of the title documents, a buyer is advised to obtain verification from their solicitor. Money Laundering Regulations 2003: Intending purchasers will be asked to produce identification, documentation at a later stage and we would ask for your co-operation in order that there will be no delay in agreeing the sale.

These particulars are intended to give a fair description of the property only and are in no way guaranteed, nor do of any contract. They are issued on the express condition that all negotiations are conducted through WJ. Meade Estate Agents. All subject to contract and to being unsold.

Service charge £3,142.39
Ground rent £10.00
Lease 125 years from 16/06/1989
Council tax band C
Current EPC Rating 53
Tenure: Leasehold

