

Buy. Sell. Rent. Let.



Summerfield Avenue, Waltham



When it comes to
property it must be

lovelle



£192,000



A three-bedroom semi-detached family home for sale in the popular village of Waltham near Grimsby, offering three reception rooms including a conservatory, modern kitchen with utility space, two double bedrooms with built-in wardrobes, off-road parking with garage, and a landscaped rear garden, all within easy reach of village amenities, schools and transport links.

Key Features

- Semi-Detached House
- Three Bedrooms
- Two Reception Rooms & Conservatory
- Modern Kitchen & Bathroom
- Pleasant Garden, Driveway & Garage
- uPVC DG & GCH
- EPC rating TBC
- Tenure: Freehold





Lovelle offer to market this three-bedroom semi-detached house in the well-regarded village of Waltham, near Grimsby, offering practical family accommodation with good access to local amenities and transport.

On the ground floor, a welcoming hallway with stairs to the first floor leads to three reception areas. The main reception room features a gas fire with feature surround and a bay window, providing a comfortable living area. A separate dining room offers a defined space for family meals and entertaining and has doors leading through to the conservatory. The conservatory in turn opens directly onto the rear garden, creating a useful link between indoor and outdoor space.

The kitchen is fitted with modern wall and base units, oven with gas hob, sink, and plumbing for a dishwasher. A laundry room forms part of the conservatory, split into two areas to provide additional utility space and flexibility for day-to-day household tasks.

Upstairs, the landing includes a built-in cupboard housing the boiler, providing convenient storage. There are three bedrooms: two doubles, each with built-in wardrobes, with the main bedroom also benefiting from a bay window; and a single bedroom, again with built-in storage. The bathroom is fitted with a shower cubicle, sink and WC.

Externally, the property offers a large driveway providing off-road parking, together with a garage. The landscaped rear garden includes lawn and patio areas, a greenhouse and two sheds, offering a range of options for gardening, storage and outdoor seating. The home benefits from uPVC double glazing and gas central heating.

Waltham village provides a range of local shops, cafes, pubs and everyday services along and around the High Street, making day-to-day living convenient. Nearby schools serve different age groups, which will appeal to families and first-time buyers planning for the longer term. The surrounding area offers established walking routes in and around the village and towards the edge of the Lincolnshire Wolds, providing accessible outdoor space.

Public transport links connect Waltham with Grimsby, Cleethorpes and surrounding areas via local bus services. Grimsby town centre and Grimsby Town railway station are accessible by road, from where regular rail services run to destinations including Lincoln, Cleethorpes and Manchester, supporting commuting and leisure travel.

Disclaimer

We endeavour to make our sales particulars accurate and reliable, however, they do not constitute or form part of an offer or any contract and none is to be relied upon as statements of representation or fact. Any services, systems and appliances listed in this specification have not been tested by us and no guarantee as to their operating ability or efficiency is given. All measurements have been taken as a guide to prospective buyers only, and are not precise. If you require clarification or further information on any points, please contact us, especially if you are travelling some distance to view.

Mobile and broadband

It is advised that prospective purchasers visit checker.ofcom.org.uk in order to review available wifi speeds and mobile connectivity at the property.







Ground Floor

Approx. 72.5 sq. metres (780.8 sq. feet)

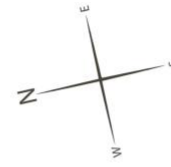

First Floor

Approx. 39.9 sq. metres (429.2 sq. feet)

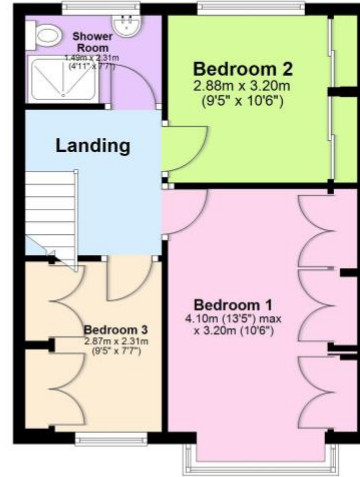

Total area: approx. 112.4 sq. metres (1209.9 sq. feet)

The provided floor plan is intended for general informational purposes only and may not accurately represent the exact dimensions, layout, or features of the property. The floor plan should not be relied upon for making decisions about purchasing, renting, or modifying the property. Actual measurements and features may vary. It is recommended that interested parties conduct a physical inspection of the property to verify the accuracy of the floor plan and obtain specific information about the property's condition, amenities, and any other relevant details.
Plan produced using PlanUp.

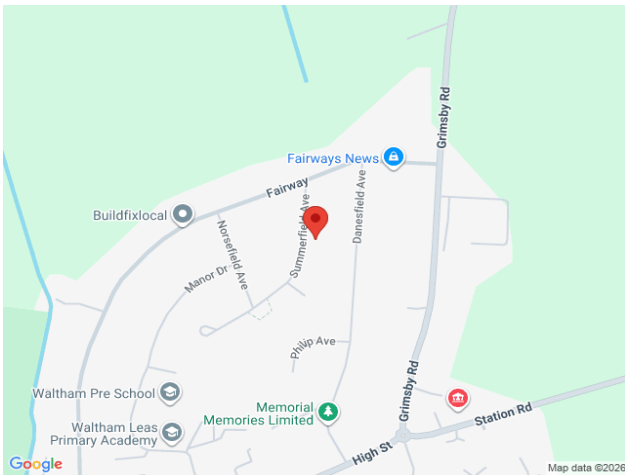

lovelle

When it comes to **property**
it must be

01472 251918

grimsby@lovelle.co.uk

