

ELLIOTTS

Working hard for you



30 Homedrive House The Drive, Hove, BN3 6GE

£99,950 Leasehold

ELLIOTTS are delighted to offer this good sized front facing first floor retirement apartment, sought after block with a host of communal facilities including lovely gardens to the rear, extends to around 482 Sq Ft/44 Sq Mtrs, with good sized lounge and bedroom with dressing area, no on going chain.

- Front Facing
- c482 Sq Ft/c45 Sq Mtrs
- Chain Free
- Host Of Communal Facilities
- Lovely Communal Gardens
- First Floor (Lift)
- Popular Retirement Block
- Residents Aged 60 Or Above
- Good Storage
- Bedroom With Small Dressing Area



www.elliottsestateagents.co.uk

2 Church Road, Hove, East Sussex, BN3 2FL

T: 01273 773399

E: mail@elliottsestateagents.co.uk

Registered No 2829245

Registered Office: 2 Church Road, Hove, East Sussex, BN3 2FL

ELLIOTTS

Working hard for you



The apartment enjoys a prime location on The Drive, a tree-lined road that leads directly to the seafront and Hove City Centre. A bus stop conveniently situated right outside the complex provides easy access throughout the city, while Hove mainline station is within walking distance, less than half a mile away. Homedrive House, developed by McCarthy & Stone, comprises 58 self-contained retirement flats designed for residents over 60, each benefiting from warden assistance. Situated in the heart of Hove, this development offers a range of communal amenities, including a welcoming residents' lounge, laundry facilities, guest accommodations, and lift.



The block has beautifully maintained communal gardens, featuring an array of vibrant flowers, shrubs, and trees. The tranquil outdoor space includes terraces, patios, providing a peaceful setting. Overlooking The Drive, the apartment offers a generous living space for a property of this type, extending to approximately 482 square feet (nearly 45 square metres). It comprises a well-proportioned lounge/dining room and a bedroom with a dressing area to the rear. Ample storage is available, and the property is offered for sale chain free.



www.elliottsestateagents.co.uk

2 Church Road, Hove, East Sussex, BN3 2FL

T: 01273 773399

E: mail@elliottsestateagents.co.uk

Registered No 2829245

Registered Office: 2 Church Road, Hove, East Sussex, BN3 2FL

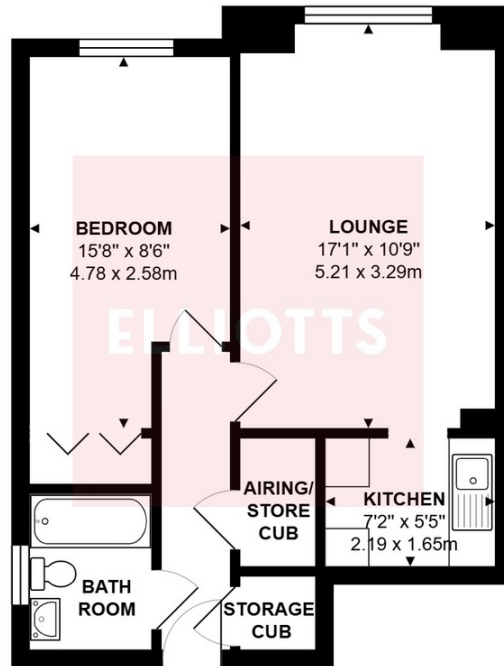

Total Area: 482 ft² ... 44.7 m²

All measurements are approximate
and for display purposes only



You may download, store and use the material for your own personal use and research. You may not republish, retransmit, redistribute or otherwise make the material available to any party or make the same available on any website, online service or bulletin board of your own or of any other party or make the same available in hard copy or in any other media without the website owner's express prior written consent. The website owner's copyright must remain on all reproductions of material taken from this website.

2 Church Road, Hove, East Sussex, BN3 2FL

T: 01273 773399

E: mail@elliottsestateagents.co.uk

Registered No 2829245

Registered Office: 2 Church Road, Hove, East Sussex, BN3 2FL