



18 Minerva Court
Boroughbridge York, Yorkshire YO51 9PB

Guide price £124,950



18 Minerva Court, Boroughbridge York, Yorkshire YO51 9PB

STUNNING NEWLEY DECORATED 2 BEDROOM FIRST FLOOR FLAT WITHIN LEVEL WALKING DISTANCE TO BOROUGHBRIDGE TOWN AND LOCAL AMENITIES 189 YEAR LEASE
GAS CENTRAL HEATING, PRIVATE ENTRANCE
SITTING ROOM WITH RIVER VIEWS BREAKFAST KITCHEN WITH APPLIANCES
SHOWER ROOM AND STORAGE RESIDENTIAL CUL DE SAC FOR THE OVER 55'S
EPC C COUNCIL TAX BAND B

Description

Ideal home for those aged over 55, a two bedroom deceptively spacious first floor apartment with lovely river views The accommodation comprises private entrance hall, sitting room, breakfast kitchen, two bedrooms and a shower room. Externally there are communal gardens. Available with no onward chain. 18 Minerva Court is part of a complex and comprises a mix of principally apartments with a few houses and residents who own or occupy the properties need to be age 55 or over. The well laid out first floor accommodation has the benefit of gas central heating and private entrance with intercom. EPC C Council tax band B

Location

The town of Boroughbridge is situated on the route of the former Great North Road which was the link between London and Edinburgh. The town has grown over the years and now offers a traditional high street of independent shops, a large Morrisons supermarket, doctor and dental surgeries, a public transport service that connects to York, Harrogate and Ripon. A number of high street banks, main post office and library. Boroughbridge is well placed for access to the Yorkshire Dales and North York Moors National Parks; as well as being ten miles from Fountains Abbey, which is a designated World Heritage Site. The Spa town of Harrogate and the Cathedral City of York are a short drive and offer a wider range of shopping facilities,

theatre, cinema and train service that connects to Leeds, London and Edinburgh



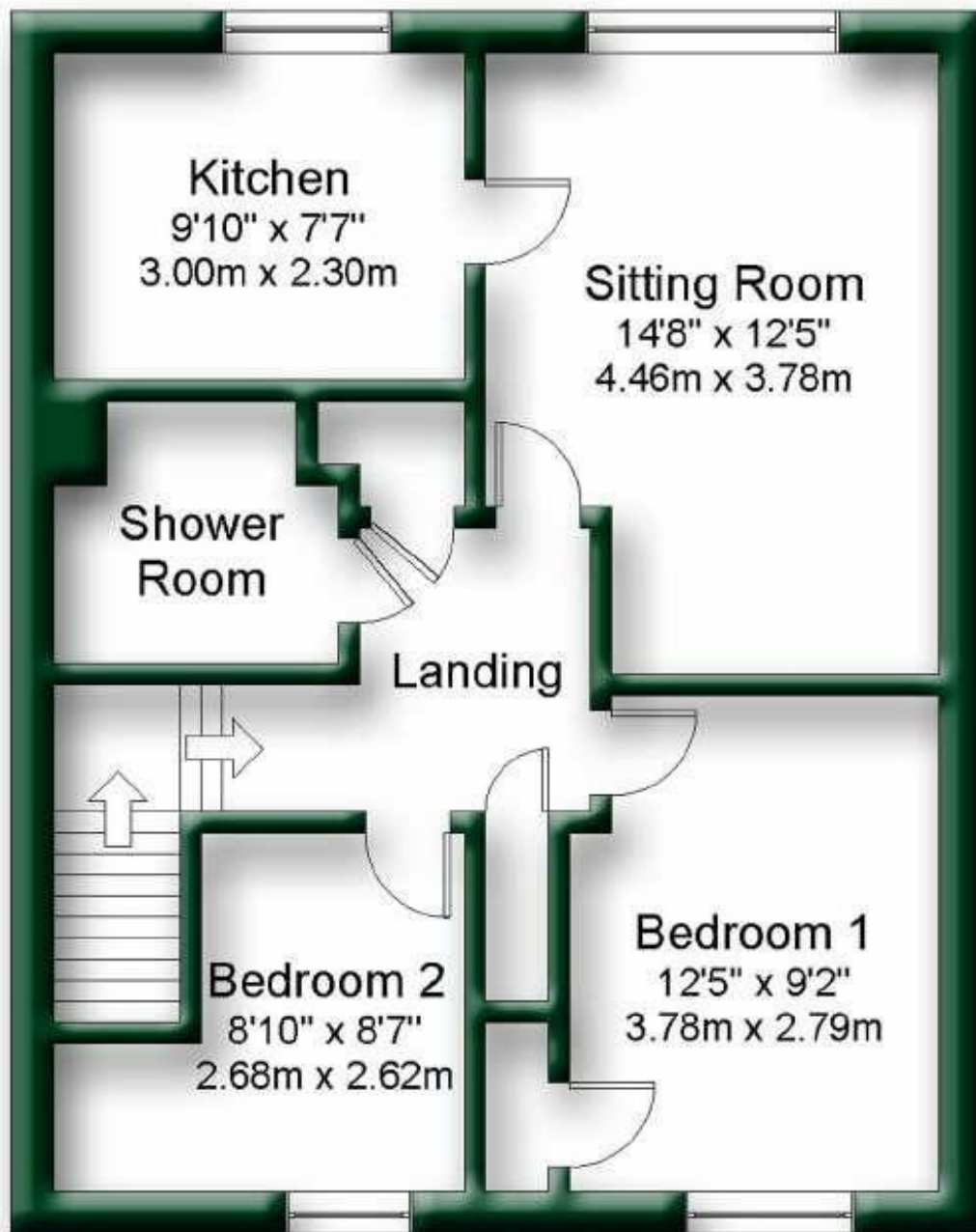

Not to Scale.
Copyright © Apex Plans.

