



## Boston Road, W7

£499,950

This two bedroom Victorian freehold property is being offered to the market with no onward chain. The property comprises of two reception rooms, a separate kitchen and a garden.

Located near Hanwell Broadway with amenities, Boston Road's transport links and within catchment for St Mark's, Oaklands Primary and Elthorne Park high schools. Hanwell (Elizabeth line) and Boston Manor (Piccadilly line) are just over half a mile away.

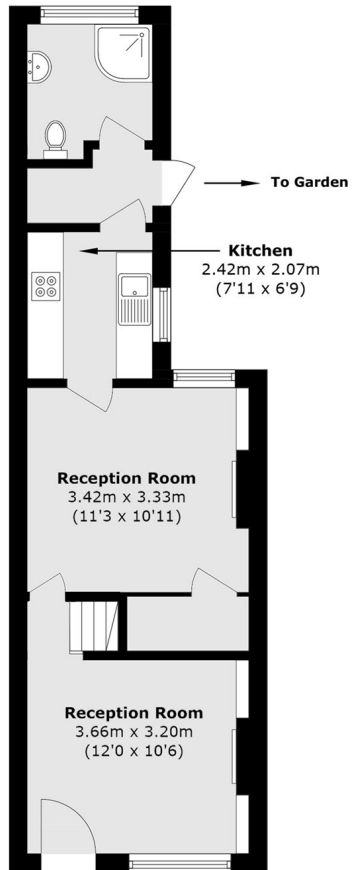

**Ground Floor**

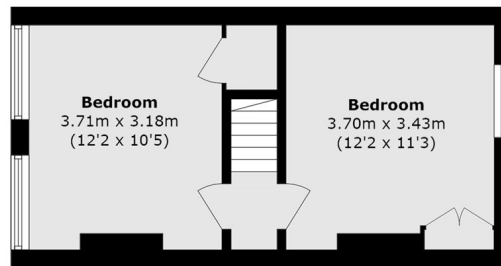

**First Floor**

Total area (approx.): 69.0 sq. m (742.7 sq. ft)

Robertson Smith & Kempson Hanwell Sales  
69 Greenford Avenue,  
London, W7 1LL  
020 8566 2339  
[hanwellsales@robertsonsmithandkempson.co.uk](mailto:hanwellsales@robertsonsmithandkempson.co.uk)

Energy Rating: D. We aim to make our particulars both accurate and reliable. However they are not guaranteed; nor do they form part of an offer or contract. If you require clarification on any points then please contact us, especially if you're traveling some distance to view. Please note that appliances and heating systems have not been tested and therefore no warranties can be given as to their good working order.