

Savoy Road

BRISLINGTON

APPROXIMATE FLOOR AREA
108.4 SQM / 1167 SQFT



GROUND FLOOR
501 sq.ft. (46.5 sq.m.) approx.

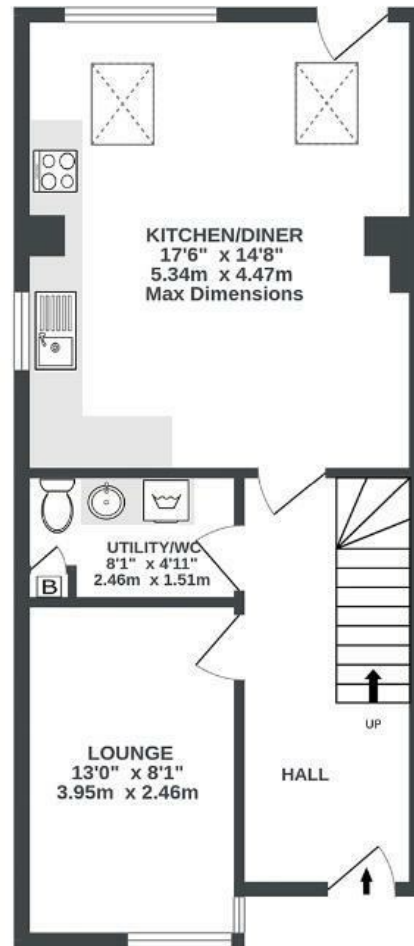

1ST FLOOR
362 sq.ft. (33.7 sq.m.) approx.

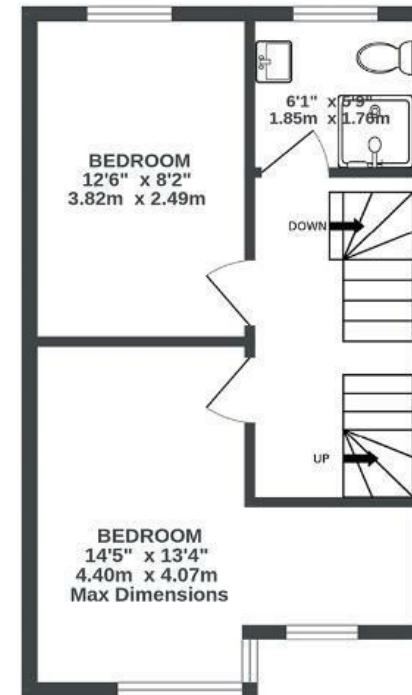

2ND FLOOR
304 sq.ft. (28.2 sq.m.) approx.

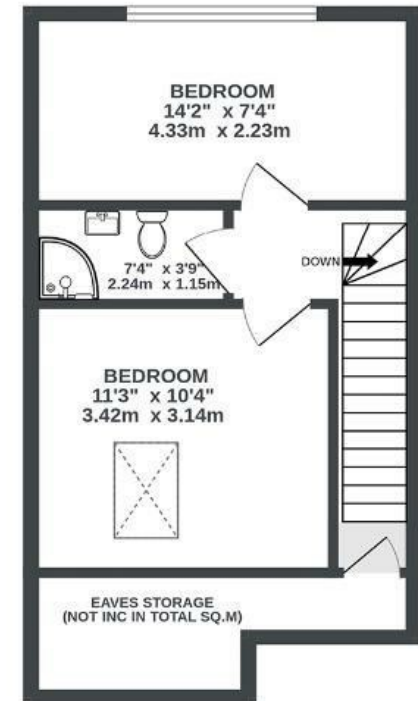

Illustrations are for reference purposes only, measurements are approximate, not to scale.

Boardwalk

Savoy Road , BRISTOL

£

£525,000



BS4 3SY

zzz

4 Bedrooms



3 Bathrooms

" A great new build house close to all the shops and cafes on Sandy Park Road. The house is also ideally situated for all the green spaces Brislington has to offer "

