



**11G., MARGARET
STREET, GREENOCK, PA16 8AS**





Description

Occupying a prime West End location just moments from the Esplanade and the waterfront this larger style beautifully finished, internally upgraded bright three bedroom TOP FLOOR FLAT with balcony providing private outside space offers immaculately presented living. The decked balcony with ornate handrail features views towards the Esplanade and River Clyde and is an ideal space for relaxing on summer days. Lies convenient for local amenities, the town centre and transport facilities.

There is a shared rear drying green / garden with private timber shed providing useful storage. Specification includes: double glazing, gas central heating, wooden window shutters and quality laminate flooring.

The immediately impressive stylish accommodation comprises: Entrance Hallway by composite double glazed door with side window and two cupboards providing useful storage. There is a front facing airy and spacious Lounge with access to the balcony by double glazed door with further front facing windows either side of the door. The quality fitted Kitchen features a rear window plus a range of white/grey high gloss units and marble style work surfaces. Appliances include: stainless steel chimney extractor hood, gas hob and electric oven.

There are three double sized Bedrooms. Bedrooms 1 and 2 both feature wardrobe storage units. The 3rd bedroom is currently used as a dining room and benefits from a side window with views to the Esplanade. There is a quality refitted Bathroom with rear window, plus pedestal wash hand basin, wc, bath with mixer shower and additional "Mira" shower. Additional features include: partial wall tiling, shower screen and chrome style heated towel rail.

Immediate viewing is advised for this beautifully presented and stylish home close to the waterfront. EPC = C.

Measurements

Hallway

Lounge
4.62m x 4.09m (15'2 x 13'5)

Kitchen
2.29m x 2.84m (7'6 x 9'4)

Bedroom 1
3.10m x 4.06m (10'2 x 13'4)

Bedroom 2
2.79m x 4.09m (9'2 x 13'5)

Bedroom 3
2.64m x 4.09m (8'8 x 13'5)

Bathroom

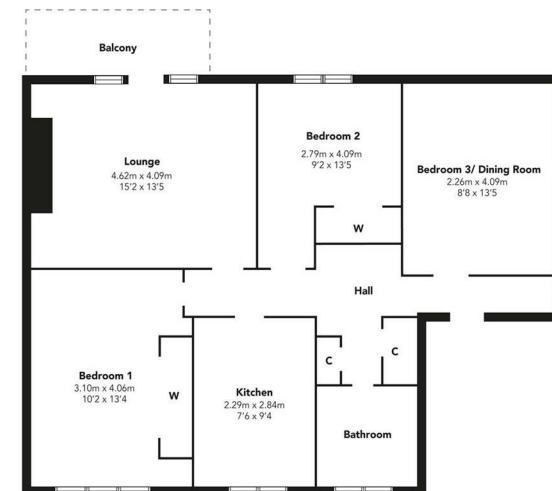

Floorplans are indicative only - not to scale
Produced by Plushplans











The
next
step..



To view call 01475 888400. Speak to us 7 days a week until 11pm every day to book your viewing appointment.

House to sell or rent?

Call 01475 888400 to book your free market appraisal.

Require a solicitor?

Ask us to supply a free legal quotation from Neill Clerk & Murray, Solicitors.
www.neillclerkmurray.co.uk

Stay fully up-to-date by following Neill Clerk on:



**60 West Blackhall Street
Greenock
Renfrewshire
PA15 1UY**

t: 01475 888400

e: sales@neillclerk.co.uk

w: www.neillclerk.co.uk



Agents Notes:

These sales particulars are set out as a general outline only, issued in good faith, but do not constitute representations of fact and do not form part of any offer or contract. Any services, equipment, appliances, fittings or central heating systems have not been tested and no warranty is given or implied that these are in working order. All measurements are approximate and for guidance only.

Neither Neill Clerk Estate Agents nor any of its employees or agents has any authority to make or give any representation or warranty whatever in relation to this property.

Find all our properties at: [rightmove](https://www.rightmove.co.uk) [Zoopla](https://www.zoopla.co.uk) [onTheMarket.com](https://www.onthemarket.com) [s1homes.com](https://www.s1homes.com)