







**£275,000**

Situated in Fenny Stratford is this two bedroom terraced home with character features. The property boasts a lounge/diner, kitchen/ diner and a generous family bathroom. Further benefits include the property being fully refurbished throughout.

# Property Description

## ENTRANCE

Wooden door to:

## ENTRANCE HALL

Doors to lounge and dining room, stairs rising to first floor, radiator.

## LOUNGE

Double glazed bay window to front aspect. Radiator, feature fireplace.

## DINING ROOM

Double glazed window to rear aspect. Radiator, storage cupboard.

## KITCHEN

Double glazed window to rear aspect, double glazed window to side aspect, door to side. Fitted with a range of base and eye level units with wooden work surface over, part tiled walls, one and a half bowl porcelain sink unit with mixer tap, integrated induction hob and oven, space for fridge freezer, space for washing machine, radiator.

## BEDROOM ONE

Double glazed window to front aspect. Radiator, feature fireplace, storage cupboard.

## BEDROOM TWO

Double glazed window to rear aspect. Radiator, built-in wardrobe.

## BATHROOM

Double glazed frosted window to rear aspect. Low level WC, panelled bath with shower attachment and mixer tap, wash hand basin in vanity unit with mixer tap, part tiled walls, radiator.

## OUTSIDE

### PARKING

On-street permit parking.

### FRONT GARDEN

Path to front door with gravel border, enclosed by brick wall.

### REAR GARDEN

Laid to lawn with patio area, raised borders, shed, side gated access, all enclosed by timber fence panelling.



GROUND FLOOR  
465 sq.ft. (43.2 sq.m.) approx.

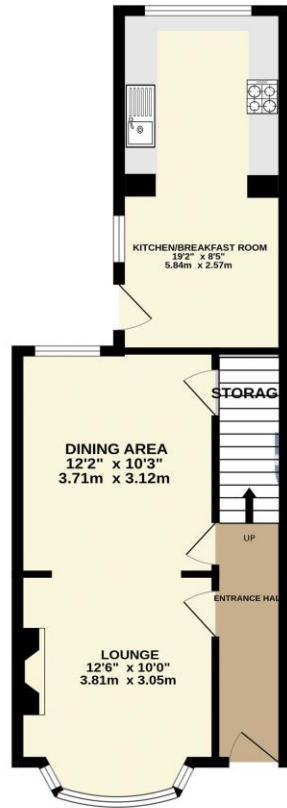

1ST FLOOR  
384 sq.ft. (35.7 sq.m.) approx.



Michael  
ANTHONY

TOTAL FLOOR AREA : 849 sq.ft. (78.9 sq.m.) approx.

Whilst every attempt has been made to ensure the accuracy of the floorplan contained here, measurements of doors, windows, rooms and any other items are approximate and no responsibility is taken for any error, omission or mis-statement. This plan is for illustrative purposes only and should be used as such by any prospective purchaser. The services, systems and appliances shown have not been tested and no guarantee as to their operability or efficiency can be given.  
Made with Metroplan ©2026

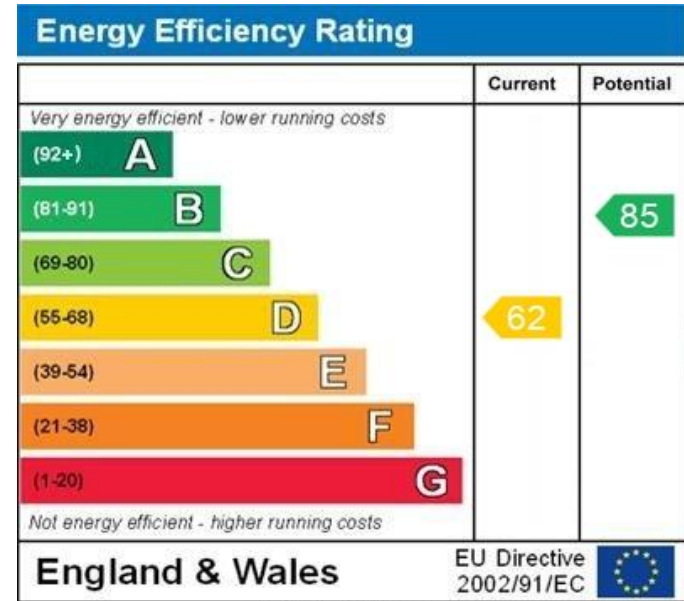

WWW.EPC4U.COM

MONEY LAUNDERING REGULATIONS 2017 intending purchasers will be asked to produce identification and proof of financial status when an offer is received. We would ask for your co-operation in order that there will be no delay in agreeing the sale.

THE CONSUMER PROTECTION REGULATIONS 2008 The Agent has not tested any apparatus, equipment, fixtures and fittings or services and so cannot verify that they are in working order or fit for the purpose. A Buyer is advised to obtain verification from their Solicitor or Surveyor. References to the Tenure of a Property are based on information supplied by the Seller. The Agent has not had sight of the title documents. A Buyer is advised to obtain verification from their Solicitor. You are advised to check the availability of this property before travelling any distance to view. We have taken every precaution to ensure that these details are accurate and not misleading. If there is any point which is of particular importance to you, please contact us and we will provide any information you require. This is advisable, particularly if you intend to travel some distance to view the property. The mention of any appliances and services within these details does not imply that they are in full and efficient working order. These particulars are in draft form awaiting Vendors confirmation of their accuracy. These details must therefore be taken as a guide only and approved details should be requested from the agents

190 Queensway Bletchley Milton Keynes MK2 2ST  
01908 648 666 | bletchley@maea.co.uk