



Whitton Road, TW1

£339,950

A beautifully presented top floor one bedroom apartment situated in a popular development close to Twickenham High Street. The property is sold with a share of the freehold and has been modernised throughout.

Whitton Road is located just a few hundred yards from Twickenham mainline station with its fast link to London Waterloo and also the town centre where you will find a vast array of shops, bars and restaurants.

Features

- One Bedroom
- Purpose Built
- Top Floor
- Beautifully Presented
- Central Location
- Share Of Freehold

Whitton Road, Twickenham, TW1

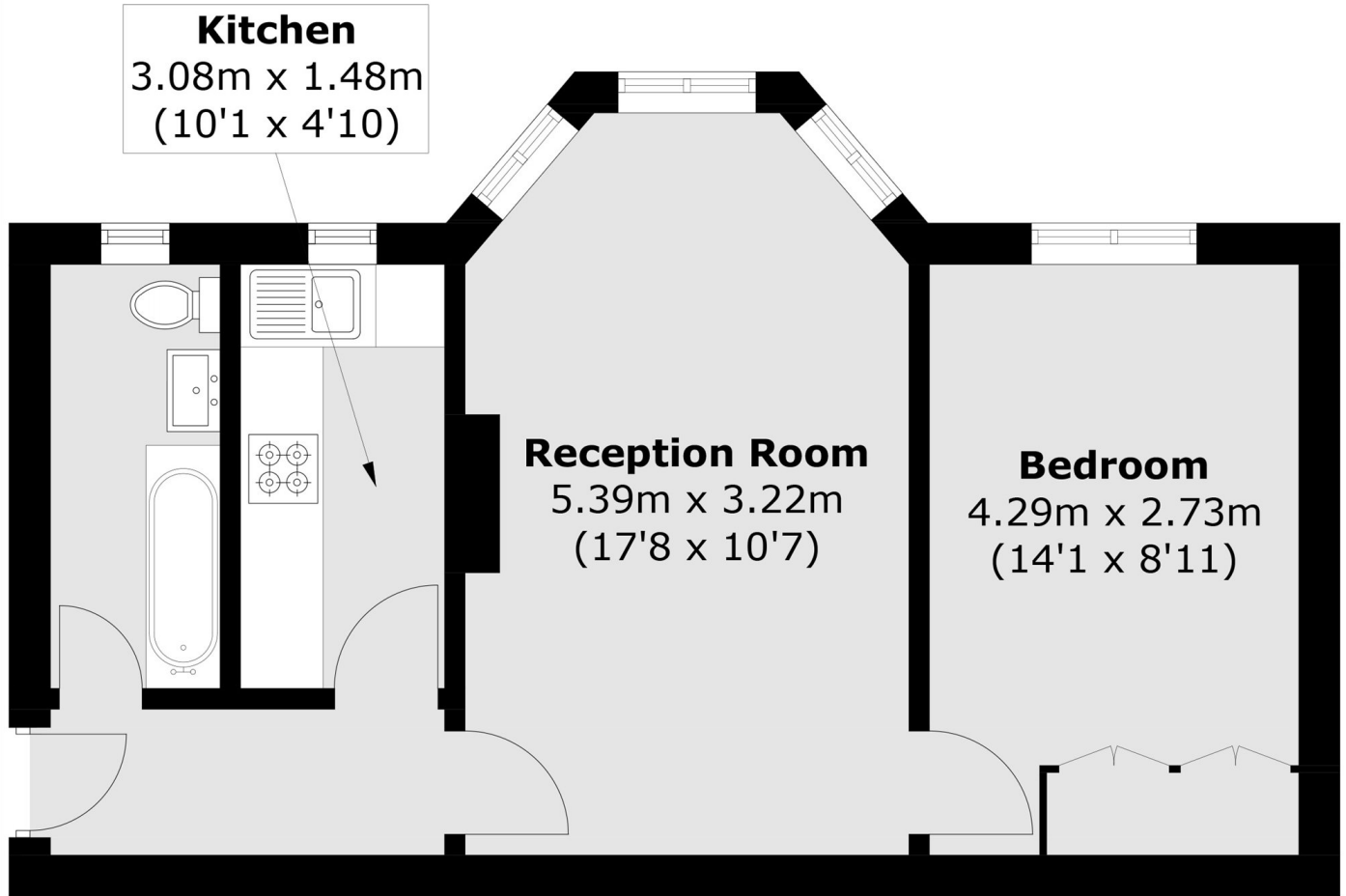

Total area (approx.): 41.5 sq. m (446.7 sq. ft)