



12, Pear Tree Drive, Rowley Regis, West Midlands, B65 9QA

Offers In The Region Of £280,000

- DETACHED HOUSE IN CUL-DE-SAC LOCATION
 - THREE GOOD SIZED BEDROOMS
 - LOUNGE, DINING ROOM, AND CONSERVATORY
- GUEST WC, HOUSE BATHROOM AND EN-SUITE SHOWER ROOM
 - GARAGE AND DRIVEWAY

All Buildings Great & Small



RICS
Regulated by RICS

arla naea
propertymark



intertek
ISO 9001:2015



UKAS
MANAGEMENT
SYSTEMS
014

OnTheMarket rightmove



Situated in a cul-de-sac location is this detached house with three good sized bedrooms and integral garage.

Accommodation comprising reception hall which continues onto dining room, ground floor WC, kitchen, lounge, conservatory, first floor landing, airing cupboard, three good sized bedrooms (one with ensuite shower room), bathroom, integral garage, rear garden. Gas boiler serving radiators. Double glazing to windows as detailed.

RECEPTION HALL (inner)

Obscure double glazed front door, panel radiator, coving to ceiling, leading to

DINING ROOM (rear) 2.45m x 4.53m including staircase
Panel radiator, coving to ceiling, double glazed door onto conservatory.

CONSERVATORY (rear) 2.71m x 2.75m

Panel radiator, double glazed windows and door onto rear garden.

GROUND FLOOR WC (front)

WC with flush, panel radiator, obscure double-glazed window, toilet roll holder, pedestal wash hand basin with hot and cold taps.

KITCHEN (front) 2.65m x 2.23m

Double glazed double windows, , range of base units fitted with cupboards and drawers, worktops with tiled splashbacks, wall mounted store cupboards, single bowl single drainer stainless steel sink with mixer tap, recess for fridge, recess and plumbing for washing machine, , integrated cooker, four ring gas hob, extractor fan above, coving to ceiling.

LOUNGE (rear) 3.30m narrowing to 2.26m x 4.43m

Panel radiator, double glazed windows, gas fire with surround.

Staircase from reception hall leading to

FIRST FLOOR LANDING (Inner/side)

Double glazed window, airing cupboard housing hot water cylinder, access to roof space, doors off.

BEDROOM ONE (rear) 3.50m x 3.33m

Panel radiator, double glazed window. Door onto ensuite shower room.

EN-SUITE SHOWER ROOM (side) 1.65m x 1.46m (2.30m max into shower)

Obscure double glazed window, panel radiator, WC with push button flush, pedestal wash hand basin with hot and cold taps, tiled splash back, towel rail, shower cubicle with shower, walls tiled to full height, shaver point.

BEDROOM TWO (rear) 3.56m x 2.52m

Panel radiator, double glazed window.

BEDROOM THREE (front) 3.50m x 3.71m (2.71m)

restricted ceiling height in places.

Panel radiator, double glazed window.

BATHROOM (front) 2.26m (1.71m) x 1.90m

Panel radiator, double glazed window, walls tiled to half height, panel bath with hot and cold taps, WC, pedestal wash hand basin with hot and cold taps, towel holder, shaver point, wall mounted mirrored cupboard, extractor.

GARAGE 2.52m x 5.34m (4.49m to door)

REAR GARDEN

Patio area, lawn, pathway leading to top of garden with summer house/store.

COUNCIL TAX BAND C

TENURE

We are verbally advised the property is freehold. The Agent has not checked the legal documents to verify the freehold status of the property. The buyer is advised to obtain verification from their Solicitor or Surveyor.

SERVICES

The Agents have not tested any apparatus, equipment, fixtures, fittings or services and so cannot verify they are in working order or fit for their purpose. The buyer is advised to obtain verification from their Solicitor or Surveyor.

FIXTURES AND FITTINGS

All items unless specifically referred to in these sales particulars are expressly excluded from the proposed sale. However, fitted carpets, curtains and certain other items may be taken at a valuation to be agreed.

Extra Services & AML

Money Laundering Regulations –

In order to comply with Money Laundering Regulations, all prospective purchasers are required to provide the following - 1. Satisfactory photographic identification. 2. Proof of address/residency. 3. Verification of the source of purchase funds including bank statements for deposits in order to purchase and copy of mortgage agreement in principle from the appropriate lender. In the absence of being able to provide appropriate physical copies of the above, Scriven & Co reserves the right to obtain electronic verification of identity.

Extra services -

By law, the agent must tell the client if the agent or any connected person intends to earn any commission or any other fees from offering or referring other services to the client or buyer. If the agent or any connected person earns money from any of these services or referrals the agent or the connected person would keep this commission or fee. Part of the payment for these extra services will be paid to the agent as a result of the referral.

Scriven & Co offers the following services and has the following referral arrangements in place:

Scriven & Co routinely refers sellers (and buyers) to Infinity Financial Advice. It is the clients' or buyers' decision whether to choose to deal with Infinity Financial Advice. Should the client or a buyer decide to use Infinity Financial Advice the client or buyer should know that Scriven & Co receive a payment from Infinity Financial Advice equating on average to a figure in the order of £200 per referral. Scriven & Co routinely refers sellers (and buyers) to

certain firms of solicitors/conveyancers. It is the clients' or buyers' decision whether to choose to deal with any of the referral companies. Should the client or a buyer decide to use any of these companies the client or buyer should know that Scriven & Co receive a payment from these companies equating to a figure in the order of £100-£200 per referral. We are informed that the solicitors/conveyancers are happy to pay this referral fee to ourselves as it significantly reduces the marketing costs that they have to allocate to sourcing new business. The referral fee is NOT added to the conveyancing charges that would ordinarily be quoted.

The agent routinely refers sellers (and buyers) to Warren's removals and storage. It is the clients' or buyers' decision whether to choose to deal with Warren's removals and storage. Should the client or a buyer decide to use Warren's removals and storage the client or a buyer should know that the agent receives a referral fee to the value of £50 from them for recommending a client or buyer to them.

Property Information Links

Useful links for property information:

Find information about a property in England or Wales:

<https://search-property-information.service.gov.uk>

Mobile and broadband checker: If mobile coverage and broadband speed is an important issue we would suggest checking with: <https://checker.ofcom.org.uk>

Flooding: If you wish to check flooding information in respect of the property, the following may be of assistance: <https://www.gov.uk/request-flooding-history>

Long term flood risk check of an area in England:

<https://www.gov.uk/check-long-term-flood-risk>

Service provider information: we would suggest the following:

Gas supply:

<https://www.ofgem.gov.uk/information-consumers/energy-advice-households/finding-your-energy-supplier-or-network-operator>

<https://www.findmysupplier.energy>

Electric supply:

<https://www.energynetworks.org/customers/find-my-network-operator>

<https://www.nationalgrid.co.uk>

Water supplier:

<https://www.ofwat.gov.uk/households/your-water-company>

<https://www.water.org.uk/customers/find-your-supplier>

Consumer code for house builders:

<https://consumercode.co.uk>

Important notices

Nothing concerning the type of construction or the condition of the structure is to be implied from the photograph (or artists impression) of the property. Items shown in photographs are NOT included unless specifically mentioned within the sales particulars. Certain items may however be available by separate negotiation. The measurements supplied are for general guidance, and as such must be considered as incorrect. A buyer is advised to re-check the measurements themselves before committing themselves to any expense. The Agent has not tested any apparatus, equipment, fixtures, fittings or services, and so does not verify they are in working order, fit for their purpose, or within ownership of the sellers, therefore the buyer must assume the information given is incorrect. Neither has the Agent checked the legal documentation to verify legal status of the property or validity of any guarantee. A buyer must assume the information is incorrect, until it has been verified by their own solicitors. The sales particulars may change in the course of time, and any interested party is advised to make final inspection of the property prior to exchange of contracts. A buyer must check the availability of any property and make an appointment to view before embarking on any journey to see a property. References to the Tenure of a Property are based on information supplied by the Seller. The Agent has not had sight of the title documents. A Buyer is advised to obtain verification from their Solicitor.

Any reference to alterations to, or use of any part of the property, is not a statement that any necessary planning, building regulation or other consent has been obtained. A buyer must assume the information is incorrect until it has been verified by their own solicitors.

VAT: All figures quoted are exclusive of VAT where applicable. **Rating Assessments :** Where provided the Agent has made a verbal enquiry with the Local Authority and this information should be verified by interested parties making their own enquiries. (REV03:02/26).







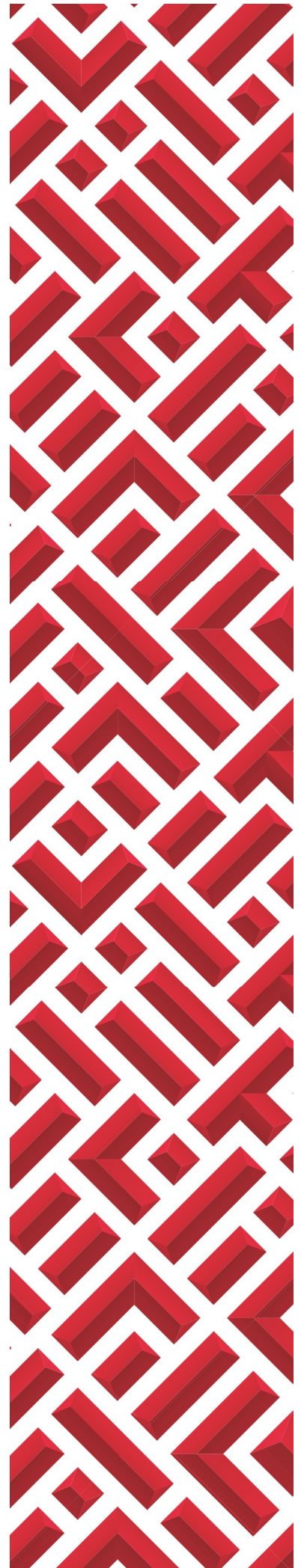

Ground Floor

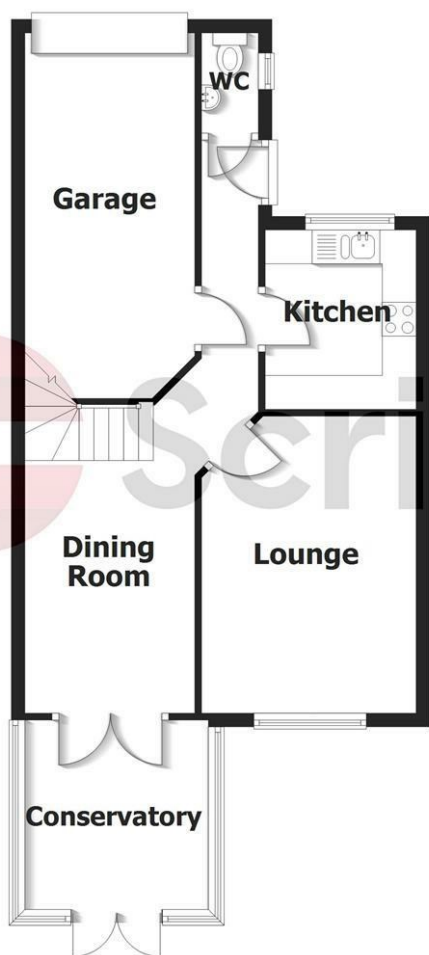

First Floor

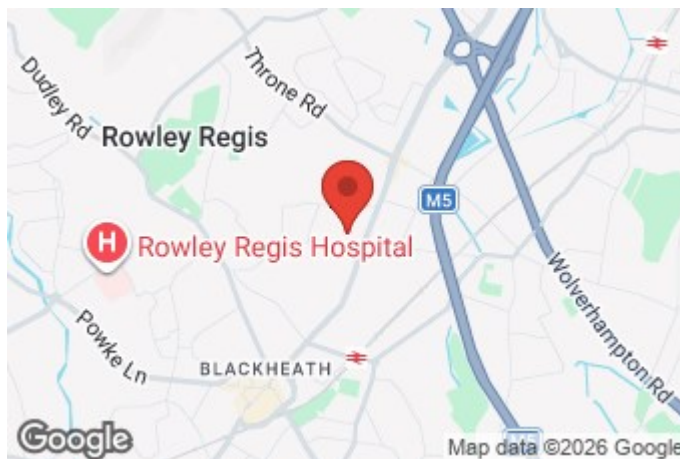
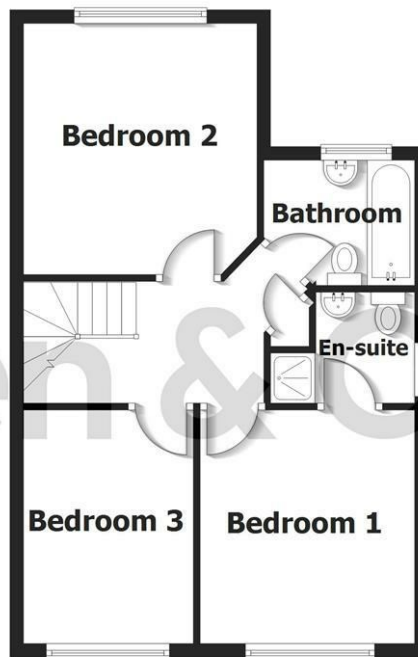

- Estate House, 821 Hagley Road West, Quinton, Birmingham, B32 1AD
- Tel: 0121 422 4011
- E-mail: quinton@scriven.co.uk
- www.scriven.co.uk
- Regulated By RICS

Energy Efficiency Rating		
	Current	Potential
<i>Very energy efficient - lower running costs</i>		
(92 plus) A		
(81-91) B		
(69-80) C		
(55-68) D		
(39-54) E		
(21-38) F		
(1-20) G		
<i>Not energy efficient - higher running costs</i>		
	70	76
England & Wales		EU Directive 2002/91/EC