



# SOUL ESTATES

## SALES & LETTINGS

### TO LET - 2 BEDROOM SEMI-DETACHED HOUSE

**Lower White Road, Quinton, B32**

**£1,100 PCM**

Soul Estates are proud to present this well presented two bedroom semi detached house To Let, located in the highly sought after area of Quinton. This lovely family home is ideally positioned close to local amenities, reputable schools, and the local surgery, making it a convenient and desirable place to live.

The property features an entrance porch leading into a welcoming hallway, with access to the spacious through lounge and a family kitchen. The kitchen is fitted with a matching range of wall and base units, splashback tiling, and benefits from a gas hob with electric oven.

Stairs lead to the first floor landing, giving access to two well proportioned bedrooms and a family bathroom.

Additional benefits include gas central heating, double glazing, a low maintenance front and rear garden, and off road parking.

This property is ideal for small families, couples, or professionals looking for a well located and comfortable home in a popular residential area.

✓ **2 BEDROOM SEMI-DETACHED HOUSE**

✓ **FAMILY BATHROOM**

✓ **LARGE THROUGH LOUNGE**

✓ **PAVED PATIO WITH LAWN**









# SOUL ESTATES

## SALES & LETTINGS

### TO LET - 2 BEDROOM SEMI-DETACHED HOUSE

Lower White Road, Quinton, B32

£1,100 PCM

#### Ground Floor

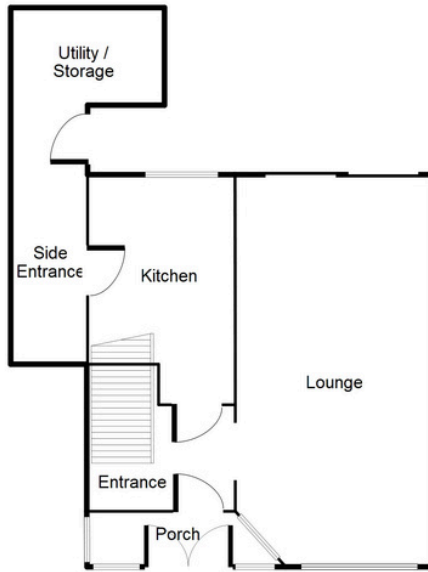

This floorplan is just an example, this is not to scale.  
Please see description for exact room sizes.  
(c) Soul Estates

#### First Floor

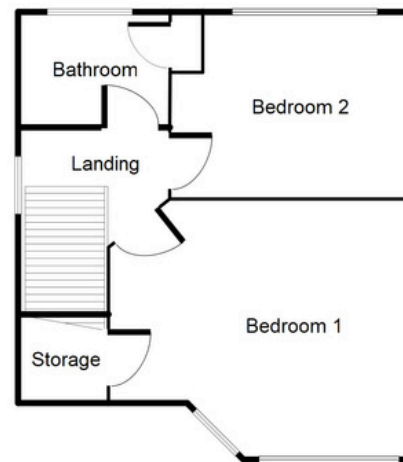

This floorplan is just an example, this is not to scale.  
Please see description for exact room sizes.  
(c) Soul Estates

#### Entrance Hall

5' 3" x 6' 4" (1.60m x 1.93m)

#### Lounge

21' 9" x 9' 4" (6.62m x 2.84m)

#### Kitchen

13' 0" x 6' 4" (3.96m x 1.93m)

#### Bedroom 1

13' 2" x 12' 1" (4.01m x 3.68m)

#### Bedroom 2

9' 5" x 10' 1" (2.87m x 3.07m)

#### Bedroom

6' 9" x 5' 11" (2.06m x 1.80m)



### CONTACT US

Soul Estates  
20 Great Bridge  
Tipton  
DY4 7HA

0121 647 6779

[www.soulestates.co.uk](http://www.soulestates.co.uk)

WWW.SOULESTATES.CO.UK | 0121 647 6779