



✦ AI Enhanced

Flat 3, Riverside House, 4 Kings Crescent

Guide Price £160,000

eden
estates

Flat 3

Riverside House, Aylesford

GUIDE £160,000 to £180,000 - Modern 1 bed flat near Aylesford station, open plan living, kitchen, spacious bedroom, parking, no chain, and communal grounds. Ideal for first-time buyers or investors. Council Tax band: C

Tenure: Leasehold

- NO CHAIN
- 1 DOUBLE BEDROOM APARTMENT
- ALLOCATED PARKING
- 0.2 MILES FROM AYLESFORD MAINLINE RAIL SERVICE INTO THE CITY
- MODERN FITTED KITCHEN WITH INTER-GRATED APPLIANCES
- IDEAL FIRST TIME BUY OR INVESTMENT
- ALLOCATED PARKING AND VISITOR BAYS



eden
estates

OPEN PLAN LOUNGE/KITCHEN/DINER

20' 3" x 15' 5" (6.17m x 4.70m)

BEDROOM

11' 6" x 12' 9" (3.50m x 3.88m)

BATHROOM



eden
estates





COMMUNAL GARDEN

ALLOCATED PARKING

1 Parking Space



Flat 3 Riverside House

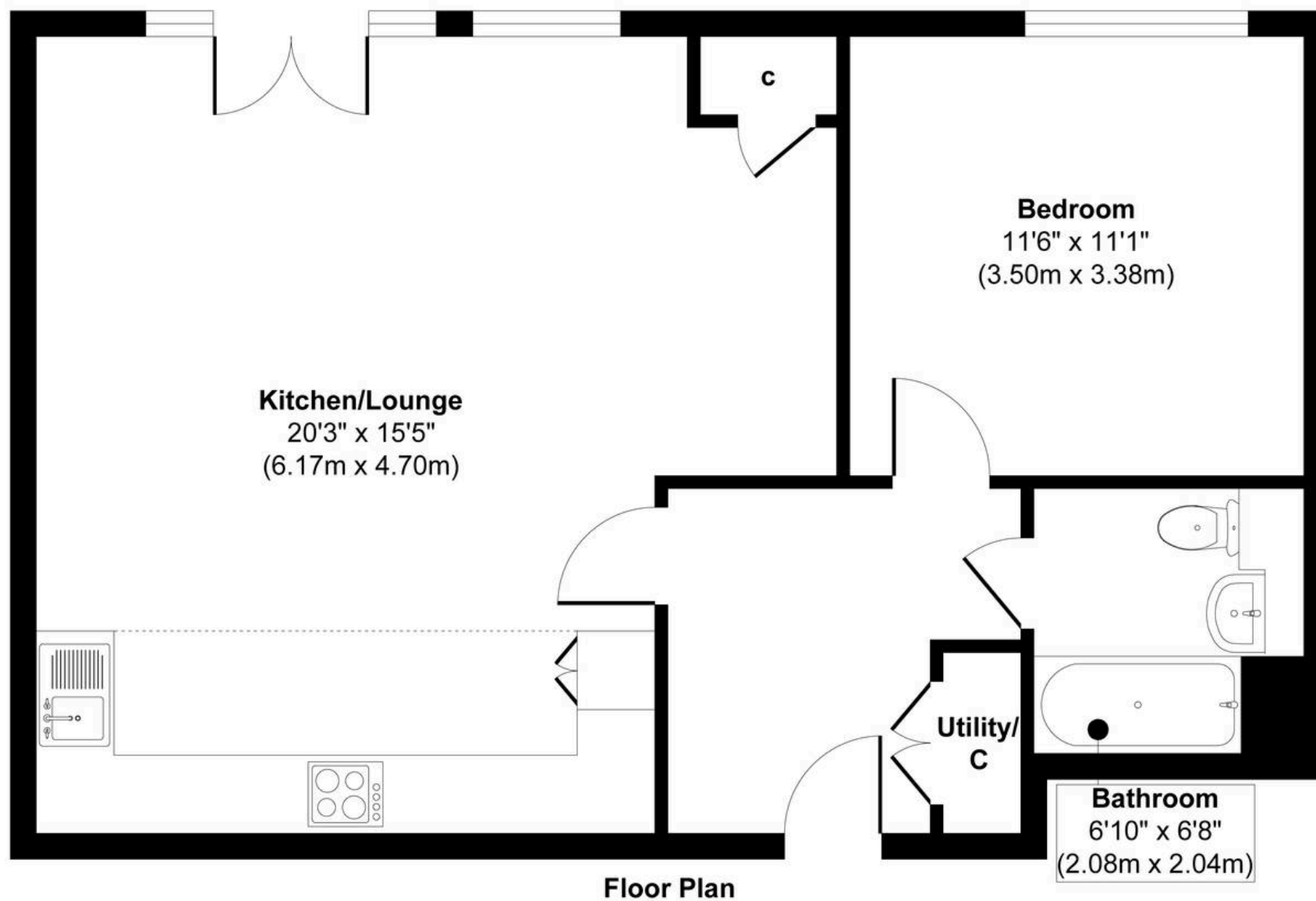
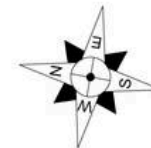

Approx. Gross Internal Floor Area 630 sq. ft / 58.59 sq. m

Illustration for identification purposes only, measurements are approximate, not to scale.



Eden Estates

781-783 London Road, Larkfield - ME20 6DE

01732 795162

hey@eden-estates.co.uk

www.eden-estates.co.uk



eden
estates