



Manor Estate, Doddington March
£300,000 Freehold

**Sharman
Quinney**

Key Features



- No Onward Chain
- Beautifully Renovated Throughout
- Ample Off-Road Parking
- 29ft Workshop with Light and Power
- Generous Rear Garden

Ground Floor

Entrance Hall -

Composite front door. LVT flooring throughout ground floor. Built in storage. Stairs to first floor. Open into Kitchen/Diner/Family room.

Kitchen/Dining/Family Room -

A beautiful and light open concept space, having been completely altered by the current owners. The kitchen comprises from base units in a cottage style with gold hardware and laminate worktops with a porcelain tile backsplash and solid wood windowsill. Integrated appliances including double Hotpoint oven, Hotpoint dishwasher, AEG induction hob with centre venting and space for American style fridge/freezer. Doorway into Utility Room.



The Family Room/Lounge is a cosy space despite being open plan, a standout feature is the Dual Fuel Burner with solid oak mantel and stone hearth with Muninga Wood skirting board, the bay window with real solid wood windowsill lets in ample natural light and opens completely, making it a lovely feature in warmer summer months.

The Dining space flows nicely from the family room and kitchen, making the whole space ideal for entertaining and family life. The archway from the hallway into the dining space is framed in live Ash Wood. There is composite stable door leading out into the garden. Access into downstairs shower room.

Study -
LTV flooring continued, dual aspect windows. Ample space for desk but could also be used as a snug or playroom if needed.

Utility Room -
Accessed from kitchen. Composite door into garden and window to front. Matching units to kitchen with sink and wall units with smart storage.

Shower Room -
A recent addition to the home and at the moment unfinished but will be completed. Comprising of window to rear and three-piece suite including shower unit, low rise toilet and vanity style, space saving sink.



OUTBUILDINGS

GROUND FLOOR

1ST FLOOR

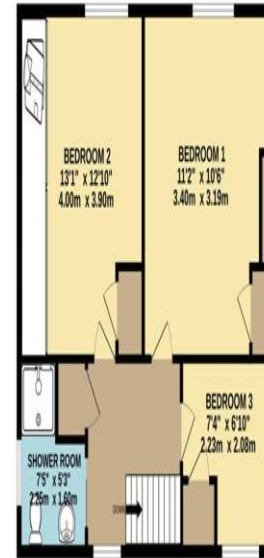
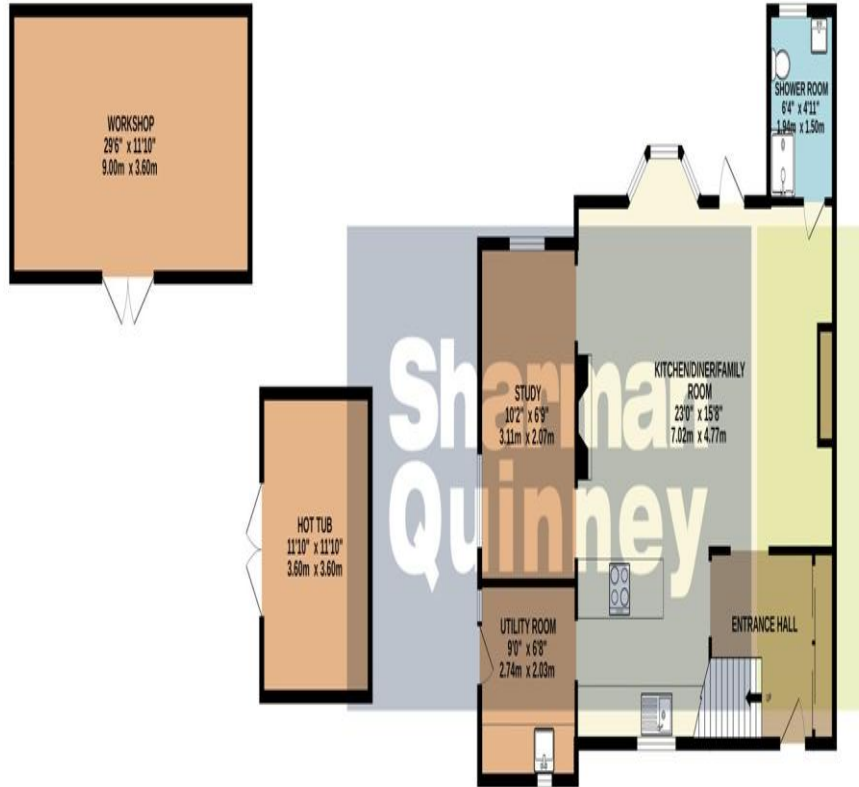

First Floor

Landing -

Fitted carpet, access to all bedrooms and main bathroom. airing cupboard housing Viessmann combi boiler with upgraded magnetic filling system. Loft access.

Bedroom One -

Window to rear overlooking garden with bespoke fitted black out blinds, laminate flooring, feature wall. Built in cupboard.

Bedroom Two -

Window to rear overlooking garden with bespoke fitted blinds, fitted carpet and built in wardrobes with murphy bed and another built in cupboard.

Bedroom Three -

Window to front. Laminate flooring. Built in cupboard.

Shower Room -

Accessed via a custom-made sliding door made from great Sequoia wood with a live edge. Window to side. Fully tiled and fitted with a three-piece suite with brushed gold fixtures, walk

Whilst every attempt has been made to ensure the accuracy of the floorplan contained here, measurements of doors, windows, rooms and any other items are approximate and no responsibility is taken for any error, omission or mis-statement. This plan is for illustrative purposes only and should be used as such by any prospective purchaser. The services, systems and appliances shown have not been tested and no guarantee as to their operability or efficiency can be given.

Made with Metropix ©2026

To view this property call Sharman Quinney on:
01354 661166

Selling your property?

Contact us to arrange a **FREE** home valuation.

 01354 661166

 8 Broad Street, MARCH, Cambridgeshire, PE15 8TG

 march@sharmanquinney.co.uk

 www.sharmanquinney.co.uk



 SCAN ME



Sharman Quinney Holdings Limited is registered in England and Wales under company number 4174227, Registered Office is Cumbria House, 16-20 Hockliffe Street, Leighton Buzzard, Bedfordshire, LU7 1GN. VAT Registration Number is 500 2481 05.

1: These particulars do not constitute part or all of an offer or contract. 2: The measurements indicated are supplied for guidance only and as such must be considered incorrect. 3: Potential buyers are advised to recheck the measurements before committing to any expense. 4: Sharman Quinney has not tested any apparatus, equipment, fixtures, fittings or services and it is the buyers interests to check the working condition of any appliances. 5: Sharman Quinney has not sought to verify the legal title of the property and buyers must obtain verification from their legal representative. 6: Intending purchasers will be asked to produce identification documentation at a later stage and we would ask your co-operation in order that there will be no delay in agreeing the sale. Ref: MRC207151 - 0002

