

Franklyn
James



Galaxy Building, Crews Street, E14 3SP
£1,950 Per Calendar Month



Galaxy Building, Crews Street, E14 3SP

£1,950 Per Calendar Month

- Stunning one-bedroom apartment in a popular riverside development
- One double bedroom
- Large open plan reception room
- Large private balcony
- Fitted wardrobes
- Exclusive access to a high tech residents' gym
- On-site concierge service
- Abundance of natural light
- Located within the sought-after Odyssey development
- Short distance to Canary Wharf Underground Station with excellent transport links

EPC rating- B
Tax band- E



A stunning, one bedroom apartment located with a popular riverside development. The property comprises of a large reception room with access to a large balcony, fully fitted kitchen, large double bedroom with fitted wardrobes and three piece bathroom suite.

The Galaxy Building is situated in the sought after Odyssey development offering residents the perfect work/life balance. Never miss a parcel again with the on-site, 24 hour concierge service, and work on your fitness for the summer with the high tech gym offered exclusively to residents! Canary Wharf underground Station is a short distance away with access to all parts of the Capital.

Galaxy Building, E14
 Approx. Gross Internal Area 629 Sq Ft - 58.44 Sq M

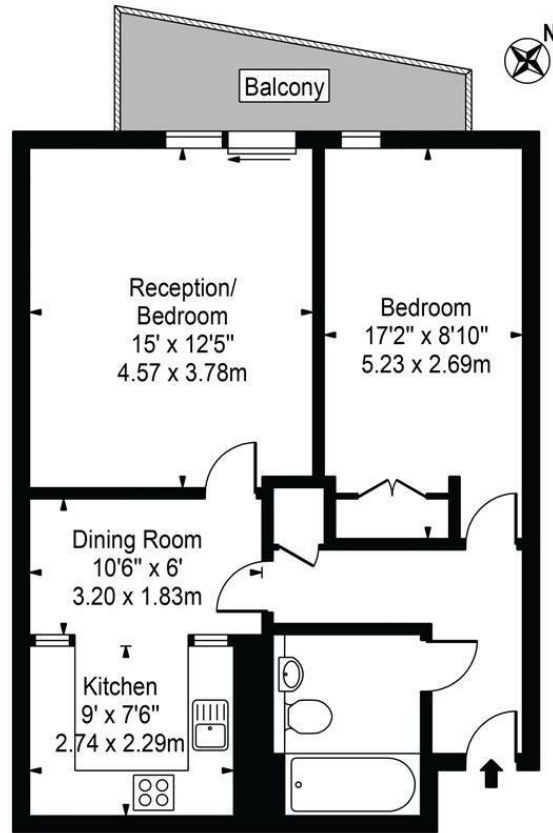

Third Floor

For Illustration Purposes Only - Not To Scale

This floor plan should be used as a general outline for guidance only and does not constitute in whole or in part an offer or contract. Any intending purchaser or lessee should satisfy themselves by inspection, searches, enquiries and full survey as to the correctness of each statement. Any areas, measurements or distances quoted are approximate and should not be used to value a property or be the basis of any sale or let.

Area Map

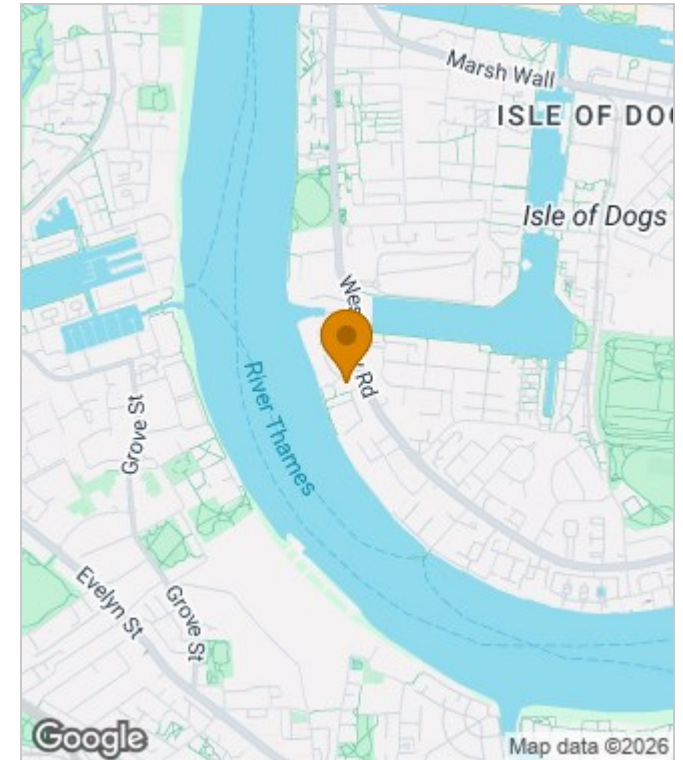

Energy Performance Graph

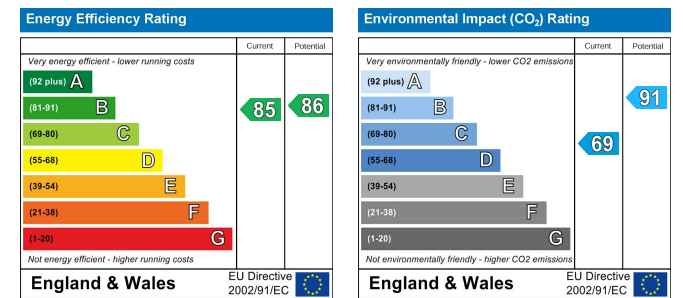

These particulars, whilst believed to be accurate are set out as a general outline only for guidance and do not constitute any part of an offer or contract. Intending purchasers should not rely on them as statements of representation of fact, but must satisfy themselves by inspection or otherwise as to their accuracy. No person in this firm's employment has the authority to make or give any representation or warranty in respect of the property.



29 Narrow Street, London, E14 8DP
 Tel: 02077911777 Email: lettings@franklynjames.co.uk <https://www.franklynjames.co.uk>