





£300,000

Situated in Central Bletchley is this three bedroom semi-detached Victorian home with character features. The property boasts a family bathroom with a separate WC, lounge/diner and kitchen with a butler sink and quartz worktops. Further benefits include an extensive private rear garden.

Property Description

ENTRANCE

Door to:

ENTRANCE HALL

Radiator, stairs rising to first floor, tiled floors.

LOUNGE/DINING ROOM

Double glazed bay window to front aspect, double glazed window to rear aspect.
Wood burning stove, radiator.

KITCHEN

Two double glazed windows to rear aspect. Fitted with a range of wall-mounted and base units with quartz work surface and upstand over, integrated washing machine, dishwasher, double oven and induction hob; space for fridge freezer, radiator, porcelain sink unit, splashback, extractor fan, doors to storage and boot room.

BOOT ROOM

Double glazed frosted door to garden. Door to bathroom.

BATHROOM

Double glazed frosted window to rear aspect. Bath with shower attachment and overhead shower, wash hand basin in vanity unit, heated towel rail, tiled floor, part tiled walls.

CLOAKROOM

Double glazed frosted window to side aspect. Low level WC, radiator, part tiled walls, tiled floor.

LANDING

Doors to bedrooms, storage, loft access.

BEDROOM ONE

Double glazed bay window to front aspect, double glazed window to front aspect.
Radiator, fireplace.

BEDROOM TWO

Double glazed window to rear aspect. Radiator, feature fireplace.

BEDROOM THREE

Double glazed window to rear aspect. Radiator, wall-mounted boiler.

OUTSIDE

REAR GARDEN

Mainly laid to lawn with patio area, electric point, enclosed by wooden fence panelling.

GROUND FLOOR
582 sq.ft. (54.0 sq.m.) approx.

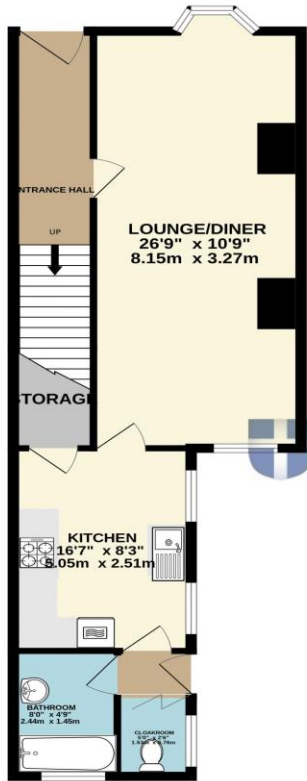

1ST FLOOR
402 sq.ft. (37.3 sq.m.) approx.

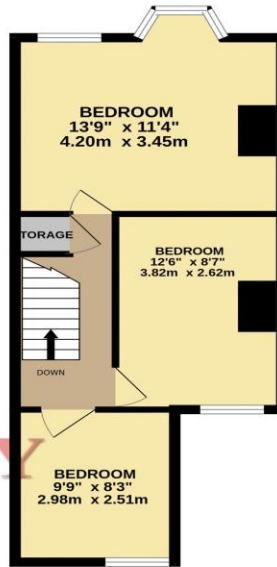

Michael
ANTHONY

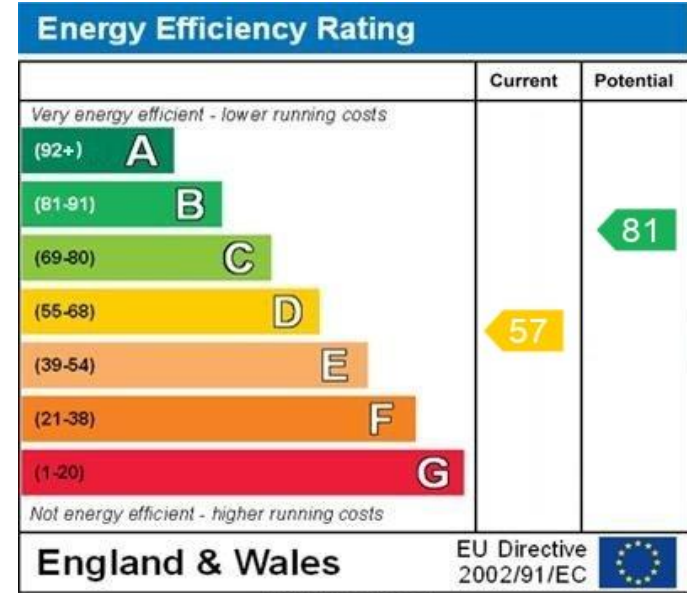

WWW.EPC4U.COM

TOTAL FLOOR AREA : 984 sq.ft. (91.4 sq.m.) approx.

Whilst every attempt has been made to ensure the accuracy of the floorplan contained here, measurements of doors, windows, rooms and any other items are approximate and no responsibility is taken for any error, omission or mis-statement. This plan is for illustrative purposes only and should be used as such by any prospective purchaser. The services, systems and appliances shown have not been tested and no guarantee as to their operability or efficiency can be given.
Made with Metropix 62025

MONEY LAUNDERING REGULATIONS 2017 intending purchasers will be asked to produce identification and proof of financial status when an offer is received. We would ask for your co-operation in order that there will be no delay in agreeing the sale.

THE CONSUMER PROTECTION REGULATIONS 2008 The Agent has not tested any apparatus, equipment, fixtures and fittings or services and so cannot verify that they are in working order or fit for the purpose. A Buyer is advised to obtain verification from their Solicitor or Surveyor. References to the Tenure of a Property are based on information supplied by the Seller. The Agent has not had sight of the title documents. A Buyer is advised to obtain verification from their Solicitor. You are advised to check the availability of this property before travelling any distance to view. We have taken every precaution to ensure that these details are accurate and not misleading. If there is any point which is of particular importance to you, please contact us and we will provide any information you require. This is advisable, particularly if you intend to travel some distance to view the property. The mention of any appliances and services within these details does not imply that they are in full and efficient working order. These particulars are in draft form awaiting Vendors confirmation of their accuracy. These details must therefore be taken as a guide only and approved details should be requested from the agents

190 Queensway Bletchley Milton Keynes MK2 2ST
01908 648 666 | bletchley@maea.co.uk