



Alnesbourn Crescent, Ipswich, IP3 9GD

welcome to

Alnesbourn Crescent, Ipswich

This well-presented, 2nd floor apartment benefits from two bedrooms, a light filled lounge, with Juliet balcony, a good size kitchen, an impressive master bedroom, with triple built in wardrobe and one allocated parking space.

Entrance Hall

Carpet flooring, a storage cupboard, an airing cupboard, one storage radiator, loft hatch and an entry phone system.

Lounge/Diner

Stunning, open plan lounge/diner, flooded with light via two double glazed windows to the front and a Juliet balcony to the side, carpet flooring, one electric radiator, one storage radiator, TV point and an open walkway leading to the kitchen.

Kitchen

Double glazed window to the rear, Herringbone wood effect flooring, an open walkway leading to the lounge/diner, eye and base level units in wood with stone effect worktop surfaces, a stainless steel sink plus drainer and chrome mixer tap, an integrated oven with electric hob and extractor hood, space for a fridge/freezer and washing machine.

Master Bedroom

Double glazed window to the rear, carpet flooring, one electric radiator, TV point and a triple, built in, sliding wardrobe.

Bedroom Two

Double glazed window to the front, carpet flooring and one electric radiator.

Bathroom

Low level WC, pedestal wash hand basin, a bath with shower attachment, chrome heated towel rail, wood effect flooring, extractor fan, one electric heater, shaver point, double glazed window to the rear and part tiled walls.

Parking

One allocated parking space.

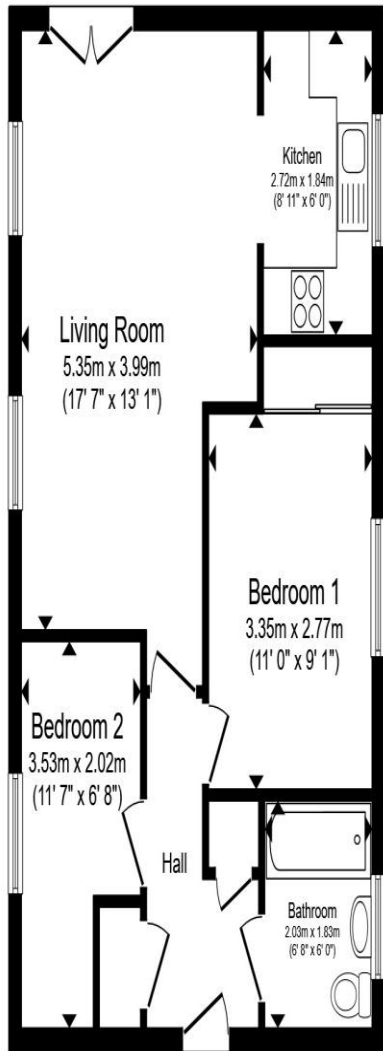

Total floor area 52.9 m² (569 sq.ft.) approx

This floor plan is for illustrative purposes only. It is not drawn to scale. Any measurements, floor areas (including any total floor area), openings and orientation are approximate. No details are guaranteed, they cannot be relied upon for any purpose and they do not form part of any agreement. No liability is taken for any error, omission or misstatement. A party must rely upon its own inspection(s). Powered by www.propertybox.io



welcome to
Alnesbourn Crescent,
Ipswich

- No onward chain
- Light filled lounge with Juliet balcony
- Good size kitchen
- Impressive master bedroom
- One allocated parking space

Tenure: Leasehold EPC Rating: C
Council Tax Band: B Service Charge: 1268.00
Ground Rent: 150.00

This is a Leasehold property with details as follows; Term of Lease 125 years from 01 Jan 2002. Should you require further information please contact the branch. Please Note additional fees could be incurred for items such as Leasehold packs.

offers in excess of
£130,000



view this property online williamhbrown.co.uk/Property/IPS121018



Property Ref:
IPS121018 - 0004

1. MONEY LAUNDERING REGULATIONS Intending purchasers will be asked to produce identification documentation at a later stage and we would ask for your co-operation in order that there is no delay in agreeing the sale. 2. These particulars do not constitute part or all of an offer or contract. 3. The measurements indicated are supplied for guidance only and as such must be considered incorrect. Potential buyers are advised to recheck measurements before committing to any expense. 4. We have not tested any apparatus, equipment, fixtures or services and it is in the buyers interest to check the working condition of any appliances. 5. Where an EPC, or a Home Report (Scotland only) is held for this property, it is available for inspection at the branch by appointment. If you require a printed version of a Home Report, you will need to pay a reasonable production charge reflecting printing and other costs. 6. We are not able to offer an opinion either written or verbal on the content of these reports and this must be obtained from your legal representative. 7. Whilst we take care in preparing these reports, a buyer should ensure that his/her legal representative confirms as soon as possible all matters relating to title including the extent and boundaries of the property and other important matters before exchange of contracts.

William H Brown is a trading name of Sequence (UK) Limited which is registered in England and Wales under company number 4268443, Registered Office is Cumbria House, 16-20 Hockliffe Street, Leighton Buzzard, Bedfordshire, LU7 1GN. VAT Registration Number is 500 2481 05.



william h brown



01473 226101



ipswich@williamhbrown.co.uk



16-18 Wolsey House, Princes Street, IPSWICH,
Suffolk, IP1 1QT



williamhbrown.co.uk