



27 NORTH BLOCK
RIVERSIDE VIEW
TEMPLE STREET
KEYNSHAM
£220,000

POSITIONED TO THE SECOND FLOOR OF THIS POPULAR DEVELOPMENT AND LOCATED WITHIN A SHORT STROLL TO KEYNSHAM HIGH STREET AND TRAIN STATION CAN BE FOUND THIS STUNNING APARTMENT. A MULTITUDE OF BENEFITS ARE ON OFFER, THE MOST VALUABLE OF WHICH IS AN ALLOCATED PARKING SPACE, FOUND IN THE SECURE CAR PARK ADJACENT TO THE DEVELOPMENT.

Presented to an immaculate standard throughout and offering generous proportions, this welcoming one bedroom property is perfect for any first time buyer or anyone looking for a downsize move. Internally the property impresses with high quality fittings from its original build in 2020 & a bright south facing position.

The development is accessed via a secure display intercom system, a communal hallway, stairs and two lifts provide access to the second floor. A lovely, welcoming hallway greets once inside the apartment and provides access to all rooms. The reception room is of an open plan nature, bathed in natural light due to the impressive floor to ceiling window and 'French' doors with 'Juliette' balcony. The kitchen comprises numerous fitted wall and base units and comes complete with a selection of built in appliances. Furthermore, the 'Quartz' work surface expands into a handy breakfast bar, making this the perfect place to sit and enjoy a meal.

The bedroom is of impressive proportions with plenty of room to accommodate a large double & additional furniture, whilst the contemporary bathroom offers premium fittings to include a P- shaped Bath with rainfall shower over.

Riverside View is an award winning development, positioned in the heat of Keynsham. A popular development with professional buyers particularly, due to its close proximity to Keynsham Train Station, making for an easy commute into both Bristol & Bath.

Sure to appeal to a range of buyers, this stylish offering is a must view.





Ground Floor
465 sq.ft. (43.2 sq.m.) approx.

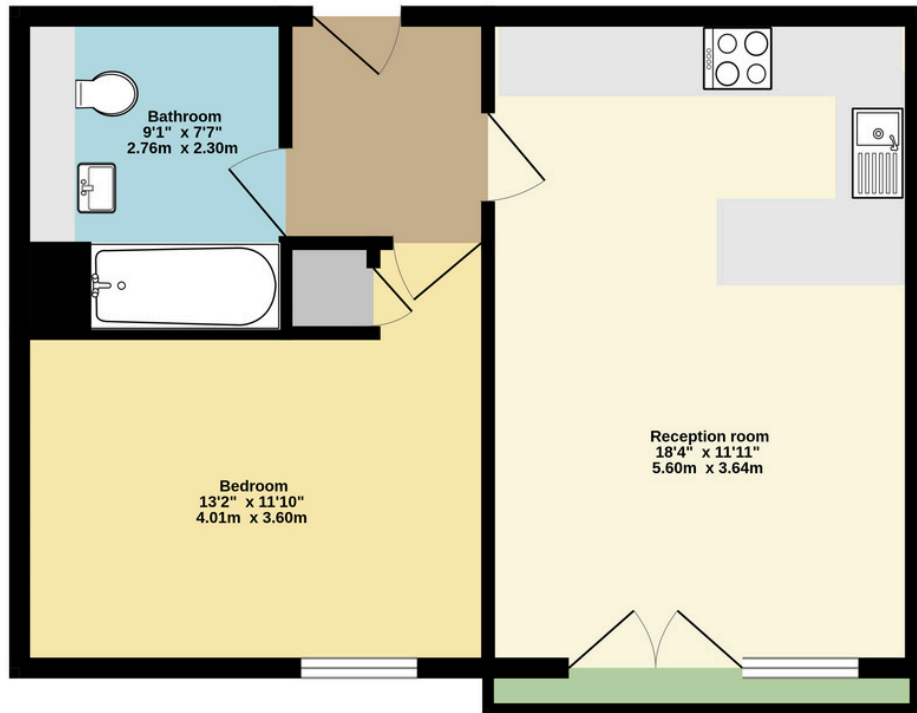

TOTAL FLOOR AREA: 465 sq.ft. (43.2 sq.m.) approx.
Whilst every attempt has been made to ensure the accuracy of the floorplan contained here, measurements of doors, windows, rooms and any other items are approximate and no responsibility is taken for any error, omission or mis-statement. This plan is for illustrative purposes only and should be used as such by any prospective purchaser. The services, systems and appliances shown have not been tested and no guarantee as to their operability or efficiency can be given.
Made with Metropix ©2023

Energy performance certificate (EPC)

Flat 27 North Block Riverside Temple Street Keynsham BRISTOL BS31 1FW	Energy rating	Valid until:	29 January 2030
	C	Certificate number:	8509-5806-1832-3477-2903

Property type	Mid-floor flat
Total floor area	43 square metres

Rules on letting this property

Properties can be let if they have an energy rating from A to E.

You can read [guidance for landlords on the regulations and exemptions](https://www.gov.uk/guidance/domestic-private-rented-property-minimum-energy-efficiency-standard-landlord-guidance)

(<https://www.gov.uk/guidance/domestic-private-rented-property-minimum-energy-efficiency-standard-landlord-guidance>).

Energy rating and score

This property's energy rating is C. It has the potential to be C.

[See how to improve this property's energy efficiency.](#)

The graph shows this property's current and potential energy rating.

Properties get a rating from A (best) to G (worst) and a score. The better the rating and score, the lower your energy bills are likely to be.

For properties in England and Wales:

the average energy rating is D
the average energy score is 60

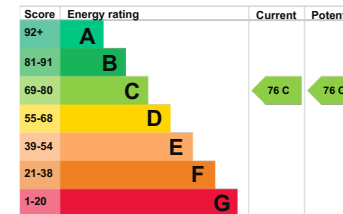

0117 986 6644

GREGORYS.CLICK

ENQUIRIES@GREGORYS.CLICK



GREGORYS
— ESTATE AGENTS —

