

Property ref: 56938

## Pages Gardens, Reading, RG8 7JE

**£800 PCM**

**HASLAM'S**  
Lettings



A first floor studio apartment located in the heart of Pangbourne Village close to the train station, shops and local amenities.  
West Berkshire Council tax band A.  
Broadband/Mobile Info: Connections available. For an indication of specific speeds and supply of Broadband and Mobile, we advise applicants go to the Ofcom website Broadband and Mobile Coverage Checker.

**Available 08/07/2026**

- Furnished / Sky ready / 32" Samsung LCD; Additional £75pcm for parking
- Good size living room / Bedroom with built-in wardrobe
- Shower room / Shared kitchen / Communal gardens
- Electric heating / Washer drier / Fridge / Microwave
- Parking at an additional cost / Bike store; EPC rating C
- £250 sundry additional to the rent to include: water, electric and Wi-Fi; Managed by HASLAM'S

\*Fees For Assured Shorthold Tenancies: when you rent a property from us you will be required to pay a sum equivalent to one weeks' rent for a holding deposit. Upon successful application, this amount will be off set against your first months' rent. You will also be required to pay a security deposit equivalent to 5 weeks' rent which will be held and protected in line with Deposit legislation. For more information about our fees please visit: [www.haslams.net](http://www.haslams.net)  
Fees for all other tenancies (Non Housing Act Tenancies / Company Lets): when you rent a property from us we will charge you a one-off fee per property. This charge is the equivalent of 15 days of the monthly rental charge (+VAT) with a minimum fee of £450 (inc.VAT) up to a maximum of £650 (inc.VAT). Other fees may apply depending on your circumstances.

**0118 960 1055**

**[lettings@haslams.net](mailto:lettings@haslams.net) [www.haslams.net](http://www.haslams.net)**

**Haslams Estate Agents Ltd, 159 Friar Street, Reading, Berkshire, RG1 1HE**



### First Floor

Approx. 28.2 sq. metres (303.6 sq. feet)

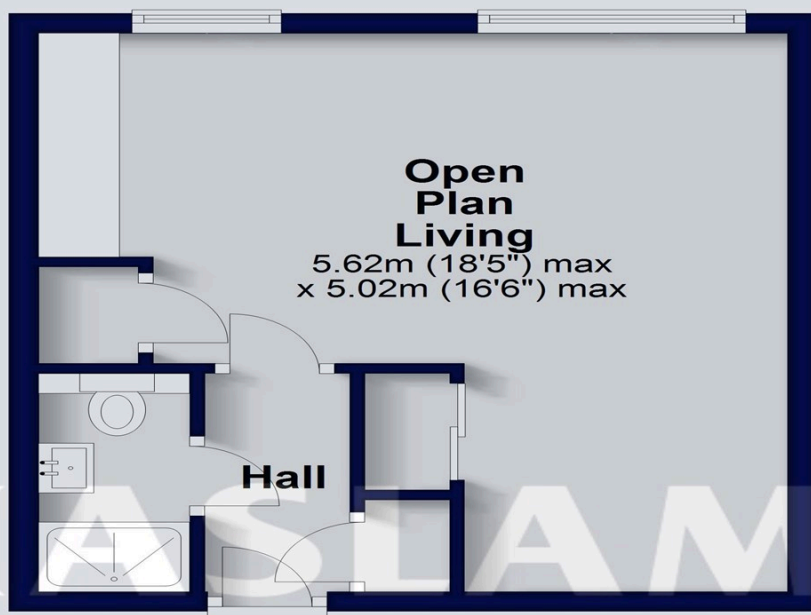

**Total area: approx. 28.2 sq. metres (303.6 sq. feet)**

This floorplan is for illustrative purposes only and is not to scale.  
The total area includes all the areas shown.  
Plan produced using PlanUp.