



Abercorn Place

St John's Wood, NW8

£2,750 per month
(£634.62 per week)

A large two bedroom apartment set on the second floor of a period converted house, ideally located just off of the sought after Abbey Road and within close proximity to St John's Wood and Maida Vale stations.

CHESTERTONS



Abercorn Place

St John's Wood, NW8

- Second Floor Flat
- 2 Bedrooms, 1 Bathroom
- Spacious, Gas Heating
- Close to Maida Vale and St John's Wood



A large two bedroom apartment set on the second floor of a period converted house, ideally located just off of the sought after Abbey Road and within close proximity to St John's Wood and Maida Vale stations.

The property comprises two double bedrooms, large reception room, fitted kitchen and full sized bathroom.

The property is offered unfurnished.

Minimum Term: 12 months
Deposit Required: £3,173.08
Local Authority: City Of Westminster
Council Tax Band: E
EPC Rating: C
Unfurnished

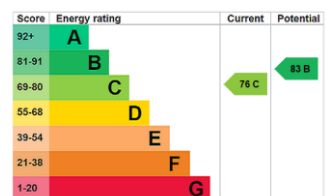

Chestertons St John's Wood Lettings

105 St. John's Wood Terrace
 London
 NW8 6PL
 stjohslettingsusers@chestertons.co.uk
 02030408622
 chestertons.co.uk

Additional tenant charges apply (fees apply to non-AST tenancies only)
 Tenancy Agreement Fee: £300
 References per Tenant/Guarantor: £60
 Inventory check (approx. £100 – £250 inc. VAT)
 chestertons.co.uk/property-to-rent/applicable-fees

Abercorn Place, NW8 9DR

Approx Gross Internal Area = 60.4 sq m / 650 sq ft

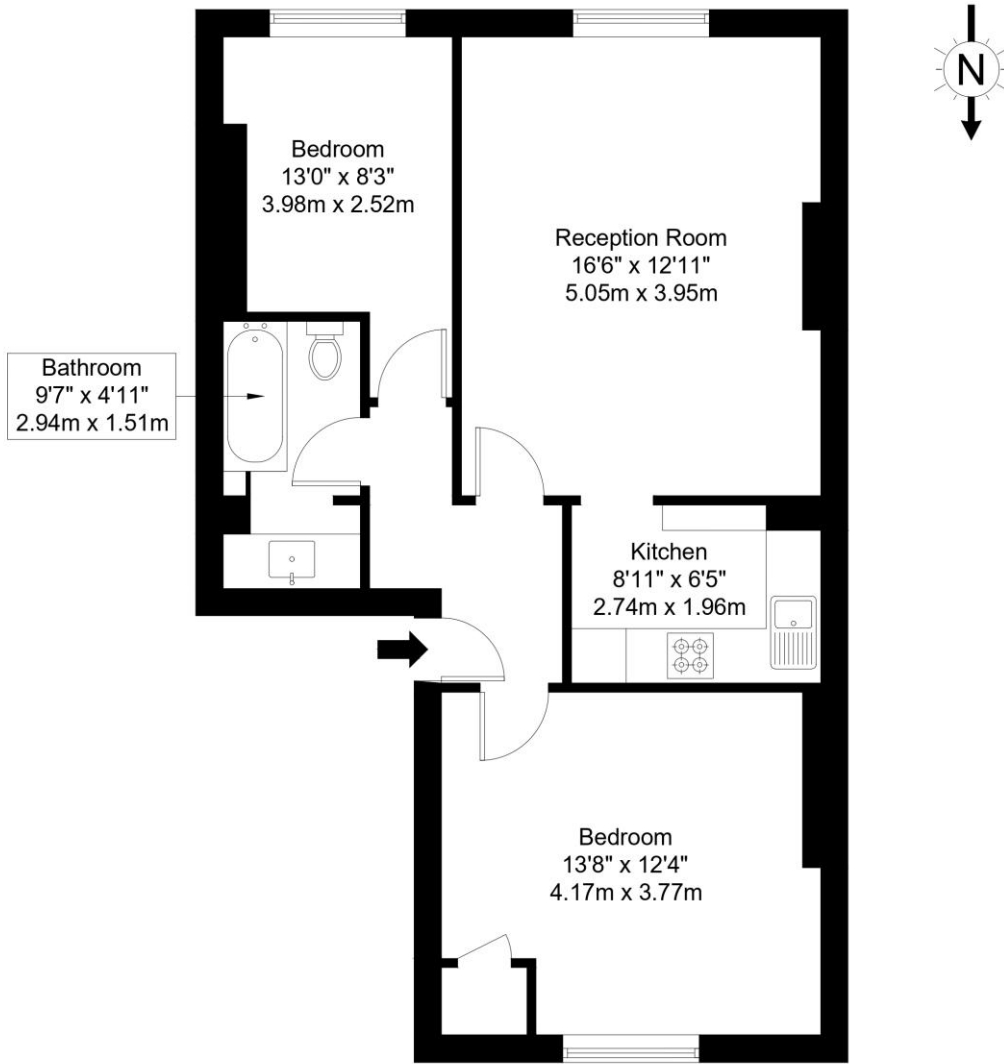

Second Floor

Ref :

Copyright **BLEU
PLAN**

The Floor plan is not to scale and measurements and areas shown are approximate and therefore should be used for illustrative purposes only. The plan has been prepared in accordance with the RICS code of Measuring Practice and whilst we have confidence in the information produced it must not be relied on. Maximum lengths and widths are represented on the floor plan. If there is any aspect of particular importance, you should carry out or commission your own inspection of the property.
Copyright @ BleuPlan



This paper is
100% recyclable