

for sale

offers in excess of **£240,000**



## Cranford Road Northampton NN2 7QX

Offered to the market with NO UPWARD CHAIN is this three bedroom terraced home ideally located within close proximity of local schools and amenities. benefiting from two reception rooms and off road parking, viewing is highly advised to fully appreciate.



# Cranford Road Northampton NN2 7QX

## Entrance Hall

Door to the front elevation and further doors leading off to the cloakroom, living room, dining room and kitchen. Stairs rise to the first floor landing.

## Cloakroom

Low level flush w.c and wash hand basin. Chrome heated towel rail and UPVC opaque double glazed window to the side elevation.

## Living Room

UPVC double glazed bay window to the front elevation and wall mounted radiator.

## Dining Room

UPVC double glazed window to the rear elevation and wall mounted radiator.

## Kitchen

Fitted kitchen with a range of wall and base level units. Sink and drainer set into work surfaces with mixer tap over and tiled to splash back areas. Plumbing for washing machine and space for under counter fridge and freezer. UPVC double glazed door to the side elevation and UPVC double glazed window to the rear elevation looking out over the rear garden.

## First Floor Landing



Stairs rise from the entrance hall. Doors lead off to three bedrooms and the family shower room. Access to the loft space.

### **Bedroom One**

UPVC double glazed window to the front elevation. Fitted wardrobe and wall mounted radiator.

### **Bedroom Two**

UPVC double glazed window to the rear elevation and wall mounted radiator.

### **Bedroom Three**

UPVC double glazed window to the rear elevation and wall mounted radiator.

### **Family Shower Room**

Three piece white suite comprising shower cubicle, low level flush w.c and wash hand basin with tiling to splash back areas. Extractor fan, wall mounted radiator and UPVC opaque double glazed window to the side elevation.

### **Outside**

### **Driveway**

Gravelled driveway providing off road parking. Gated access to the side elands to the rear garden.

### **Rear Garden**

Mainly laid to lawn with retaining hedging and timber fencing.

Gated access to the side.

### **Council Tax Band**

A



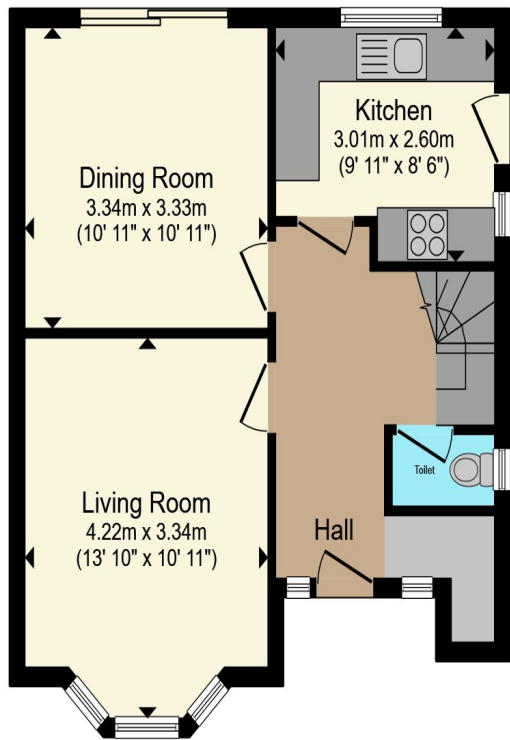

**Ground Floor**

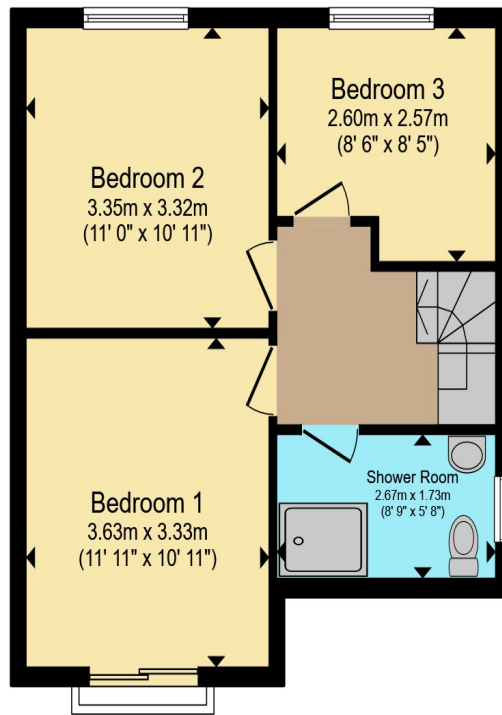

**First Floor**

Total floor area 86.7 m<sup>2</sup> (933 sq.ft.) approx

This floor plan is for illustrative purposes only. It is not drawn to scale. Any measurements, floor areas (including any total floor area), openings and orientation are approximate. No details are guaranteed, they cannot be relied upon for any purpose and they do not form part of any agreement. No liability is taken for any error, omission or misstatement. A party must rely upon its own inspection(s). Powered by www.propertybox.io



To view this property please contact Connells on

**T 01604 716 655**  
**E kingsthorpe@connells.co.uk**

87 Harborough Road KINGSTHORPE  
 NORTHAMPTON NN2 7SL

Property Ref: KTP408246 - 0002

Tenure:Freehold EPC Rating: D

Council Tax Band: A

**view this property online**  
**connells.co.uk/Property/KTP408246**



1. MONEY LAUNDERING REGULATIONS Intending purchasers will be asked to produce identification documentation at a later stage and we would ask for your co-operation in order that there will be no delay in agreeing the sale. 2. These particulars do not constitute part or all of an offer or contract. 3. The measurements indicated are supplied for guidance only and as such must be considered incorrect. Potential buyers are advised to recheck measurements before committing to any expense. 4. We have not tested any apparatus, equipment, fixtures, fittings or services and it is in the buyers interest to check the working condition of any appliances.

Connells Residential is registered in England and Wales under company number 1489613, Registered Office is Cumbria House, 16-20 Hockliffe Street, Leighton Buzzard, Bedfordshire, LU7 1GN. VAT Registration Number is 500 2481 05.

see all our properties at [www.connells.co.uk](http://www.connells.co.uk) | [www.rightmove.co.uk](http://www.rightmove.co.uk) | [www.zoopla.co.uk](http://www.zoopla.co.uk)