

# Parkheath

*Sold on Service*

**Fairfax Road NW6**

**£3,300 PCM (£761 per week) - Camden Band E**



Spacious three double bedroom apartment

Third floor above commercial premises

Separate fitted kitchen with breakfast bar

Bathroom/WC

Excellent transport links nearby

Ideal for three sharers

Reception/dining room with laminate wood flooring

Well-proportioned accommodation

Moments from Swiss Cottage & Finchley Road amenities

EPC: Rating D, Council Tax: Camden band E

West Hampstead Office 020 7794 7111

Fairfax Court, NW6  
Approx. Gross Internal Area  
907 Sq Ft - 84.26 Sq M

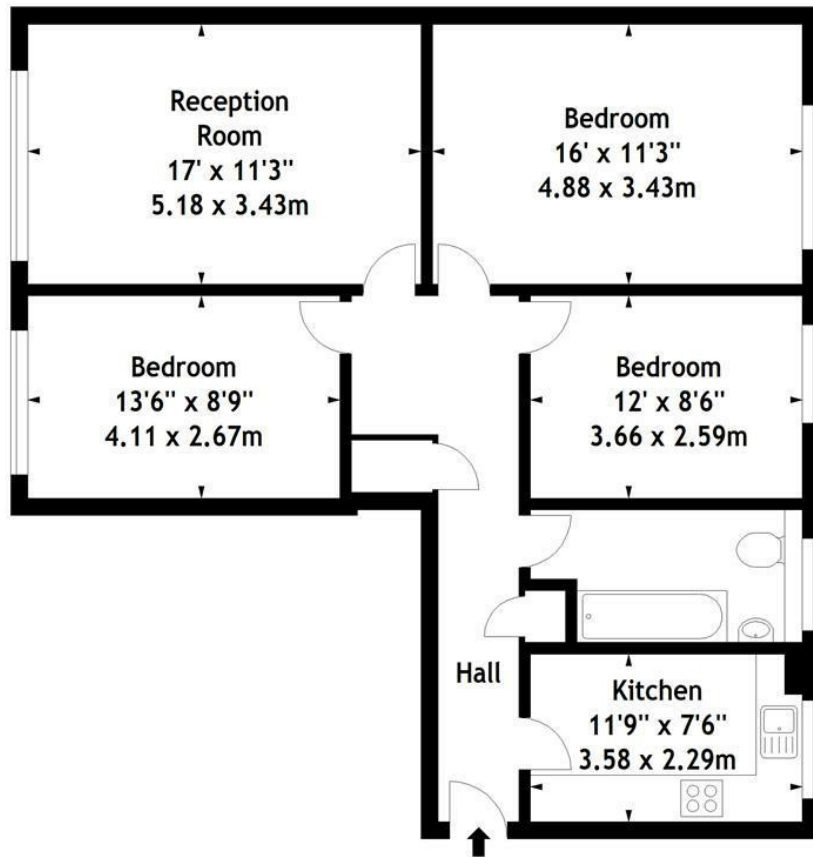

Third Floor

Measured in accordance with RICS guidelines. Every attempt is made to ensure accuracy, however all measurements are approximate. This floor plan is for illustrative purposes only and is not to scale.  
© Datography Ltd 2015  
Photographs \* Floorplans \* Virtual Tours  
Tel: 0845 643 4401 www.datography.com

The particulars do not constitute part of an offer or contract. The particulars, including text, photographs and plans, are for the guidance only of prospective purchasers/tenants and must not be relied upon as statements of fact. The descriptions provided therein represent the opinion of the author and whilst given in good faith should not be construed as statements of fact. Nothing in these particulars shall be deemed a statement that the property is in good condition or otherwise or that any services or facilities are in good working order. All measurements are approximate