

# Effra Court | London, SW2



**£1,650 PCM**

- One bedroom apartment • Popular private block • Moments from Brixton town centre • Offered unfurnished • Leasehold covenants may apply • On street residents permit parking available on application

# Effra Court | London, SW2



A one bedroom apartment in this sought after private 1930's block moments from Brixton town centre. This fourth floor property comprises a bright reception room with wooden stripped floors and kitchen off it, double bedroom and modern bathroom.

The development benefits from lift, entry phone system and small rear communal garden. Transport links are excellent and include Brixton tube, Brixton mainline and numerous buses. Local bars and shops are within few minutes walk. Perfect for a single professional or a couple. Available from early May

Monthly rent: £1650.  
 Deposit: £1903.  
 EPC=C.  
 Council tax band B (Lambeth)

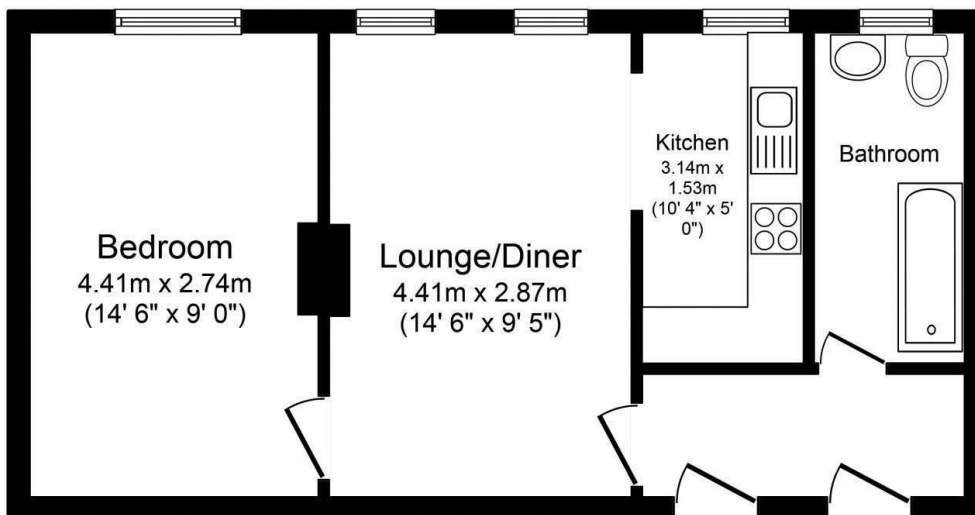

**Floor Plan**

Floor area 39.0 sq. m. (420 sq. ft.) approx

Total floor area 39.0 sq. m. (420 sq. ft.) approx

This plan is for illustration purposes only and may not be representative of the property. Plan created for Eden Harper Estate Agents.

FOR GUIDANCE ONLY

Produced by www.keyagent.co.uk

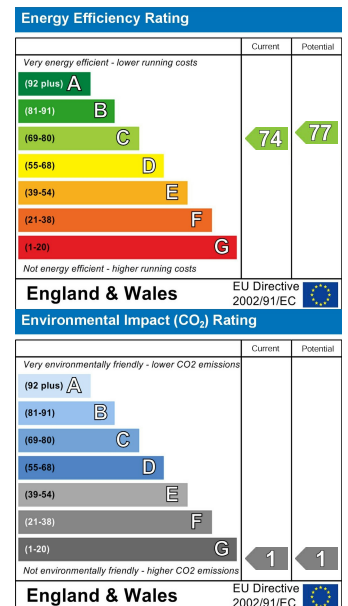

These particulars are designed to provide a guideline only and cannot be relied upon as a statement of fact. The description represents the opinion of the author and is not intended to provide false or misleading information. Any prospective purchaser should make further checks on its accuracy. All measurements are approximate and floorplans are for representation only.



**Eden Harper**  
 3 Arlington Parade, Brixton Hill, Brixton, SW2 1RH  
**0207 274 3111**  
 brixsales@edenharper.com  
 www.edenharper.com