



Sussex Avenue, TW7

£649,950

A Semi Detached family home with driveway parking, side access and extended to the rear. Further benefits include a brick built out building, large garden, two bathrooms and no onward chain. There is also further scope to extend STPP.

Sussex Avenue is located between Woodlands Road and Riverside Walk, Isleworth Mainline Station and Hounslow East Tube Station with their links into London close by.

Features

- No Onward Chain
- Great Condition
- Brick Outbuilding
- Driveway Parking
- Rear Extended
- Semi Detached

Sussex Avenue, Isleworth, TW7

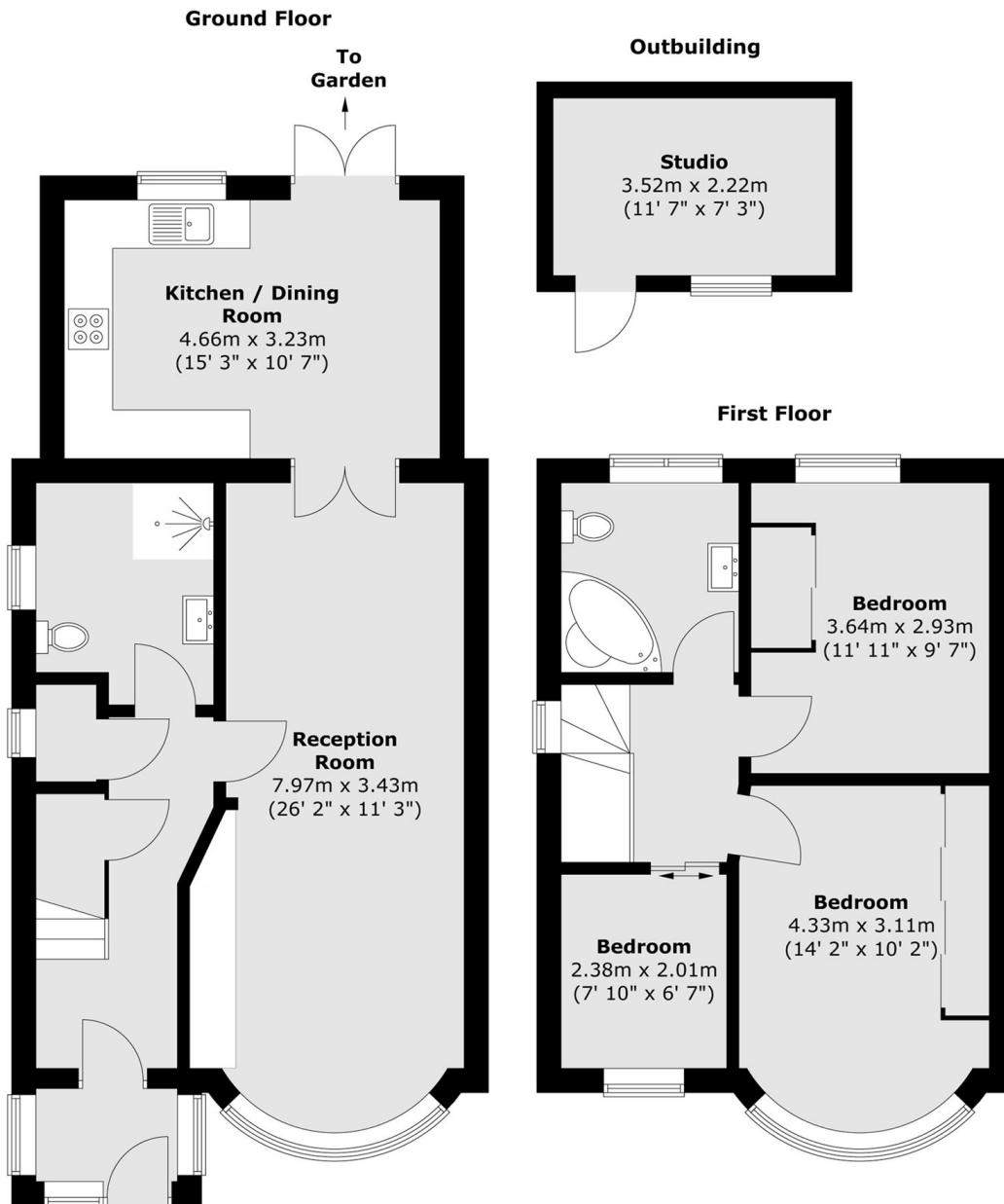

Total area (approx.) : 99.2 sq. m (1068 sq. ft)
Total studio area (approx.) : 7.7 sq. m (83 sq. ft)