



Pacific Way, Derby DE24 1AA



welcome to
Pacific Way, Derby

Located on the second floor of a modern development on Pacific Way, Derby, this well-presented two-bedroom flat offers comfortable, ready-to-move-into accommodation ideal for first-time buyers, professionals or investors.

The property is accessed via a welcoming entrance hallway which provides access to all rooms. The spacious lounge/diner benefits from an abundance of natural light and features double doors opening onto a private balcony, creating an ideal space for relaxing or entertaining. Positioned off the corner of the lounge/diner is a fitted kitchen, offering ample wall and base units along with generous worktop space, providing both practicality and storage.

To the left of the hallway is the main double bedroom, which is well-proportioned and benefits from its own en suite shower room. There is a further double bedroom accessible from the hallway, finally completing the internal accommodation is a modern three-piece bathroom suite.

The property is presented in good decorative order throughout and is ready for immediate occupation. Externally, it further benefits from allocated parking, adding to the overall convenience of this attractive apartment.



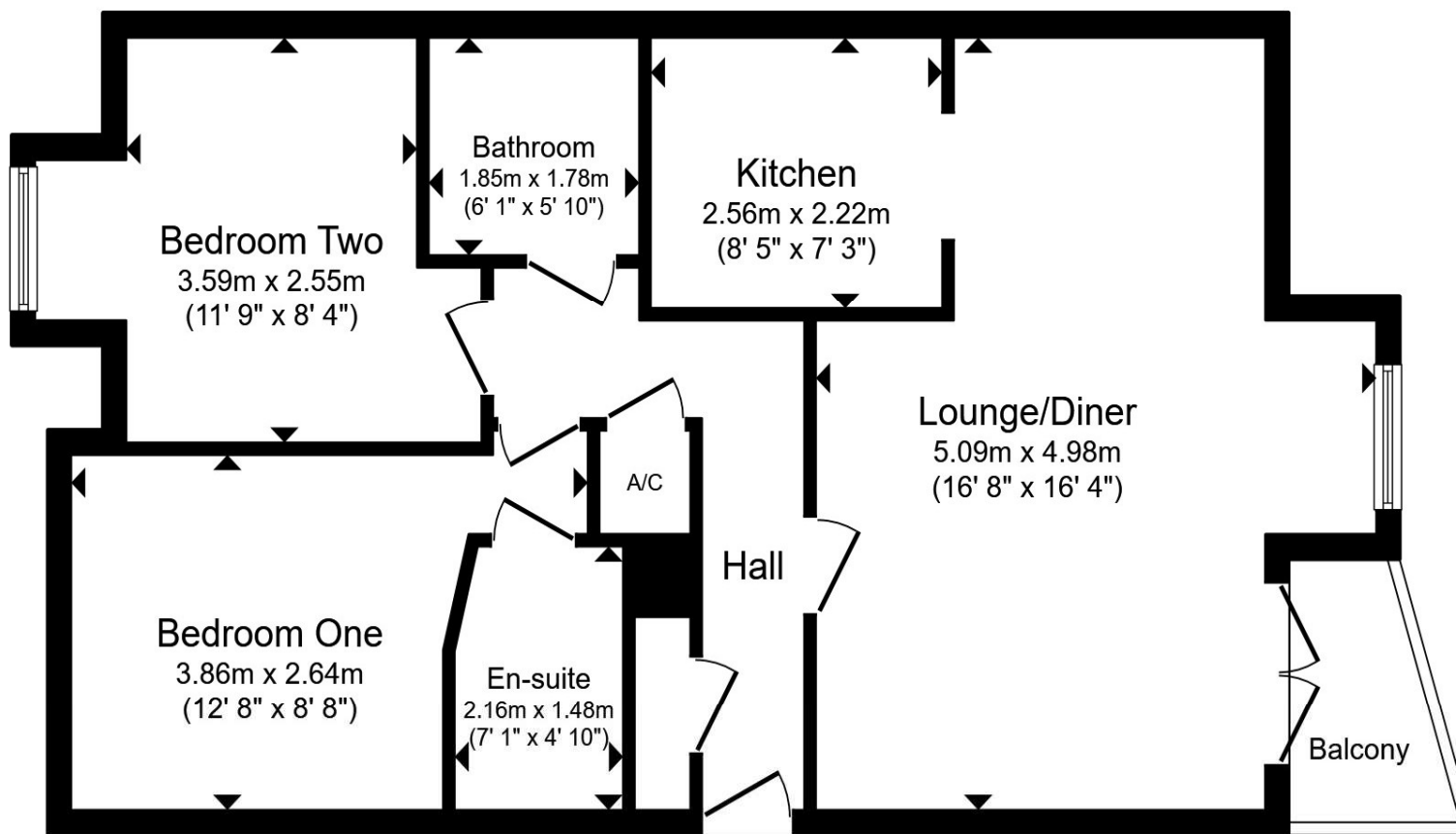

The Area

Lounge / Diner

16' 8" MAX x 16' 4" INTO RECESS (5.08m
MAX x 4.98m INTO RECESS)

Kitchen

8' 5" x 7' 3" (2.57m x 2.21m)

Bedroom One

12' 8" x 8' 8" INTO RECESS (3.86m x 2.64m
INTO RECESS)

Bedroom Two

11' 9" x 8' 4" + RECESS (3.58m x 2.54m +
RECESS)

Bathroom

6' 1" x 5' 1" (1.85m x 1.55m)

Total floor area 67.4 m² (726 sq.ft.) approx

This floor plan is for illustrative purposes only. It is not drawn to scale. Any measurements, floor areas (including any total floor area), openings and orientation are approximate. No details are guaranteed, they cannot be relied upon for any purpose and they do not form part of any agreement. No liability is taken for any error, omission or misstatement. A party must rely upon its own inspection(s). Powered by www.propertybox.io

welcome to

Pacific Way, Derby

- Second-floor two-bedroom apartment
- Lounge/diner with double doors to balcony
- Main bedroom with en suite
- Well-presented and ready to move into
- Allocated parking space

Tenure: Leasehold EPC Rating: B

Council Tax Band: B Service Charge: 1962.36

Ground Rent: 165.00

This is a Leasehold property with details as follows; Term of Lease 155 years from 01 Jun 2006. Should you require further information please contact the branch. Please Note additional fees could be incurred for items such as Leasehold packs.

£130,000



view this property online [bagshawsresidential.co.uk/Property/DBY121945](https://www.bagshawsresidential.co.uk/Property/DBY121945)



Property Ref:
DBY121945 - 0005

1. MONEY LAUNDERING REGULATIONS Intending purchasers will be asked to produce identification documentation at a later stage and we would ask for your co-operation in order that there is no delay in agreeing the sale. 2. These particulars do not constitute part or all of an offer or contract. 3. The measurements indicated are supplied for guidance only and as such must be considered incorrect. Potential buyers are advised to recheck measurements before committing to any expense. 4. We have not tested any apparatus, equipment, fixtures or services and it is in the buyers interest to check the working condition of any appliances. 5. Where an EPC, or a Home Report (Scotland only) is held for this property, it is available for inspection at the branch by appointment. If you require a printed version of a Home Report, you will need to pay a reasonable production charge reflecting printing and other costs. 6. We are not able to offer an opinion either written or verbal on the content of these reports and this must be obtained from your legal representative. 7. Whilst we take care in preparing these reports, a buyer should ensure that his/her legal representative confirms as soon as possible all matters relating to title including the extent and boundaries of the property and other important matters before exchange of contracts.

Bagshaws Residential is a trading name of Sequence (UK) Limited which is registered in England and Wales under company number 4268443, Registered Office is Cumbria House, 16-20 Hockliffe Street, Leighton Buzzard, Bedfordshire, LU7 1GN. VAT Registration Number is 500 2481 05.

Please note the marker reflects the postcode not the actual property



bagshaws residential



01332 361308



Derby@bagshawsresidential.co.uk



32-34 Cornmarket, DERBY, Derbyshire, DE1 2DG



[bagshawsresidential.co.uk](https://www.bagshawsresidential.co.uk)