



## Queensborough Terrace, W2

£2,383 Per week

A stylish and contemporary one bedroom top floor flat in a Victorian conversion. Layout includes wood floors throughout, reception room with space for dining and semi open plan white gloss kitchen with dishwasher.

The flat is ideally located close to the shops and restaurants of Queensway and Whiteley's shopping mall, the closest underground station is Bayswater.

### Features

- One Bedroom
- Wood Floors
- Contemporary Finish
- Semi Open Plan kitchen
- Period Conversion
- Bayswater Underground

# Queensborough Terrace, London, W2

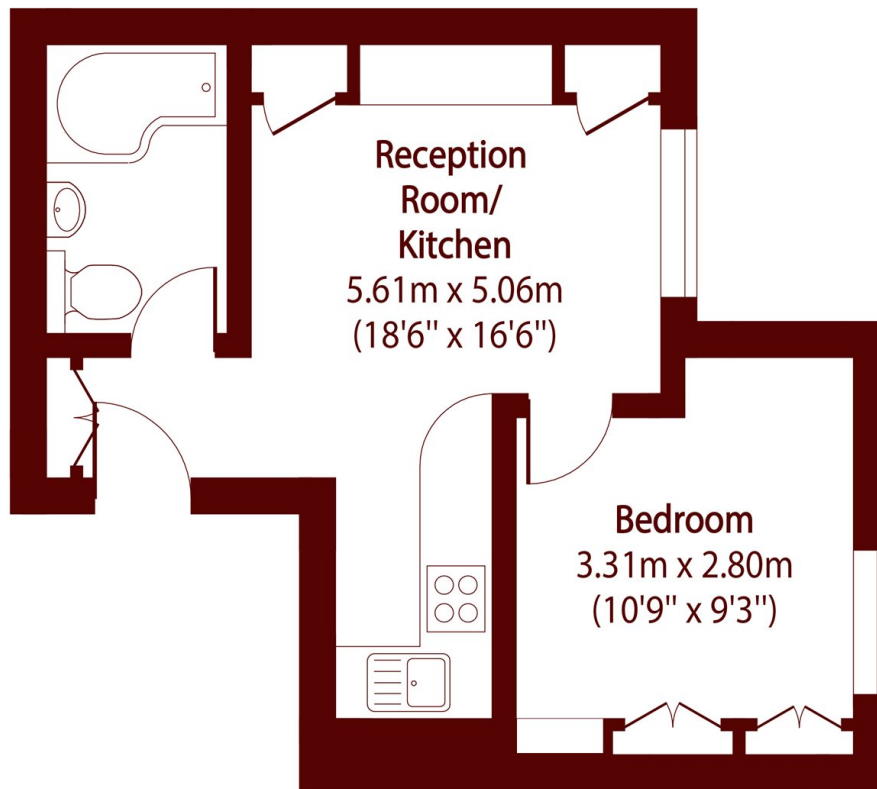

Total area (approx): 29.16 sq m (314 sq. ft)