



28

26



W10 3RF

# 28 New Road, Tintwistle, Glossop, Derbyshire, SK13 1JN

Enjoying a sunny South Westerly rear aspect overlooking the local allotments, a stone built mid terraced house in popular Tintwistle, within a mile of Hadfield shops, railway station and the Longdendale Trail which traverses the local reservoirs and the beautiful High Peak countryside. The extended living space briefly comprises of an entrance hall, front lounge with fireplace, a separate dining room, kitchen extension with oven and hob, two first floor bedrooms and a bathroom with shower. Gas central heating, pvc double glazing, walled frontage and enclosed rear garden. Energy Rating D

## £205,000

### Viewing arrangements

Viewing strictly by appointment through the agent

44 High Street West, Glossop, Derbyshire, SK13 8BH 01457 858888

### GROUND FLOOR

#### Entrance Vestibule

Pvc double glazed front door, door leading through to:

#### Lounge

13'7 (max) x 13'6 (less vest)

Pvc double glazed front window, central heating radiator, dressed stone fireplace with gas fire, electric meter cupboard and door through to:

#### Dining Room

13'7 x 11'3 (less stairs)

Pvc double glazed external rear door, central heating radiator, Vaillant gas fired combination boiler, stairs leading to the first floor and door to:

### Kitchen

10'11 x 8'7

A range of fitted kitchen units including base cupboards and drawers, plumbing for a slimline dishwasher and automatic washing machine, built-in electric double oven, work tops over with an inset one and a half bowl single drainer stainless steel sink unit and mixer tap, gas hob, filter hood and wall cupboards, two pvc double glazed rear windows and central heating radiator.

### FIRST FLOOR

#### Landing

## Bedroom One

13'10 (max) x 11'0

Pvc double glazed front window and central heating radiator.

## Bedroom Two

8'10 x 8'0

Pvc double glazed rear window and central heating radiator.

## Bathroom

A white suite including a panelled bath with shower over, pedestal wash hand basin and close coupled wc, central heating radiator, linen cupboard and pvc double glazed rear window.

## OUTSIDE

### Frontage & Rear Garden

The property has a walled frontage and an enclosed rear garden.

Our ref: Cms/cms/0401/26

### Note - Anti Money Laundering

To be able to sell or purchase a property in the United Kingdom all agents have a legal requirement to conduct Identity checks on all customers involved in the transaction to fulfil their obligations under Anti Money Laundering regulations. We outsource this check to a third party and a charge will apply. Ask the branch for further details.

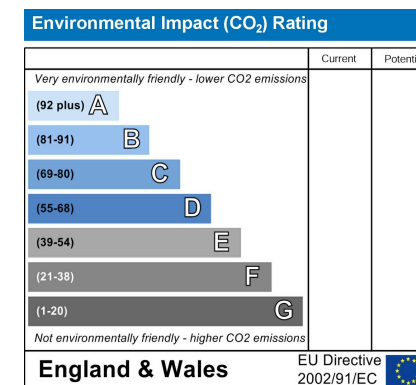
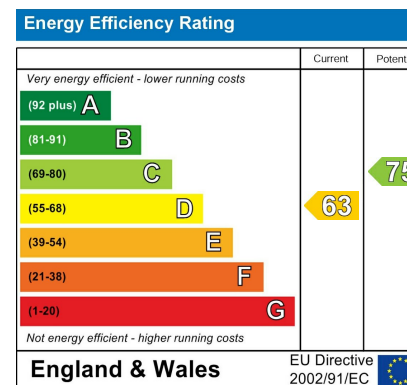



GROUND FLOOR

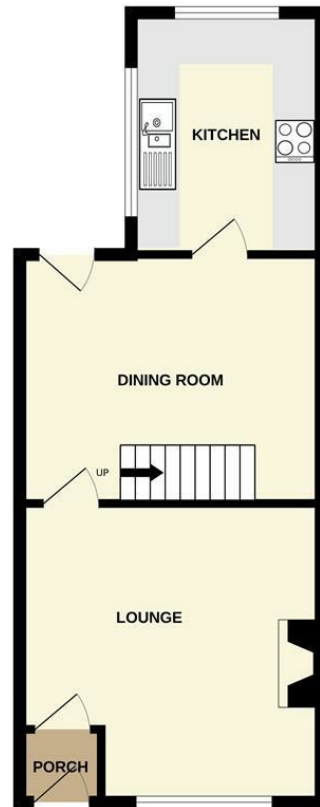

1ST FLOOR

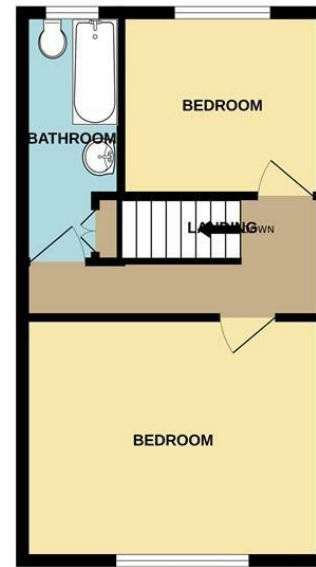

Whilst every attempt has been made to ensure the accuracy of the floorplan contained here, measurements of doors, windows, rooms and any other items are approximate and no responsibility is taken for any error, omission or mis-statement. This plan is for illustrative purposes only and should be used as such by any prospective purchaser. The services, systems and appliances shown have not been tested and no guarantee as to their operability or efficiency can be given.  
Made with Metropix ©2026



These particulars are believed to be accurate but they are not guaranteed and do not form a contract. Neither Jordan Fishwick nor the vendor or lessor accept any responsibility in respect of these particulars, which are not intended to be statements or representations of fact and any intending purchaser or lessee must satisfy himself by inspection or otherwise as to the correctness of each of the statements contained in these particulars. Any floorplans on this brochure are for illustrative purposes only and are not necessarily to scale.

Offices at: Chorlton, Didsbury, Disley, Hale, Glossop, Macclesfield, Manchester Deansgate, Manchester Whitworth Street, New Mills, Sale, Wilmslow and Withington

44 High Street West, Glossop, Derbyshire, SK13 8BH

01457 858888

[glossop@jordanfishwick.co.uk](mailto:glossop@jordanfishwick.co.uk)

[www.jordanfishwick.co.uk](http://www.jordanfishwick.co.uk)

