



WHITELANDS HOUSE

Chelsea SW3



LOCATED IN THE HEART OF CHELSEA

A well-proportioned first-floor apartment with a rare large private terrace extending 50 meters, offering open views across the King's Road.



Local Authority: Royal Borough of Kensington and Chelsea

Council Tax band: E

Tenure: Share of Freehold, approximately 999 years remaining

Ground rent: £56 per annum

Service charge: £8,197.34 per annum, next review date 2027

Guide price: £1,375,000

The apartment is arranged around a generous reception room with space for both living and dining, opening directly onto the large terrace via double doors. Extending across the full width of the apartment, the terrace provides an excellent area for outdoor dining and entertaining, with attractive open views towards the King's Road and a strong sense of light and space throughout. Whitelands House benefits from lift access, a 24-hour porter and a share of freehold. The flat itself benefits from air conditioning.

Whitelands House is ideally positioned in the heart of Chelsea SW3, one of London's most prestigious and sought-after neighbourhoods.

We have been informed that the primary external wall materials of the building/block have been assessed for fire safety. The assessor concluded that the fire risk of the external wall materials is sufficiently low that no remedial works are required. If you have any further questions, you should seek independent professional advice

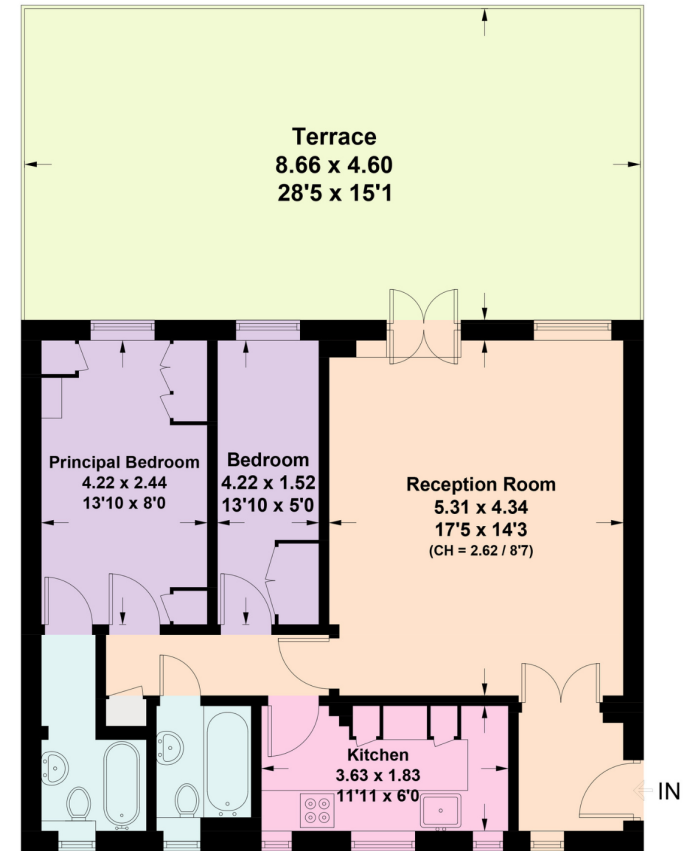

First Floor



Approximate Gross Internal Area = 63.4 sq m / 682 sq ft

This plan is for layout guidance only. Not drawn to scale unless stated. Windows and door openings are approximate. Whilst every care is taken in the preparation of this plan, please check all dimensions, shapes and compass bearings before making any decisions reliant upon them. (ID767266)

We would be delighted
to tell you more.

Daniel Sugarman
020 7861 1224
daniel.sugarman@knightfrank.com

Knight Frank Knightsbridge
52-54 Sloane Avenue
SW3 3DD

[knightfrank.co.uk](https://www.knightfrank.co.uk)

Your partners in property

1. Particulars: These particulars are not an offer or contract, nor part of one. You should not rely on statements given by Knight Frank in the particulars, by word of mouth or in writing ("information") as being factually accurate about the property, its condition or its value. Neither Knight Frank nor any joint agent has any authority to make any representations about the property, and accordingly any information given is entirely without responsibility on the part of Knight Frank. 2. Material Information: Please note that the material information is provided to Knight Frank by third parties and is provided here as a guide only. While Knight Frank has taken steps to verify this information, we advise you to confirm the details of any such material information prior to any offer being submitted. If we are informed of changes to this information by the seller or another third party, we will use reasonable endeavours to update this as soon as practical. 3. Photos, Videos etc: The photographs, property videos and virtual viewings etc. show only certain parts of the property as they appeared at the time they were taken. Areas, measurements and distances given are approximate only. 4. Regulations etc: Any reference to alterations to, or use of, any part of the property does not mean that any necessary planning, building regulations or other consent has been obtained. A buyer must find out by inspection or in other ways that these matters have been properly dealt with and that all information is correct. 5. Fixtures and fittings: A list of the fitted carpets, curtains, light fittings and other items fixed to the property which are included in the sale (or may be available by separate negotiation) will be provided by the Seller's Solicitors. 6. VAT: The VAT position relating to the property may change without notice. 7. To find out how we process Personal Data, please refer to our Group Privacy Statement and other notices at <https://www.knightfrank.com/legals/privacy-statement>.

Particulars dated <ParticularsDates>. Photographs and videos dated <PhotoDate>. All information is correct at the time of going to print. Knight Frank is the trading name of Knight Frank LLP. Knight Frank LLP is a limited liability partnership registered in England and Wales with registered number OC305934. Our registered office is at 55 Baker Street, London W1U 8AN. We use the term 'partner' to refer to a member of Knight Frank LLP, or an employee or consultant. A list of members names of Knight Frank LLP may be inspected at our registered office. If you do not want us to contact you further about our services then please contact us by either calling 020 3544 0692, email to marketing.help@knightfrank.com or post to our UK Residential Marketing Manager at our registered office (above) providing your name and address.